

THIS DOCUMENT IS RECORDED AS AN ACCOMMODATION AND WITHOUT LIABILITY FOR THE CONSIDERATION THEREFORE OR AS TO THE VALIDITY OR SUFFICIENCY OF SAID INSTRUMENT OR FOR THE EFFECT OF SUCH RECORDING ON THE TITLE OF THE PROPERTY INVOLVED.

APN: 17-081-290, 17-081-300, 17-081-310

Notice of Recision of Restrictive Covenant

By an agreement recorded September 28, 1990, in Book 990, at Page 4595, Document No. 235705, and an agreement recorded November 14, 1973, in Book 1173, Page 367, as Document No. 69988, both Official Records of Douglas County, Nevada, certain restrictions were imposed upon the property described in Exhibit "A" attached hereto.

The undersigned now owns the parcels which are both benefitted and burdened by the restrictions set forth therein, and hereby declares that the above stated restrictions are no longer of any force or effect.

Dated this 2nd Day of November, 1999.

C. Rex Cleary
C. Rex Cleary

Alice Cleary
Alice Cleary

Russell C. Cleary
Russell C. Cleary

Kelly C. Cleary
Kelly C. Cleary

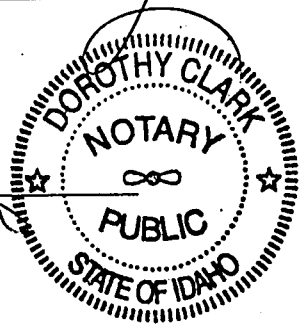

State of Id
County of Ada
11-11-99 personally appeared before me
a notary public Russell & Kelly C
Cleary Dorothy Clark
11-26-04

STATE OF NEVADA
COUNTY OF CARSON CITY

On Nov. 2, 1999, personally appeared before me, a notary public, C. Rex Cleary
And Alice Cleary

_____ Who
acknowledged that they executed the above instrument.

April L. Buschett
Notary Public

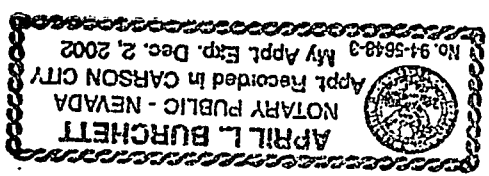

When recorded mail to:
Cleary
P.O. Box 56
Genoa, NV 89411

BK 1199PG3520 0481147

Exhibit "A"

Parcel 1:

A parcel of land located within a portion of the Southeast one-quarter of the Northeast one quarter of Section 9, Township 13 North, Range 19 East, MDM..., Douglas County, Nevada, being more particularly described as follows:

BEGINNING at a 5/8" rebar and plastic stamped PLS 6200 at the Northeasterly corner of Parcel 1 as recorded in Book 1090 at Page 1387, Document No. 236275 of the Douglas County Recorder's Office, said point bears S. 87 40'30"W., 547.58 feet from the North one-sixteenth corner of Sections 9 and 10, Township 13 North, Range 19 East, MDM., being a found PK nail as per the preliminary BLM township plat and field notes of the re-survey by Dukleth and Parrish in 1985-6;

thence S. 18 50'58" W., along the Easterly line of said Parcel 1, 107.42 feet;

thence N. 80 12'46" W., 83.28 feet to a point of the Southerly line of said Parcel 1, being a 5/8" rebar and plastic cap stamped PLS 6200;

thence N. 54 07'56"W., continuing along said Southerly line, 22.70 feet to a 5/8" rebar and plastic cap stamped PLS 6200;

thence N. 68 33'47" w., continuing along said Southerly line, 22.70 feet to a 5/8" rebar and plastic cap stamped PLS 6200;

thence S. 82 27'42" W. continuing along said Southerly line, 54.01 feet to a 5/8" rebar and plastic camp stamped PLS 6200;

thence S. 16 00'44" W., 96.99 feet to a point on said Southerly line;

thence N. 66 33'15" W., along Southerly line, 174.20 feet;

thence N. 00 23' 40"., feet to a point on the North line of the South one-half of the Northeast one-quarter of said Section 9 and the original Town of Genoa boundary line;

thence N. 89 36'20:" E., along said North line, 87.81 feet to a point on the Westerly line of said Parcel 1;

thence N. 19 13'37" E., along said Westerly line, 6.50 feet to a 1/2" rebar thence N. 64 48'30" E., along the Northerly line of said parcel 1, 86.03 to a 1/2" rebar;

thence S. 89 02'10" E., continuing along said Northerly line, 151.07 feet to 3/4" iron pipe;

thence S. 04 09'37" W., continuing along said Northerly line, 38.74 feet to a point on the above mentioned North line of the South one-half of the Northeast one-quarter of said Section 9;

0481147
BK 1199PG3521

thence N. 89 36'20" E., along said North line, 27.04 feet;

thence S. 69 24'47" E., along the Northerly line of said Parcel 1, 60.93 feet to the POINT OF BEGINNING.

Basis of Bearing

The North line of the South one-half of the Northeast one-quarter of Section 9 as taken from the preliminary BLM Township plat and field notes of a portion of T. 13 N., R. 19 E., MDM., re-surveyed by D.L. Dukleth and J.S. Parrish in 1985-6, (N. 89 36'20"E.).

Said Parcel being further shown as new parcel 1 on record of survey recorded September 10, 1999, in Book 999, Page 1643, as Document No. 476243, Official Records.

Parcel 2:

A parcel of land located within a portion of the Southeast one-quarter of the Northeast one-quarter of Section 9, Township 13 North, Range 19 East, MDM., Douglas County, Nevada, being more particularly described as follows:

BEGINNING at the Southeasterly corner of Parcel 3 as recorded in Book 290 at Page 3128, Document No. 220488 of the Douglas County Recorder's Office, said corner bears S. 59 28'19" w., 927.48 feet from the North one-sixteenth corner of Sections 9 and 10, Township 13 North, Range 19 East, MDM.. being a PK nail as per The preliminary BLM Township plat and field notes of the re-survey by Dukleth and Parrish in 1985-6;

thence N. 66 37'37" W., along the Southerly line of said Parcel 3, 69.60 feet;

thence N. 23 22'23" E., 30.00 feet;

thence N. 23 09'08" W., 86.26 feet;

thence N. 10 36' 53" E., 77.38 feet;

thence N. 15 38'19" W., 81.77 feet;

thence N. 16 00'44" E., 118.22 feet to a point on the Southerly line of Parcel 1 as recorded in Book 1090 Page 1387, Document No. 236275 of the Douglas County Recorder's Office being a 5/8" rebar and plastic cap stamped PLS 6200;

thence N. 82 27'42" E., along said Southerly line, 54.01 feet to a 5/8" rebar and plastic cap stamped PLS 6200;

thence S. 68 33'47" E., continuing along said Southerly line, 22.70 feet to a 5/8" rebar and plastic cap stamped PLS 6200;

0481147

BK 1199PG3522

thence S. 54 07'56" E., continuing along said Southerly line, 16.81 to a 5/8 rebar and plastic stamped
PLS 6200;

thence S. 12 52'40" E., continuing along said Southerly line, 35.37 feet to a 5/8" rebar and plastic cap stamped PLS 6200;

thence S. 80 12'46" E., 83.28 to a point on the Easterly line of said Parcel 1:

thence S. 18 50'58" W., along said Easterly line, 362.64 to the POINT OF BEGINNING.

Basis of Bearing

The North line of the South one-half of the Northeast one-quarter of Section 9 as taken from the preliminary BLM Township plat and field notes of a portion of T. 13 N., R. 19 E., MDM., re-surveyed by D.L. Dukleth and J.S. Parrish in 1985-6, (N. 89 36'20" E.).

Said Parcel being further shown as new parcel 2 on record of survey recorded September 10, 1999, in Book 999, Page 1643, as Document No. 476243, Official Records.

Parcel 3:

A parcel of land located within a portion of the Southeast one-quarter of the Northeast one-quarter of Section 9, Township 13 North, Range 19 East, MDM., Douglas County, Nevada, being more particularly described as follows:

BEGINNING at a 1/2" iron pipe at the Southwesterly corner of Adjusted Parcel 3 as recorded in Book 290 at Page 3128, Document No. 220488 of the Douglas County Recorder's Office, said iron pipe bears S. 71 57'48" W., 1132.99 feet from the North one sixteenth corner of Sections 9 and 10, Township 13 North, Range 19 East, MDM. being a PK nail as per the re-survey by Dukleth and Parrish in 1985-6;

thence N. 18 55'10"E., along the Westerly line of said Adjusted Parcel 3, 98.37 feet;

thence N. 00 23'40" W., 165.61 feet;

thence S. 66 33'15" E., 174.20 feet;

thence S. 16 00'44" W., 21.23 feet;

thence S. 15 38'19" E., 81.77 feet;

thence S. 10 36'53" W., 77.38 feet;

thence S. 23 09'08" E., 86.26 feet;

thence S. 23 22'23" W., 30.00 feet to a point on the Southerly line of said Adjusted Parcel 3;

0481147

BK1199PG3523

thence N. 66 37'37" W., along said Southerly line, 233.69 feet to the POINT OF BEGINNING.

Basis of Bearing

The North line of the South one-half of the Northeast one-quarter of Section 9 as taken from the preliminary BLM Township plat and filed notes of portion of T. 13 N., R. 19 E., M.D.M., re-surveyed by D. L. Dukleth and J.S. Parrish in 1985-6, (N. 89 ° 36'20" E.)

Said Parcel being further shown as new parcel 3 on record of survey recorded September 10, 1999, in Book 999, Page 1643, as Document No. 476243, Official Records.

Assessor's Parcel Numbers 17-081-290
 17-081-300
 17-081-310

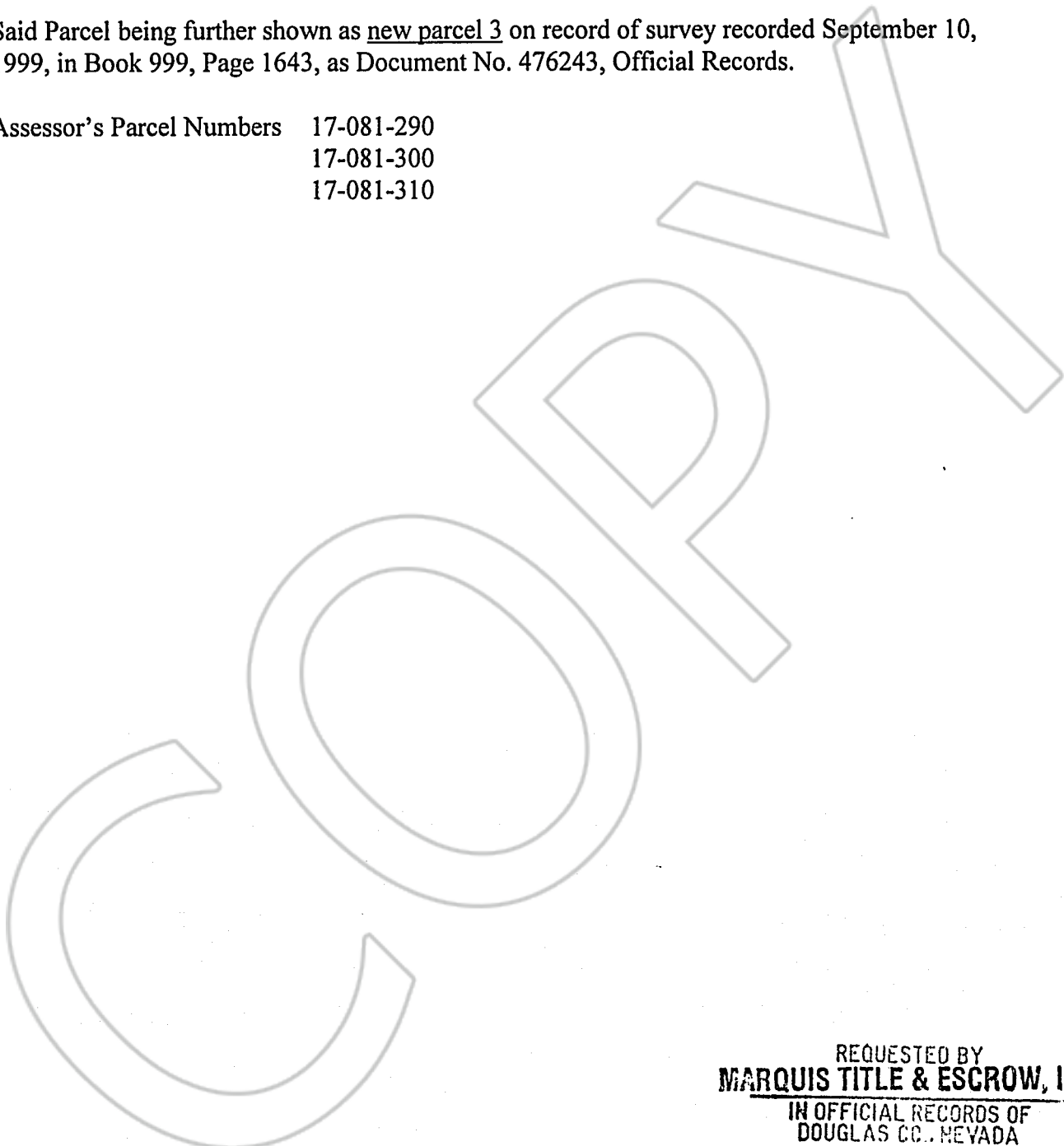

REQUESTED BY
MARQUIS TITLE & ESCROW, INC.
IN OFFICIAL RECORDS OF
DOUGLAS CO., NEVADA

1999 NOV 19 AM 10: 01

LINDA SLATER
RECORDER

\$ 11.00 PAID KD DEPUTY

0481147

BK 1199PG3524