

EXHIBIT "A"

LEGAL DESCRIPTION

ESCROW NO.: 99041480

The land referred to herein is situated in the State of Nevada,
County of Douglas, described as follows:

Lot 1, in Block E, of the final map of SUNRIDGE HEIGHTS II,
PHASE 2, a Planned Unit Development, filed for record in the
office of the County Recorder of Douglas County, State of
Nevada, on March 3, 1994, as Document No. 331447.

Assessor's Parcel No. 21-430-01

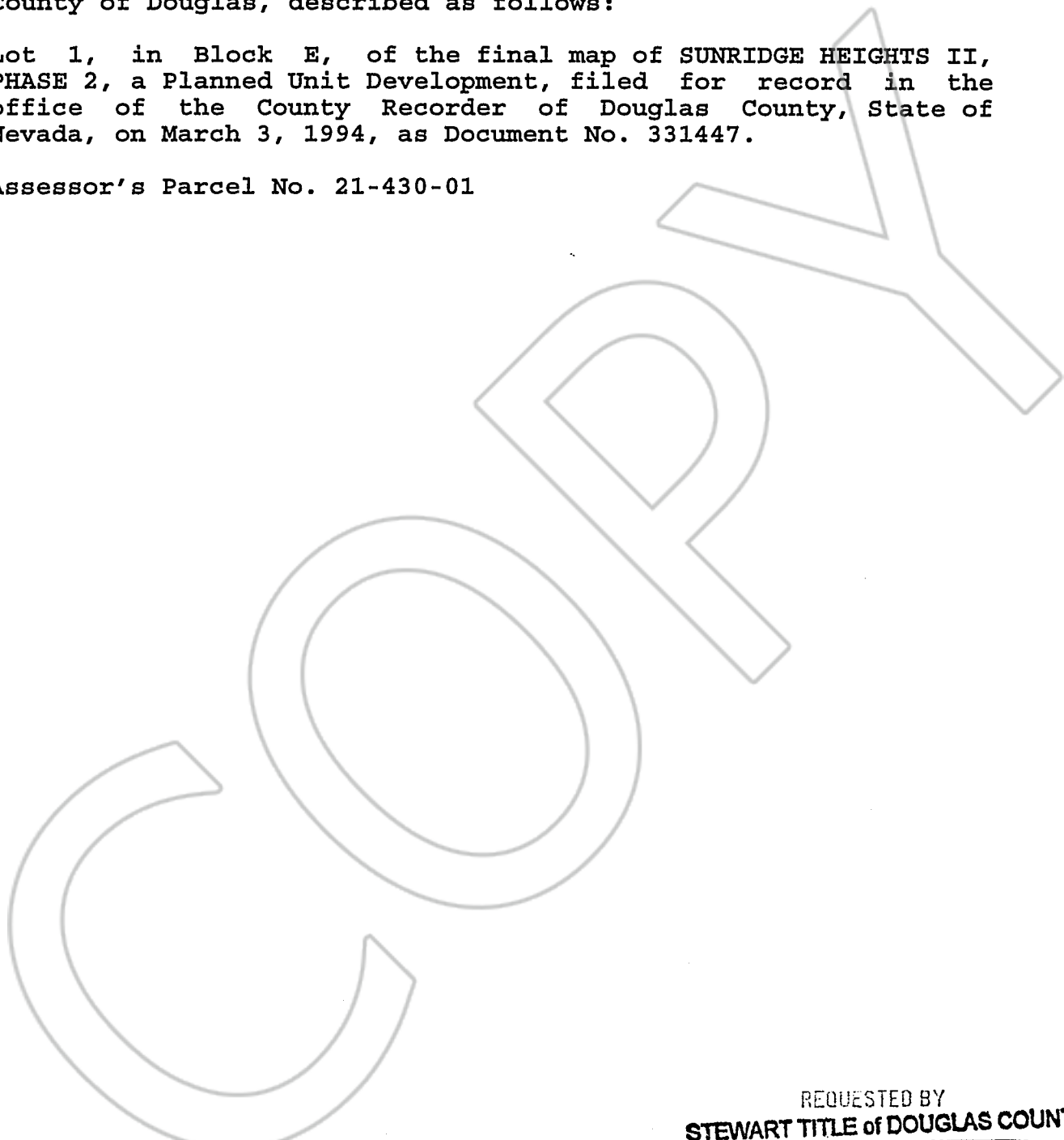

REQUESTED BY
STEWART TITLE of DOUGLAS COUNTY
IN OFFICIAL RECORDS OF
DOUGLAS CO. NEVADA

1999 DEC -8 AM 10: 17

LINDA SLATER
RECORDER

\$ 8.00 PAID *KD* DEPUTY

0482141

BK 1299PG 1286