

RECORDING REQUESTED BY:
STEWART TITLE COMPANY
WHEN RECORDED MAIL TO:

ESCROW NO. **99071208**
A.P.N. # **1220-02-002-001**

MYRON M. RINASZ
1665 Toler Lane
Gardnerville, NV 89410

NOTICE OF COMPLETION

Must be filed within 15 days after completion NRS 108.228

Individual or Corporation

NOTICE IS HEREBY GIVEN:

1. That the interest or estate stated in paragraph 3 below in the real property hereinafter described is owned by the following:

NAME	STREET AND NO.	CITY	STATE
MYRON M. RINASZ	1665 TOLER LANE	GARDNERVILLE, NV	89410
(If more than one owner of the interest stated, the name and address of each must be inserted.)			
	1665 TOLER LANE	GARDNERVILLE, NV	89410,

2. That the full name and address of the owner of said interest or estate, if there is only one owner, and the full names and addresses of all the co-owners who own said interest or estate as joint tenants, as tenants in common or otherwise, if there is more than one owner, are set forth in the preceding paragraph.

3. That the nature of the title of said owner, or if more than one, then of said owner and co-owners is: In Fee.

(If other than fee, strike out "In Fee" and insert for example "purchase under contract of purchase" or "lessee.")

4. That on the 24 day of January, 2000 a work of improvement on the real property hereinafter described was completed.

5. That the name of the original contractor, if any, for such work of improvement was Owner/Builder

(If no contractor for work of improvement as a whole, insert "No Contractor.")

That the real property herein referred to is situated in the City of an unincorporated area
County of DOUGLAS, State of Nevada and is described as follows:

See Exhibit "A" attached hereto and by reference made a part hereof for complete legal description.

Commonly known as: 1665 TOLER LANE, GARDNERVILLE, NV 89410

Read this note before signing.

If more than one owner, only one need sign, personally or by an agent.
The owner or agent who signs the notice itself must also sign the verification below.

BY 
MYRON M. RINASZ

VERIFICATION

The undersigned being duly sworn, says: That he/she/they read the foregoing notice and knows the contents thereof and the same is true of his/her/their own knowledge.

STATE OF NEVADA }
 } ss.
COUNTY OF DOUGLAS }

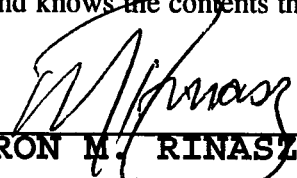
BY 
MYRON M. RINASZ

This instrument was acknowledged before me on 11/25/00,
by, MYRON M. RINASZ

Signature _____

Notary Public

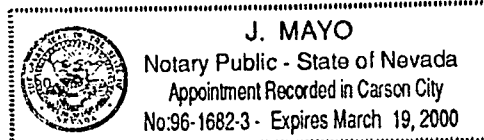

0485092

BK0100PG3945

EXHIBIT "A"

LEGAL DESCRIPTION

ESCROW NO.: 99071208

The land referred to herein is situated in the State of Nevada, County of Douglas, described as follows:

Township 12 North, Range 20 East, M.D.B. & M.:

BEGINNING at the North 1/4 corner of Section 2, Township 12 North, Range 20 East, thence North 89°59'44" along the North line of the Northeast 1/4 of Section 2, a distance of 865.21' to a point being the intersection of the Allerman Canal and the North line of said Section 2 and the True Point of Beginning, thence Southerly along the centerline of the Allerman Canal the following 36 courses:

South 12 degrees 28'13" East, 167.47' South 06 degrees 56'19" West, 153.74' South 00 degrees 00'28" East, 89.85' South 05 degrees 34'07" East, 418.48' South 11 degrees 21'24" West, 300.93' South 03 degrees 47'49" West, 290.45' South 12 degrees 43'41" West, 560.66' South 08 degrees 16'26" East, 400.50' South 34 degrees 47'17" East, 190.38' South 33 degrees 56'31" East, 172.02' South 03 degrees 49'24" East, 175.21' South 19 degrees 42'14" West, 148.48' South 45 degrees 02'59" West, 165.22' South 34 degrees 18'01" West, 145.60' South 02 degrees 19'55" West, 72.87' South 50 degrees 06'33" East, 48.64' North 85 degrees 25'10" East, 151.48' South 73 degrees 42'12" East, 116.24' South 36 degrees 34'32" East, 112.72' South 32 degrees 33'52" West, 296.72' South 44 degrees 00'08" West, 162.03' South 11 degrees 15'19" West, 104.39' South 25 degrees 54'51" East, 74.80' South 72 degrees 02'43" East, 103.02' North 77 degrees 13'57" East, 128.79' North 56 degrees 25'57" East, 180.34' North 85 degrees 17'03" East, 136.26' South 43 degrees 48'49" East, 166.67' South 00 degrees 21'50" East, 102.53' South 75 degrees 24'09" West, 141.72' South 56 degrees 56'08" West, 117.12' South 19 degrees 36'36" West, 86.49' South 21 degrees 05'07" East, 153.77' South 55 degrees 13'52" West, 209.97' thence South 35 degrees 07'51" West, 105.44' to the Northerly line of the South 1/2, Southwest 1/4, Southwest 1/4 Section 2, thence South 90 degrees 00'00" West, 364.82' to a fence corner; thence North 0 degrees 02'00" East, 460.95', thence North 4 degrees 07'00" West, 904.70', thence North 38 degrees 06'00" North, 502.4', thence North 7 degrees 21'00" West, 171.4', thence North 34 degrees 29'00" West, 45.1', thence North 33 degrees 23'00" West, 52.7', thence North 28 degrees 1'00" West, 264.5', thence North 9 degrees 12' West, 118.2', thence North 7 degrees 30'00" West, 279.4', thence North 10 degrees 26'00" East, 353.10', thence West 40.0', to a

Continued on next page

0485092

BK0100PG3946

Order No. 99071208

fence corner, thence North 0 degrees 51'00" West, 352.5', thence North 0 degrees 28'00" East, 771.3', thence North 11 degrees 12'00" East, 289.9', thence North 21 degrees 47'00" West 142.6', thence North 0 degrees 28'00" East, 69.1', thence North 17.11' to the North line of Section 2, thence South 89 degrees 59'44" East, 180.04' to the Point of Beginning.

Assessors Parcel No. 1220-02-002-001

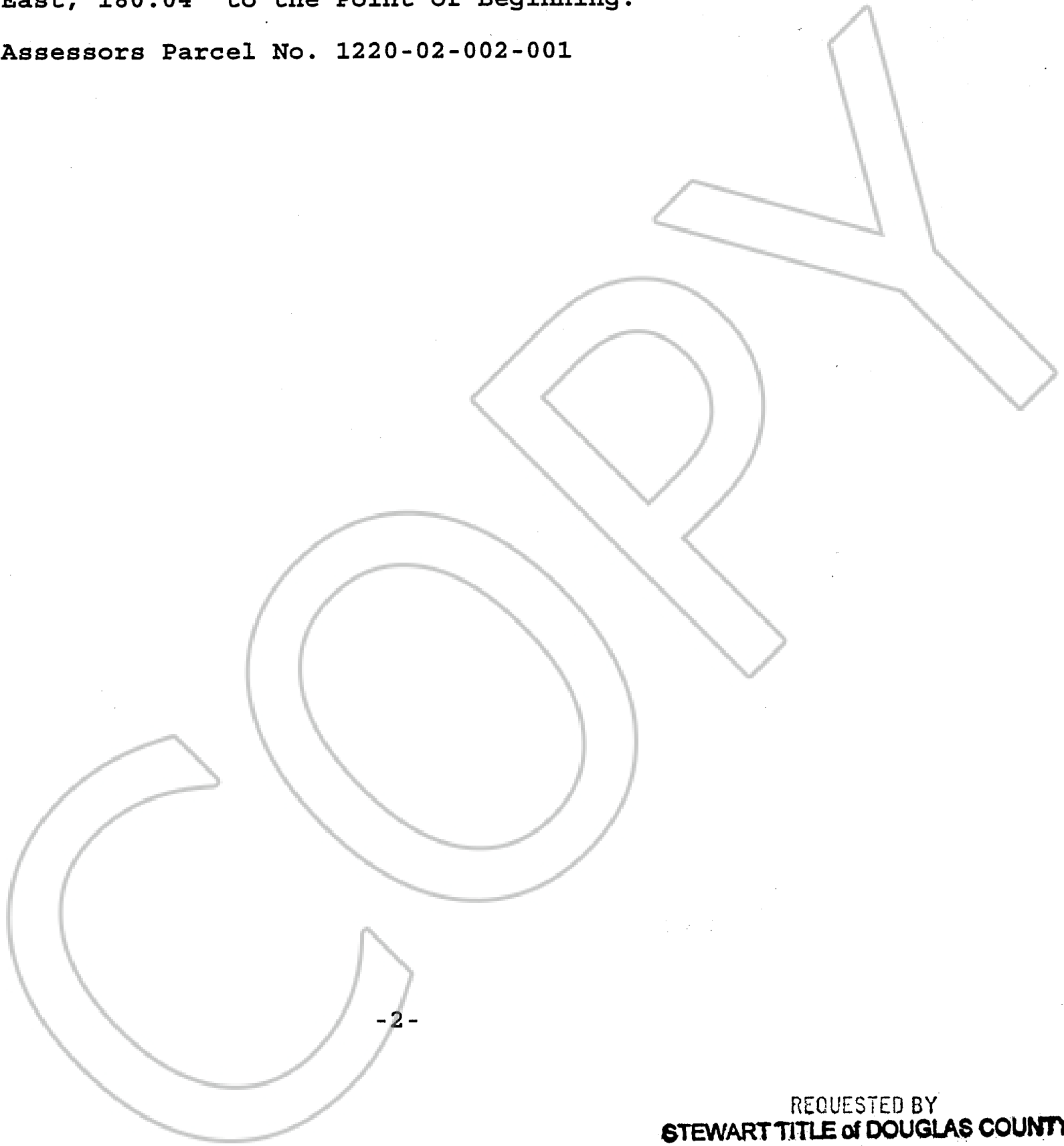

-2-

REQUESTED BY
STEWART TITLE of DOUGLAS COUNTY
IN OFFICIAL RECORDS OF
DOUGLAS CO., NEVADA

2000 JAN 26 PH 3: 26

0485092
BK0100PG3947

LINDA SLATER
RECORDER
\$ 9.00 PAID KJ DEPUTY