

Document received
in soiled or
damaged condition

Escrow No: 99100859
Assessor's Parcel No 23-160-010:

**GRANT, BARGAIN AND SALE DEED
CORRECTION**

THIS INDENTURE WITNESSETH: That for a valuable consideration, receipt of which is hereby acknowledged,

George E. Muller, an unmarried man

doe(s) hereby **GRANT, BARGAIN, SELL, and CONVEY** to

SUSAN BENTLY, an unmarried woman

all that real property situated in the County of Douglas, State of Nevada, specifically described as follows:

SEE EXHIBIT "A" ATTACHED HERETO AND BY THIS REFERENCE MADE A PART HEREOF.

TOGETHER WITH all and singular the tenements, hereditaments, and appurtenances, including easement and water rights, if any, thereto belonging or in anywise appertaining, and any reversions, rents, issues, or profits thereof.

WITNESS my hand this 8th day of JANUARY, 2000

George E Muller
George E. Muller

STATE OF WYOMING
COUNTY OF LINCOLN

On 1-8-2000, personally appeared before me, a notary public, _____
George E. Muller
_____ Who acknowledged that he
executed the above instrument.

[Signature]
Notary Public

When recorded mail to:

Grantee

The Grantors declare:
Documentary Transfer Tax is \$0 exempt #3
___ computed on full value
___ computed on full value less liens

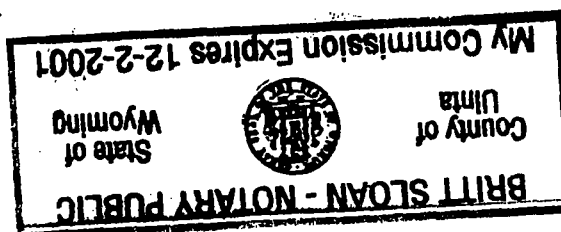

0485963

BK0200P61416

LEGAL DESCRIPTION
FOR
2457 JUNIPER ROAD

A parcel of land located within the NE1/4 of Section 33, Township 13 North, Range 21 East, M.D.B.&M., and more particularly described as follows:

Commencing at the North One-Quarter Corner of Section 33, Township 13 North, Range 21 East, M.D.B.&M. thence N89°41'57"W along the North Line of the North East One-Quarter of said Section 33 a distance of 1,048.53 feet to a 5/8" rebar tagged RLS 1350 which is the Northeast Corner of the parcel and the TRUE POINT OF BEGINNING; thence N89°41'57"W along the said North Line a distance of 614.09 feet to a 5/8" rebar with cap stamped PLS 3090; thence S15°53'28"E a distance of 780.51 feet to a 5/8" rebar tagged RLS 1350; thence S89°40'15"E a distance of 399.52 feet to a 5/8" rebar tagged RLS 1350; thence N00°03'26"E a distance of 749.76 feet to the TRUE POINT OF BEGINNING.

Said Parcel contains 379,956 square feet more or less or 8.72 acres.

INCLUDED in the above description, is a 25 foot wide road easement that lies adjacent to and south of the north property line.

The basis of bearings for the above description is the West Line of the Newburgh Parcel as shown on the Record of Survey Map for Henry and Jenny Newburgh. Said map is recorded as Document #183289

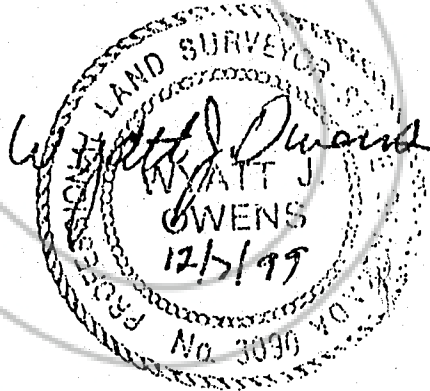

REQUESTED BY
MARQUIS TITLE & ESCROW, INC.
IN OFFICIAL RECORDS OF
DOUGLAS CO., NEVADA

2000 FEB -8 PM 12: 02

LINDA SLATER
RECORDER

\$8.00 PAID *RJ* DEPUTY

0485968

BK0200PG1417