

DECLARATION OF HOMESTEAD

APN 23-180-59

KNOW ALL MEN BY THESE PRESENTS:

That we, PATRICK M. BRENNAN and LAURA R.T. BRENNAN do hereby certify and declare as follows:

That we are husband and wife and that we are now actually residing together on the land and premises hereinafter described, consisting of the land and dwelling house thereon.

That we intend to use and claim the said property hereinafter described, together with the dwelling house thereon, and it's appurtenances, as a homestead.

That the property and premises herein referred to are situate in the City of Minden, County of Minden, State of NEVADA, and are described as follows:

See Exhibit A attached hereto and made a part hereof.

Property Commonly known as: 2191 CALLE DEL SOL, MINDEN, NV 89423

That I do, by these presents, hereby select and claim the said premises and its appurtenances as a homestead, and that all of the said property is necessary to the use and enjoyment as a homestead.

Dated: March 3, 2000

STATE OF NEVADA

COUNTY OF DOUGLAS

} S.S.

Patrick M. Brennan
PATRICK M. BRENNAN

Laura R.T. Brennan
LAURA R.T. BRENNAN

This instrument was acknowledged before me on

March 4, 2000

by PATRICK M. BRENNAN & LAURA R.T. BRENNAN.

Danielle E. Curtis
Notary Public



(This area for official notarial seal)

SPACE BELOW THIS LINE FOR RECORDER'S USE

RECORDING REQUESTED BY

AND WHEN RECORDED MAIL TO

Name **MR. AND MRS. PATRICK BRENNAN**

Street Address **2191 CALLE DEL SOL----**

City, State Zip **GARDNERVILLE, NV 89410**

00082484-201-DEC

0487633

BK0300PG1483

Exhibit A

All that certain lot, piece or parcel of land situate in the County of Douglas, State of Nevada, described as follows:

Being a portion of Section 31, Township 13 North, Range 21 East, further described as follows:

PARCEL NO. 1:

Parcel B as set forth on Parcel Map LDA 99-017 for Allen J. and Elizabeth Allie, filed for record in the Office of the County Recorder of Douglas County, State of Nevada, on June 16, 1999, in Book 699, Page 3497, Document No. 470440

Assessor's Parcel Number: 23-180-59

PARCEL NO. 2:

Being easements 25 and 50 feet in width, for road purposes, appurtenant, as conveyed in the Grant of Easements, recorded April 7, 1980, in Book 480 of official records, Pages 345, 347, 351, 355 and 358, Douglas County, Nevada.

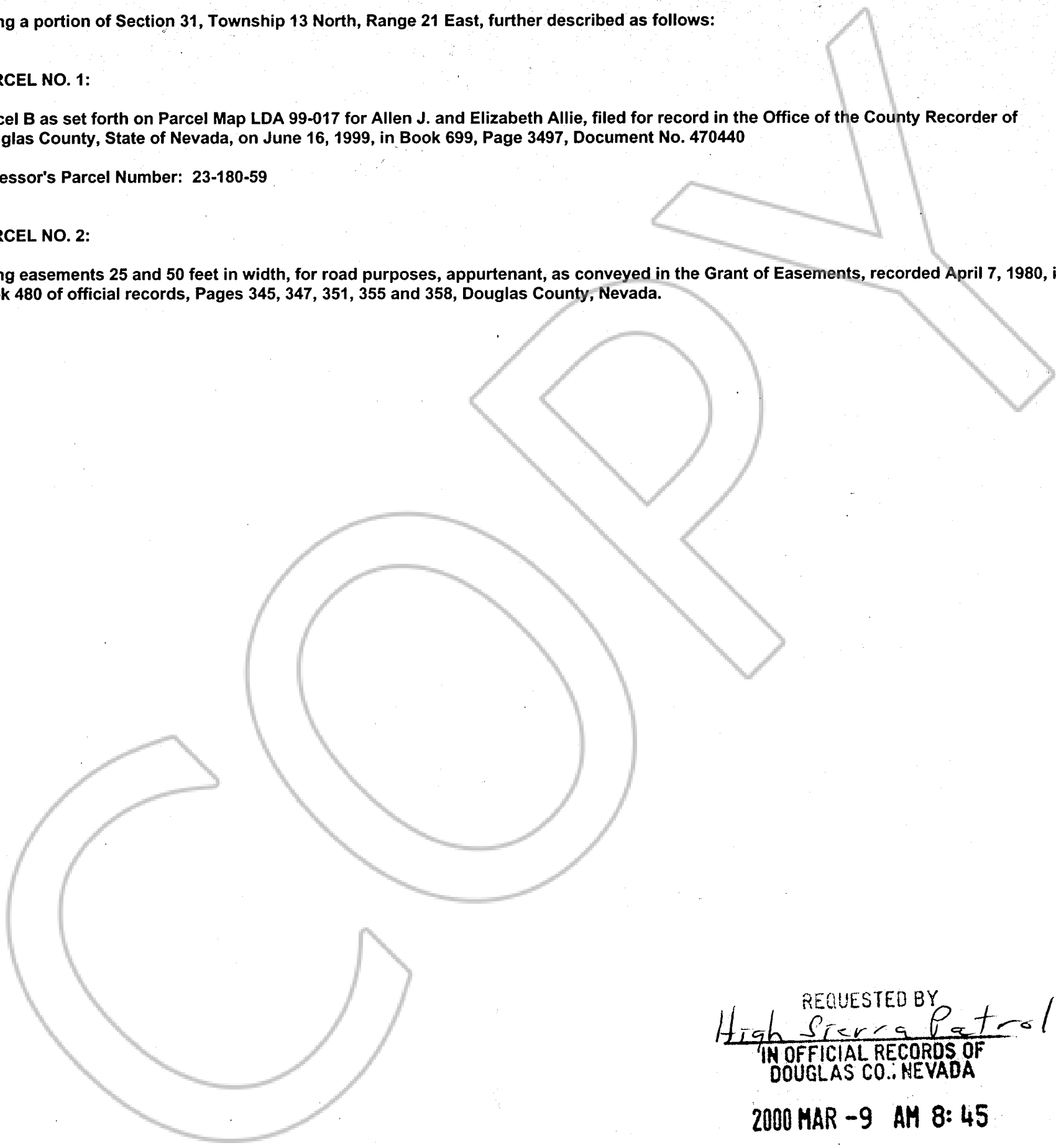

REQUESTED BY
High Sierra Patrol
IN OFFICIAL RECORDS OF
DOUGLAS CO., NEVADA

2000 MAR -9 AM 8:45

LINDA SLATER
RECORDER

\$^{8.00} PAID *Kg* DEPUTY

0487633

BK0300PG1484