

LEGAL DESCRIPTION

The land referred to herein is situated in the State of Nevada, County of Douglas, described as follows:

Lot 20, in Block A, as set forth on the Official Map of MISSION HOT SPRINGS UNIT NO. 2, a Planned Unit Development, filed for record in the Office of the Recorder of Douglas County, Nevada on September 14, 1988, in Book 988, Page 1249, as Document No. 186262, Official Records.

Assessors Parcel No. 21-040-60

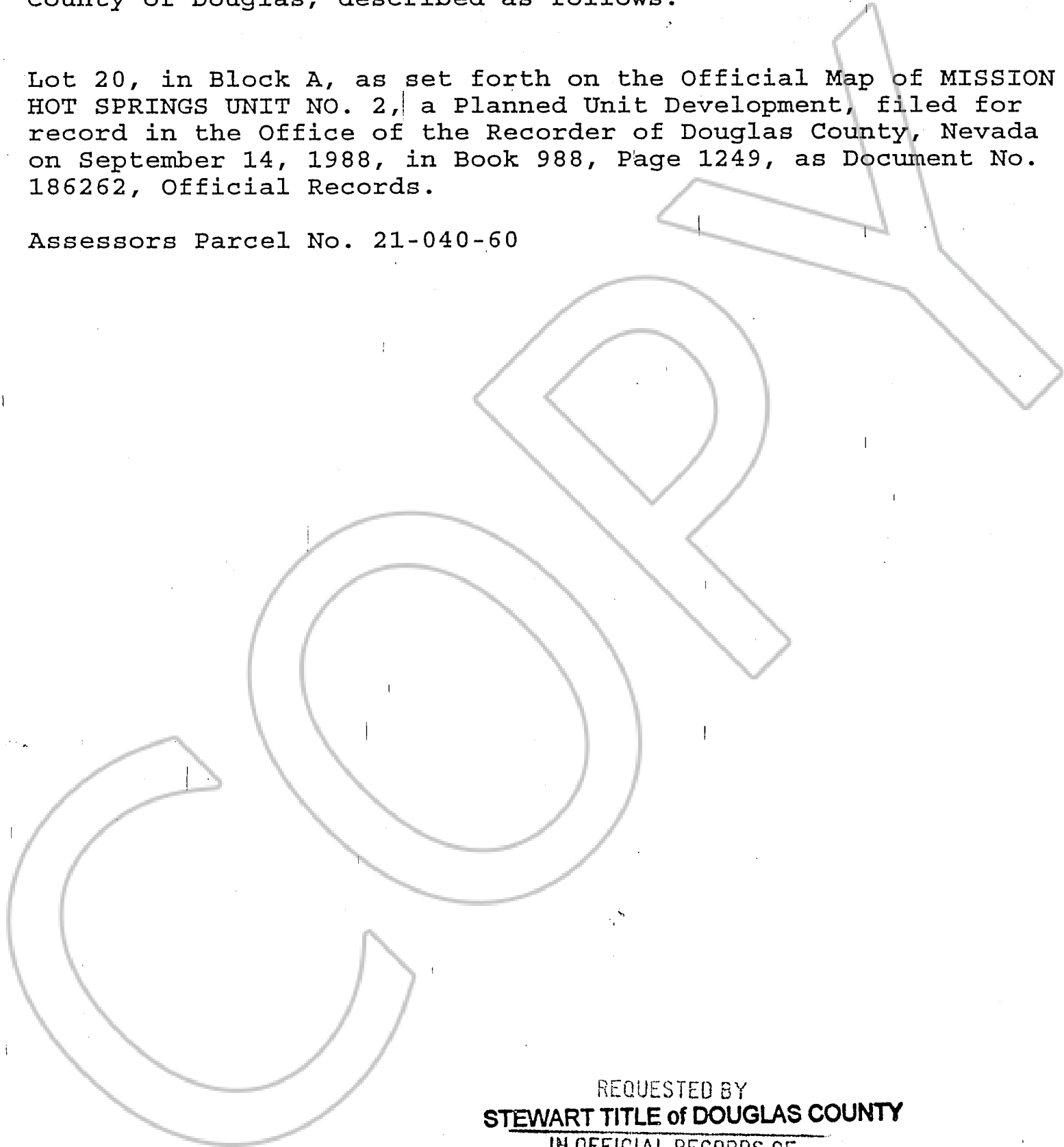

REQUESTED BY
STEWART TITLE of DOUGLAS COUNTY
IN OFFICIAL RECORDS OF
DOUGLAS CO., NEVADA

2000 MAY -5 PM 3: 32

LINDA SLATER
RECORDER

\$ ^{8.00} PAID *LS* DEPUTY

STEWART TITLE
Guaranty Company