

9 -

1995HW15
2925913

Western Sunrise AKA CrossLand Mortgage Corp

Recording Requested By [REDACTED]
3902 S. State Street Salt Lake City, UT 84107
Loan ID: 0016906885

27-005

ASSIGNMENT OF DEED OF TRUST

For Value Received, the undersigned holder of a Deed of Trust (herein "Assignor") whose address is
3902 S. State Street Salt Lake City, UT 84107

does hereby grant, sell, assign, transfer and convey, unto
RESIDENTIAL FUNDING CORPORATION



a corporation organized and existing under the laws of
whose address is

(herein "Assignee"),

all beneficial interest under a certain Deed of Trust, dated August 18th, 1999
STEVE METCALF and DONNA METCALF, husband and wife

, made and executed by

APN: 21-180-330

to T.D. Service CO., a CA Corp.

Trustee, and given

to secure payment of Twenty Six Thousand Seven Hundred Fifty and no/100 (\$ 26,750.00)

(Include the Original Principal Amount)

which Deed of Trust is of record in Book, Volume, or Liber No. 0899, at page 5191 (or as No. 0475418) of the 8-27-99 Records of DOUGLAS County, State of Nevada, together with the note(s) and obligations therein described, the money due and to become due thereon with interest, and all rights accrued or to accrue under such Deed of Trust.

TO HAVE AND TO HOLD, the same unto Assignee, its successor and assigns, forever, subject only to the terms and conditions of the above-described Deed of Trust.

After Recording Return To:

PEELLE MANAGEMENT CORPORATION
ASSIGNMENT JOB #90603
P.O. BOX 1710
CAMPBELL, CA 95009-1710
1-408-866-6868

Nevada Assignment of Deed of Trust

Page 1 of 2

12/95

VMP-995B(NV) (9512)

VMP MORTGAGE FORMS - (800)521-7291

Initials: _____

0492288



BK0500PG4232

IN WITNESS WHEREOF, the undersigned Assignor has executed this Assignment of Deed of Trust on
AUGUST 27, 1999

Western Sunrise AKA
CrossLand Mortgage Corp

Witness

(Assignor)

By:



(Signature)

JANNETE QUAYLE
ASSISTANT SECRETARY

Witness

Attest

Seal:

This Instrument Prepared By: Western Sunrise AKA CrossLand Mortgage Corp
3902 S. State Street, Salt Lake City, UT 84107 , tel. no.: 800-446-3300

State of CALIFORNIA
County of SACRAMENTO

This instrument was acknowledged before me on AUGUST 27, 1999
by JANNETE QUAYLE

as ASSISTANT SECRETARY

of Western Sunrise AKA
CrossLand Mortgage Corp



THERESA M. WARNER

0492288

BK0500PG4233

Exhibit "A"

That Portion of the Northwest $\frac{1}{4}$ of the Northeast of Section 34, Township 14 North, Range 20 East M.D.B. & M., in the County of Douglas, State of Nevada, being more particularly described as follows:
The westerly 236.77 feet of Parcel 2, of that certain parcel map for Michael and Judith Bray, recorded in Book 1098, at Page 1895, as Document No. 451403, Official Records.

Said parcel being further shown on Lot line adjustment recorded April 12, 199, in Book 499 Page 2137, as Document No. 465505, Official Records.

Assessor's Parcel No. 21-180-33.

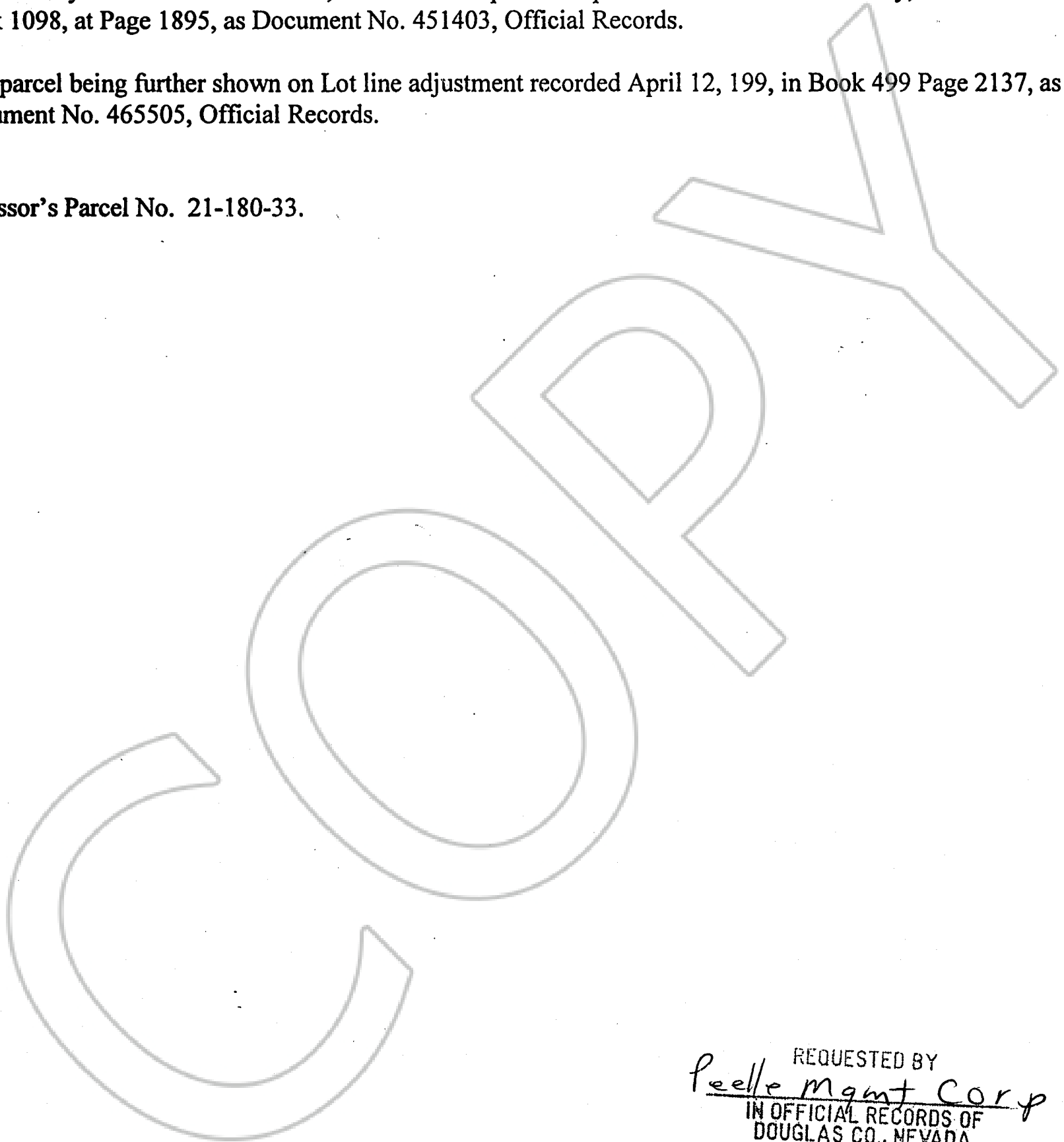

REQUESTED BY
Peelle mgmt Corp
IN OFFICIAL RECORDS OF
DOUGLAS CO., NEVADA

2000 MAY 19 PM 2:59

LINDA SLATER
RECORDER

\$ 9.00 PAID K2 DEPUTY

0492288

BK0500PG4234