

LEGAL DESCRIPTION

The land referred to herein is situated in the State of Nevada, County of Douglas, described as follows:

Lot 31, in Block O, as set forth on that certain Final Map of SUNRIDGE HEIGHTS, PHASES 7B and 9, a Planned Unit Development, recorded in the office of the Douglas County Recorder on September 5, 1995 in Book 995, Page 410, as Document No. 369825, and by Certificate of Amendment recorded August 14, 1996, in Book 896, Page 2588, as Document No. 394289.

Assessor's Parcel No. 21-522-30.

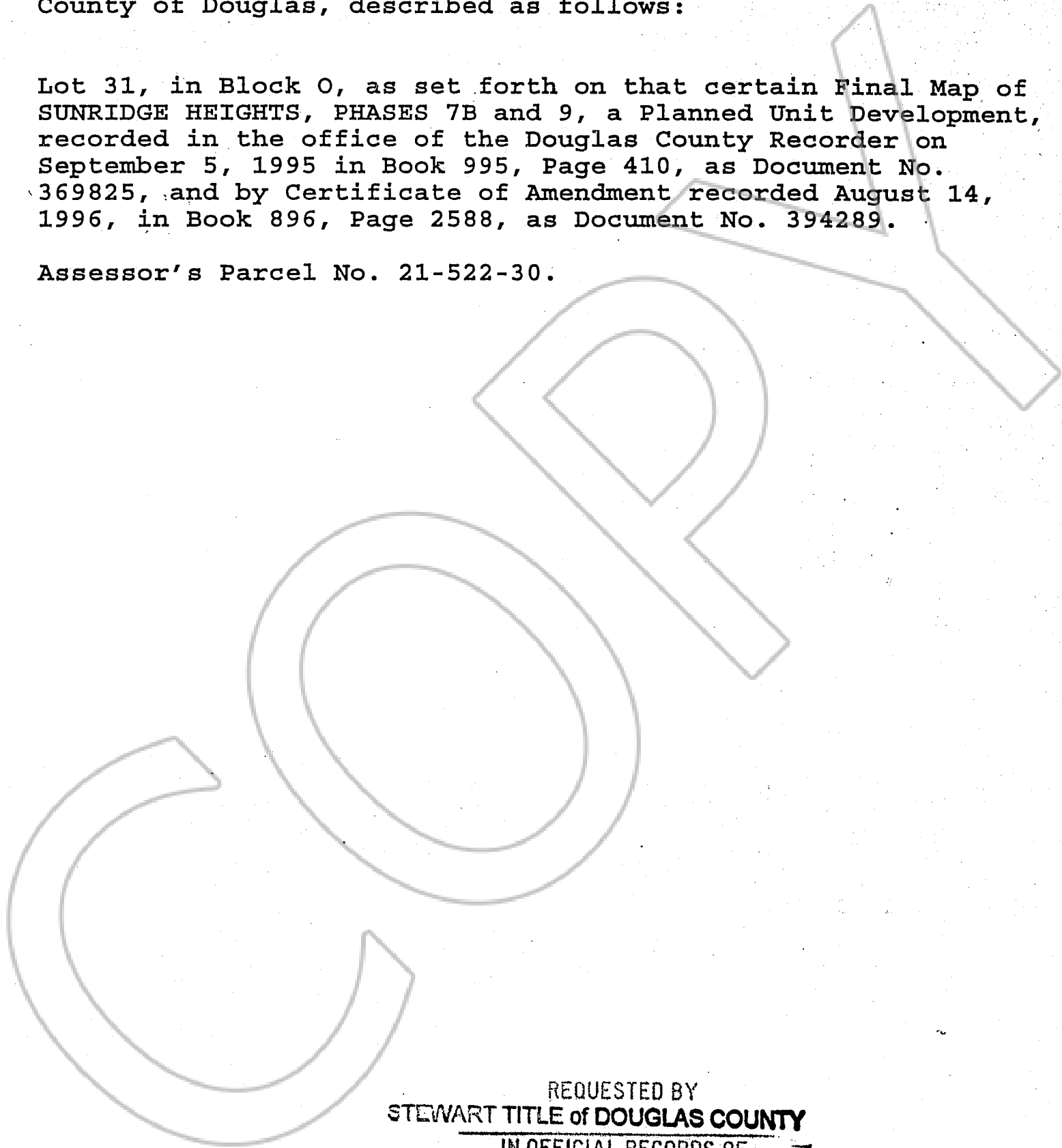

REQUESTED BY
STEWART TITLE of DOUGLAS COUNTY
IN OFFICIAL RECORDS OF
DOUGLAS CO., NEVADA

2000 MAY 31 PM 3: 33

LINDA SLATER
RECORDER

\$ 8.00 PAID Bh DEPUTY

SCHEDULE A
CLTA PRELIMINARY REPORT
(7/88)

0493090
BK0500PG6866

STEWART TITLE
Guaranty Company