

CORPORATION ASSIGNMENT OF DEED OF TRUST NEVADA

FOR VALUE RECEIVED, THE UNDERSIGNED HEREBY GRANTS, ASSIGNS AND TRANSFER TO:

FEDERAL NATIONAL MORTGAGE ASSOCIATION

2000 - ~~2004~~ - TGZ
2006

ALL BENEFICIAL INTEREST UNDER THAT CERTAIN DEED OF TRUST DATED 02/17/99, EXECUTED BY: ROBERT B WOODARD AND MICHELLE A WOODARD, HUSBAND AND WIFE, AS JOINT TENANTS, TRUSTOR: TO TICOR TITLE, TRUSTEE AND RECORDED AS INSTRUMENT NO. 0462018 ON 02/26/99, IN BOOK 0299, PAGE 5457, OF OFFICIAL RECORDS IN THE COUNTY RECORDER'S OFFICE OF DOUGLAS COUNTY, IN THE STATE OF NEVADA.

DESCRIBING THE LAND THEREIN: AS MORE FULLY DESCRIBED IN SAID DEED OF TRUST

TOGETHER WITH THE NOTE OR NOTES THEREIN DESCRIBED OR REFERRED TO, THE MONEY DUE AND TO BECOME DUE THEREON WITH INTEREST, AND ALL RIGHTS ACCRUED OR TO ACCRUE UNDER SAID DEED OF TRUST/MORTGAGE.

DATED: June 23, 2000

COUNTRYWIDE HOME LOANS, INC.

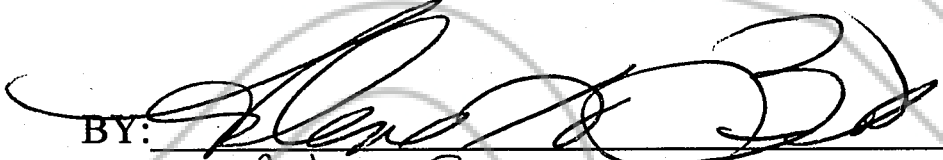
BY: 
Arlene Behr

State of: California)
County of: Ventura)

On June 23, 2000 before me Kristi Hufford, notary public, personally appeared Arlene Behr, personally known to me (or proved to me on the basis of satisfactory evidence) to be the person(s) whose name(s) is/are subscribed to within instrument and acknowledged to me that he/she/they executed the same in his/her/their authorized capacity(ies), and that by his/her/their signature(s) on the instrument the person(s), or the entity upon behalf of which the person(s) acted, executed the instrument.

Witness my hand and official seal.

KRISTI HUFFORD

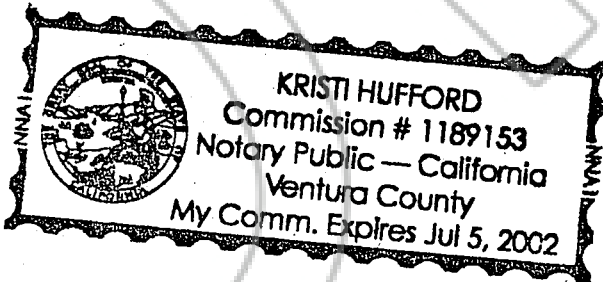

RECORDING REQUESTED BY:

CTC REAL ESTATE SERVICES

AND WHEN RECORDED MAIL DOCUMENT TO:

Countrywide Home Loans
FKA COUNTRYWIDE FUNDING CORPORATION
400 COUNTRYWIDE WAY SV-35SIMI VALLEY, CA 93065

LOAN No.: 2636191

T.S. No.: 00-00086

TITLE ORDER#: 446982

0495302

BK0700PG0560

The land referred to in this Guarantee is situated in the State of Nevada, County of Douglas, and is described as follows:

AP# 27-861-37 (Old), 1220-21-110-032 (New)

All that certain lot, piece or parcel of land situate in the County of , State of Nevada, described as follows:

Lot 45, as set forth on the final map of TILLMAN ESTATES, filed for record in the Office of the County Recorder of Douglas County, State of Nevada, on April 12, 1994 in Book 494, Page 2192, as Document No. 334956.

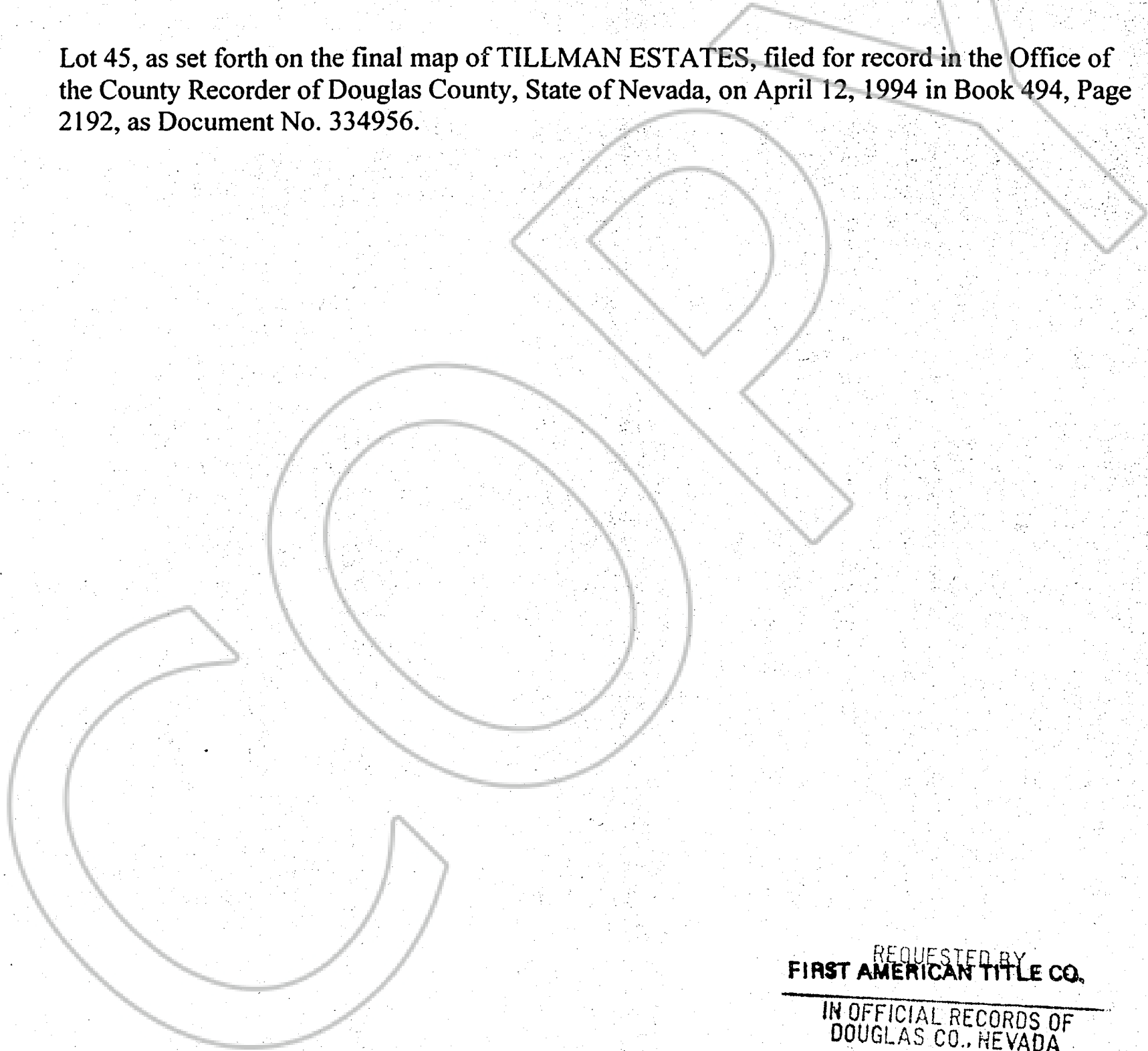

REQUESTED BY
FIRST AMERICAN TITLE CO.

IN OFFICIAL RECORDS OF
DOUGLAS CO., NEVADA

2000 JUL -6 AM 11:47

LINDA SLATER
RECORDER

\$ 8.00 PAID K2 DEPUTY

0495302

BK0700PG0561