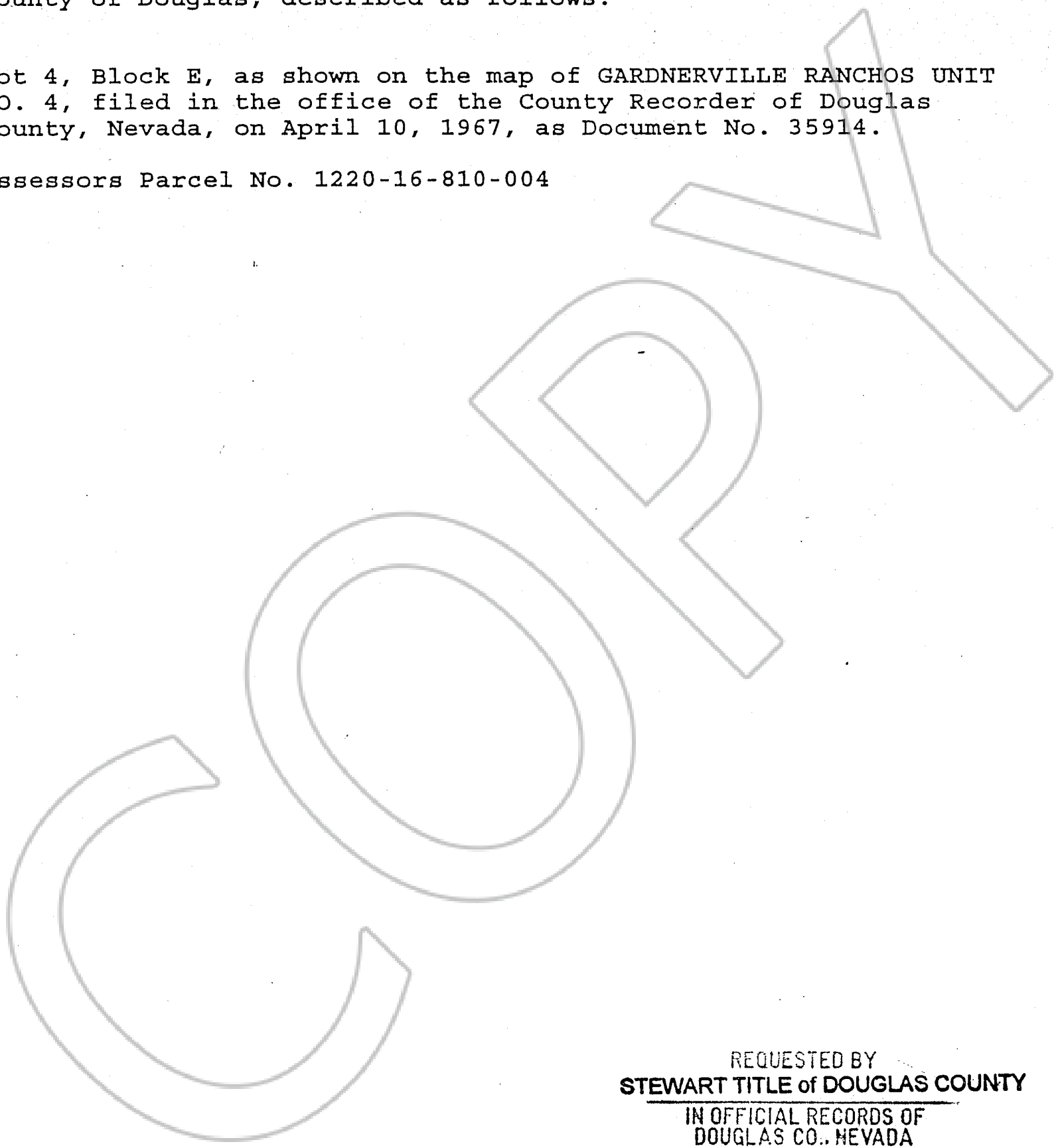

EXHIBIT "A"
LEGAL DESCRIPTION

The land referred to herein is situated in the State of Nevada,
County of Douglas, described as follows:

Lot 4, Block E, as shown on the map of GARDNERVILLE RANCHOS UNIT
NO. 4, filed in the office of the County Recorder of Douglas
County, Nevada, on April 10, 1967, as Document No. 35914.

Assessors Parcel No. 1220-16-810-004



REQUESTED BY
STEWART TITLE of DOUGLAS COUNTY
IN OFFICIAL RECORDS OF
DOUGLAS CO., NEVADA

2000 JUL 11 PM 3:05

LINDA SLATER
RECORDER

\$8⁰⁰ PAID *KJ* DEPUTY

0495570

BK0700PG1349