

GRANT, BARGAIN AND SALE DEED

RPTT \$243.10
APN: 1220-11-001-015

THIS INDENTURE WITNESSETH: That

FOR A VALUABLE CONSIDERATION, receipt of which is hereby acknowledged,
~~HOMER R. ROBINETT TRUSTEE and MAXINE M. ROBINETT TRUSTEE~~
THE ROBINETT FAMILY TRUST DATED JULY 5, 1993, HOMER R. ROBINETT AND MAXINE M. ROBINETT, TRUSTEES
et al.

doe(es) hereby GRANT(s) BARGAIN SELL and CONVEY to
CHRIS M. KNIGHT and ~~MARY K. KNIGHT~~ BETTY M. KNIGHT, husband and wife as joint tenants
with right of survivorship

and to the heirs and assigns of such Grantee forever, all the following real property situated in the city MINDEN county
of Douglas, state of Nevada bounded and described as follows:

See Exhibit A attached hereto and made a part hereof.

TOGETHER with all tenements, hereditaments and appurtenances, if any, thereto belonging or appertaining, and any
reversions, remainders, rents, issues or profits thereof.

Dated: 7/18/00

STATE OF NEVADA

COUNTY OF Douglas

} s.s. Homer R. Robinett Trustee
HOMER R. ROBINETT TRUSTEE

This instrument was acknowledged before me on

7/18/00
by Homer R. Robinett and Maxine M. Robinett

Maxine M. Robinett Trustee
MAXINE M. ROBINETT TRUSTEE

Notary Public



(This area for official notarial seal)

SPACE BELOW THIS LINE FOR RECORDER'S USE

WHEN RECORDED MAIL TO

Name **CHRIS M. KNIGHT**
Street **1138 LINDA ANNE CT**
Address **GARDNERVILLE, NV 89410**
City, State
Zip
Order No. **00083234-201-KTK**

0495963

030876.EDC6/29/00

BK0700PG2670

Exhibit A

All that real property situate in the County of Douglas , State of Nevada, described as follows:

PARCEL NO. 1

A portion of the Southeast 1/4 of the Northeast 1/4, Section 11, Township 12 North, Range 20 East, M.D.B.&M., described as follows:

COMMENCING at the 1/4 corner common to Section 11 and 12, Township 12 North, Range 20 East, M.D.B.&M., as said 1/4 corner is shown on the map of Pinenut Subdivision Unit No. 1, filed for record in the office of the Douglas County recorded June 11, 1963, as File No. 22783; thence North 0°08'00" East along the East line of said Section 11, 1322.95 feet; thence North 89°46'45" West, 340.00 feet; thence 89°46'45" West, 292.89 feet to the true point of beginning, said point being the Northwest corner of the parcel described in the Contract of Sale to Victor Burton, et ux, recorded March 28, 1973, in Book 373, Page 741, File No. 64946, Official Records; thence continuing North 89°46'45" West 355.00 feet; thence South 0°29'04" West 278.74 feet; thence South 89°51'30" East 305.00 feet; thence along a curve to the right through an angle of 90°00', a radius of 50.00 feet, a length of 78.54 feet to the Southwest corner of the aforesaid Burton parcel; thence North 0°29'04" East along said Burton parcel 228.54 feet more or less to the point of beginning.

PARCEL NO. 2

Together with an easement for ingress and egress over the parcels of land described as Parcel 2 in Deed recorded February 16, 1973, in Book 273, Page 443, File No. 64309, Official Records.

ASSESSOR'S PARCEL NO. 1220-11-001-015

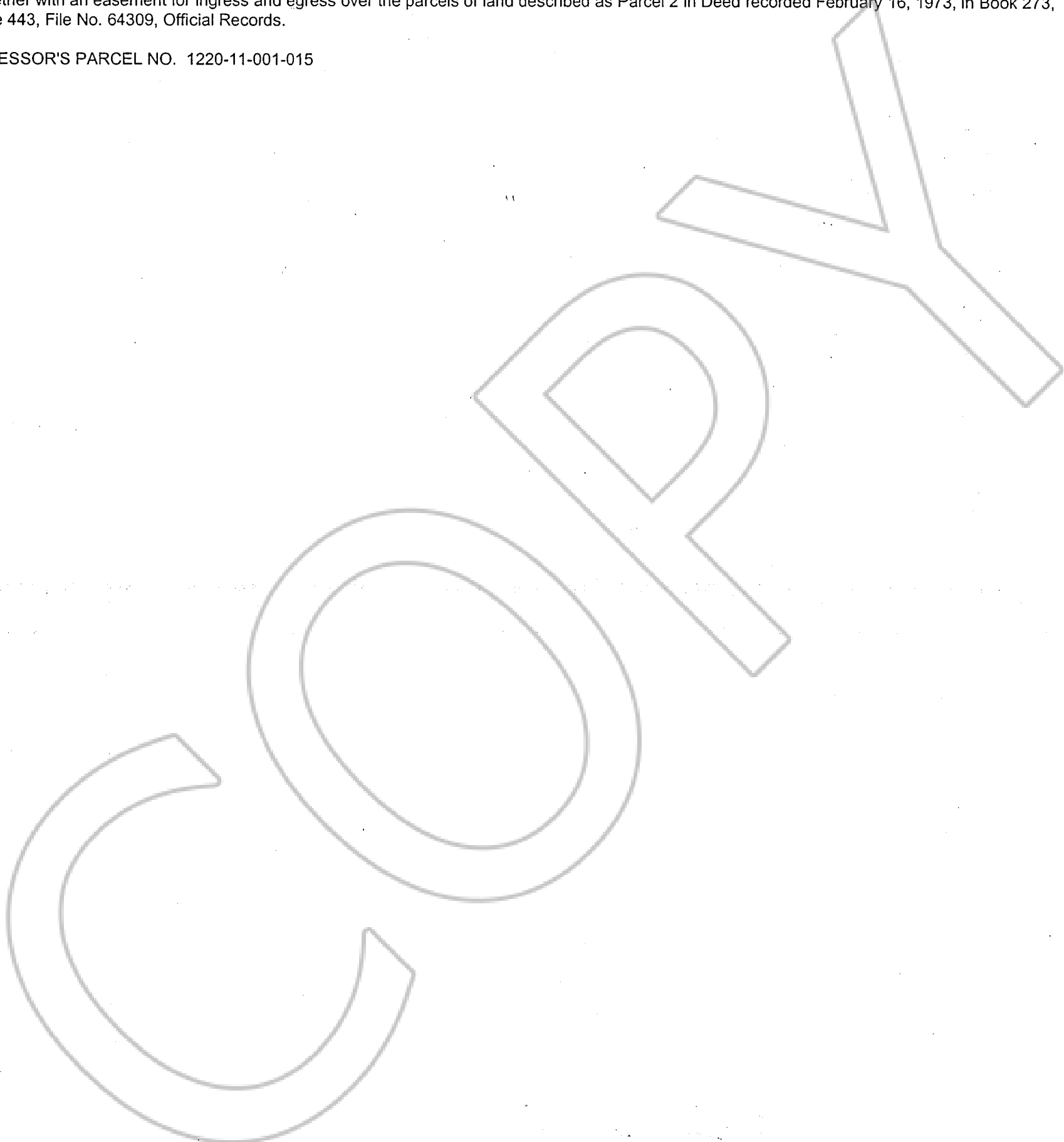

REQUESTED BY
WESTERN TITLE COMPANY, INC.

IN OFFICIAL RECORDS OF
DOUGLAS CO., NEVADA

2000 JUL 19 PM 3:41

LINDA SLATER
RECORDER

\$ 8.00 PAID *AS* DEPUTY

0495963

BK0700PG2671