

RECORDING REQUESTED BY:

North American Deed Company
2700 E. Sunset Rd, Suite 20
Las Vegas, NV 89120-3519
PH: 888-715-6400

AFTER RECORDING MAIL TO:

Don G. and Betty L. Rose
1358 Downs Drive
Minden, Nevada 89423

MAIL TAX STATEMENT TO:

Don G. and Betty L. Rose
1358 Downs Drive
Minden, Nevada 89423

RPTT: \$0- Exempt 8

Exempt (8): A transfer of title to or from a trust, if the transfer is made without consideration.

APN: 21-110-52

NEW APN - 1420-33-610-051

GRANT, BARGAIN, SALE DEED

TITLE OF DOCUMENT

THIS INDENTURE WITNESSETH THAT,

Donald G. Rose aka Don G. Rose and Betty L. Rose, husband and wife, as joint tenants with right of survivorship, and not as tenants in common

For no consideration, do(es) hereby Grant, Bargain, Sell and Convey unto:

Don G. Rose and Betty L. Rose, Trustees, or their successors in trust, under the "ROSE LIVING TRUST", dated July 19, 2000 and any amendments thereto, as described on that Certificate of Trust attached hereto as Exhibit "A", to have and to hold as Community Property of Don G. Rose and Betty L. Rose

ALL that real property situated in the County of Douglas, State of Nevada, more particularly described in Exhibit "B", attached hereto

Prior Recorded Doc. Ref.: Joint Tenancy Deed: Recorded November 13, 1990; BK1190, PG1663, Doc. No. 238672

- Subject To: 1. Taxes for the Current fiscal year, paid current
2. Restrictions, Conditions, Covenants, Rights, Rights of Way, and Easements now of record, if any.

WITNESS my/our hand(s), this 19th day of July, 2000.

Signature of Donald G. Rose aka Don G. Rose

Signature of Betty L. Rose

STATE OF NEVADA }
}ss:
COUNTY OF WASHOE }

NOTARY STAMP/SEAL

This instrument was acknowledged before me, this 19th day of July, 2000, by Donald G. Rose aka Don G. Rose and Betty L. Rose.

Signature of Notary Public
Notary Public
My Commission Expires:

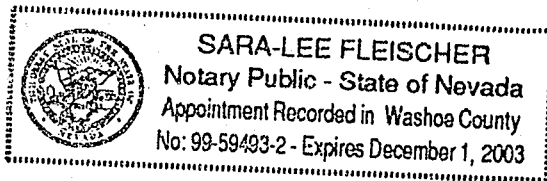

0496955
BK0800PG0161

Certificate of Trust

The undersigned Trustors and Trustees hereby certify the following:

1. This Certificate of Trust refers to the ROSE LIVING TRUST, dated July 19, 2000 under a revocable trust agreement executed on July 19, 2000 by DON G. ROSE and BETTY L. ROSE as Trustors.
2. The address of the Trustors is 1358 Downs Drive, Minden, Nevada 89423.
3. The initial Trustees of the Trust are:

DON G. ROSE
BETTY L. ROSE

4. The present Trustees are:

DON G. ROSE
BETTY L. ROSE

5. Unless otherwise provided in our Trust Agreement, when either one or both of us are serving as Trustee under our Trust, that one or either of us may conduct business and act on behalf of our Trust without the consent of any other Trustees.
6. Our Trustees under our Trust Agreement are authorized to acquire, sell, convey, encumber, lease, borrow, manage and otherwise deal with interests in real and personal property in our Trust name. All powers of our Trustees are fully set forth in Article Fourteen of our Trust Agreement.
7. Our Trust has not been revoked and there have been no amendments limiting the powers of our Trustees over trust property.
8. No person or entity paying money to or delivering property to our Trustee shall be required to see to its application. All persons relying on this document regarding our Trustee(s) and their powers over trust property shall be held harmless for any resulting loss or liability from such reliance. A copy of this Certificate of Trust shall be just as valid as the original.

The undersigned certify that the statements in this Certificate of Trust are true and correct and that it was executed in the County of Washoe, Nevada on July 19, 2000.

EXHIBIT A

EXHIBIT A

0496955

Trustors:

Don G. Rose
DON G. ROSE

Betty L. Rose
BETTY L. ROSE

Trustees:

Don G. Rose
DON G. ROSE

Betty L. Rose
BETTY L. ROSE

STATE OF NEVADA)

COUNTY OF WASHOE)

SS

This instrument was acknowledged before me on July 19, 2000 by DON G. ROSE and BETTY L. ROSE, Trustors and Trustees.

Sara Lee Fleischer
Notary Public

My Commission Expires: _____

Prepared by:
Richard P. Schulz
Anderson & Dorn, Ltd.
294 East Moana Lane, Suite B-27
Reno, NV 89502-4634
(775) 823-9455 FAX (775) 823-9456

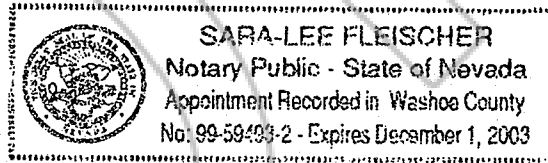

0496955

BK0800PG0163

EXHIBIT "B"
LEGAL DESCRIPTION

APN: ~~21-110-52~~
1358 Downs Drive, Minden, Nevada 89423

Lot 26, Block 4, as shown on the Plat of Mountain View Estates No. 2 recorded October 24, 1979, in Book 1079 of Official Records, at Page 1962, Douglas County, Nevada, as Document No. 38123.

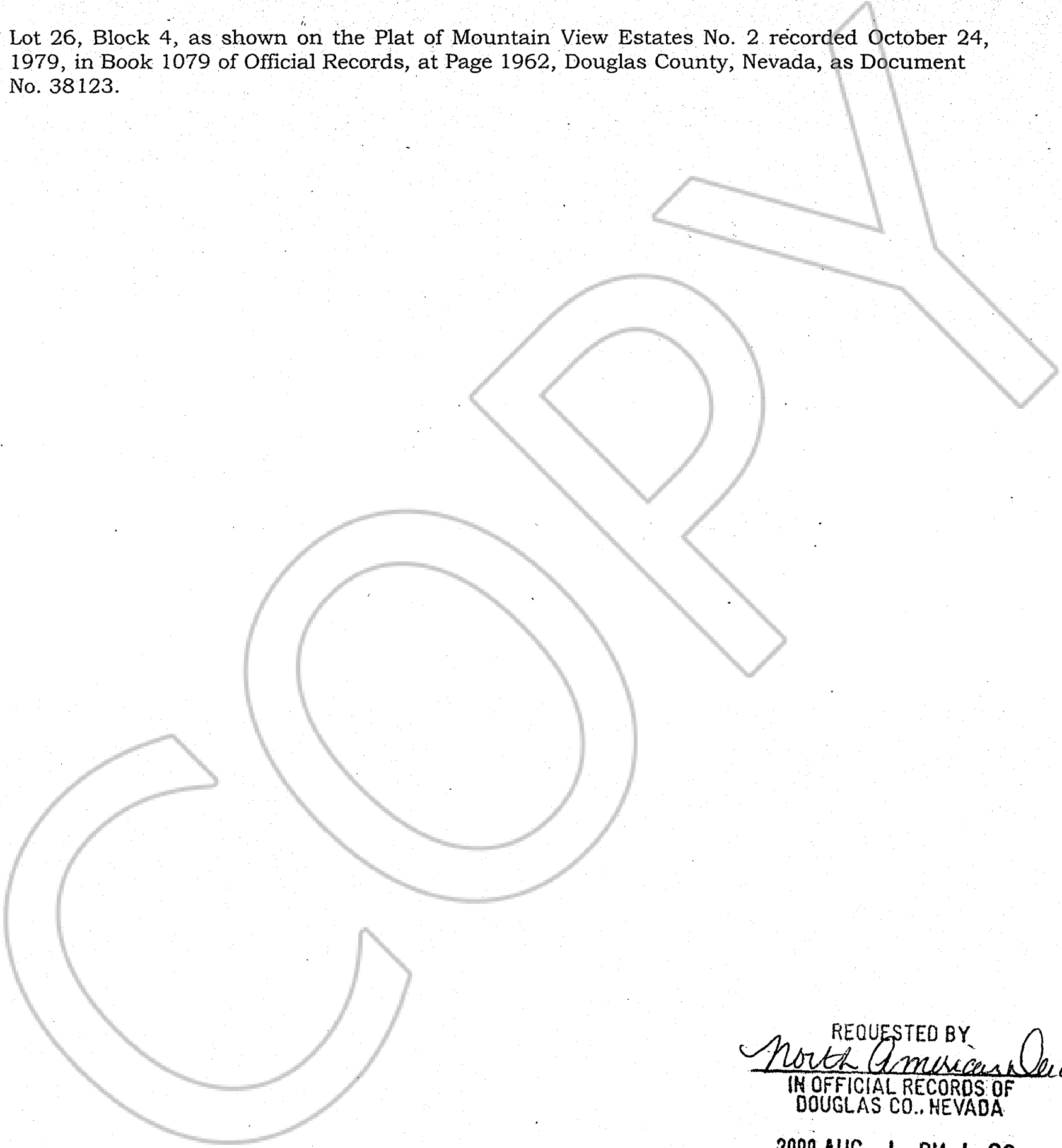

REQUESTED BY
North American Land
IN OFFICIAL RECORDS OF
DOUGLAS CO., NEVADA

2000 AUG -1 PM 1:29

LINDA SLATER
RECORDER

\$10⁰⁰ PAID *BC* DEPUTY

0496955

BK0800PG0164