

GRANT, BARGAIN AND SALE DEED

THIS INDENTURE WITNESSETH: That for a valuable consideration, receipt of which is hereby acknowledged,

RICHARD A. SPAIN, husband of the Grantee herein

do(es) hereby **GRANT, BARGAIN, SELL and CONVEY** to

THERESA SPAIN a married woman as her sole and separate property

all that real property situated in the County of Douglas, State of Nevada, being Assessor's Parcel Number **1220-24-401-008**, specifically described as follows:

SEE EXHIBIT "A" ATTACHED HERETO AND MADE A PART HEREOF FOR LEGAL DESCRIPTION

TOGETHER with all and singular the tenements, hereditaments and appurtenances, including easements and water rights, if any, thereto belonging or in anywise appertaining, and any reversions, remainders, rents, issues of profits thereof.

WITNESS my hand this 28 day of July, 2000

Richard A. Spain
RICHARD A. SPAIN

STATE OF NEVADA
COUNTY OF Douglas

On July 31, 2000 personally appeared before me, a Notary Public,
Richard A. Spain

who acknowledged that he executed the above instrument.

E. Jane Mulcahy
Notary Public

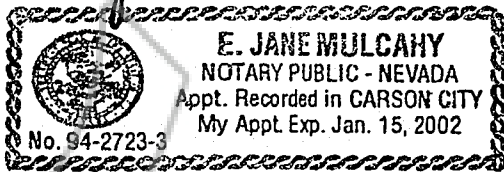

WHEN RECORDED MAIL TO:

Theresa Spain
631 Clydesdale Court
Gardnerville, NV 89410

The grantor (s) declare:
Documentary transfer tax is \$EXEMPT. #6
(X) computed on full value of property conveyed, or
computed on full value less value of liens and
encumbrances remaining at time of sale

MAIL TAX STATEMENTS TO:
SAME AS ABOVE

0496979
BK0800PG0249

EXHIBIT "A"

The land referred to in this report is situate in Douglas, State of Nevada, and is described as follows:

A Parcel of land located with in a portion of the Southwest ¼ of Section 24, Township 12 North, Range 20 East, M.D.B. & M., Douglas County, Nevada, being more particularly described as follows:

Parcel D-1 as shown Parcel Map No. 3 for Don and Francie Lockman, Recorded May 23, 1990, in Book 590, Page 3603, as document No. 226670 of Official Records Douglas County, Nevada, being a resubdivision of Parcel D as shown on the parcel map for Don and Francie Lockman, Recorded December 14, 1989 in Book 1289, Page 1422, as Document 216450 of Official Records Douglas County, Nevada.

Assessor's Parcel No. 1220-24-401-008.

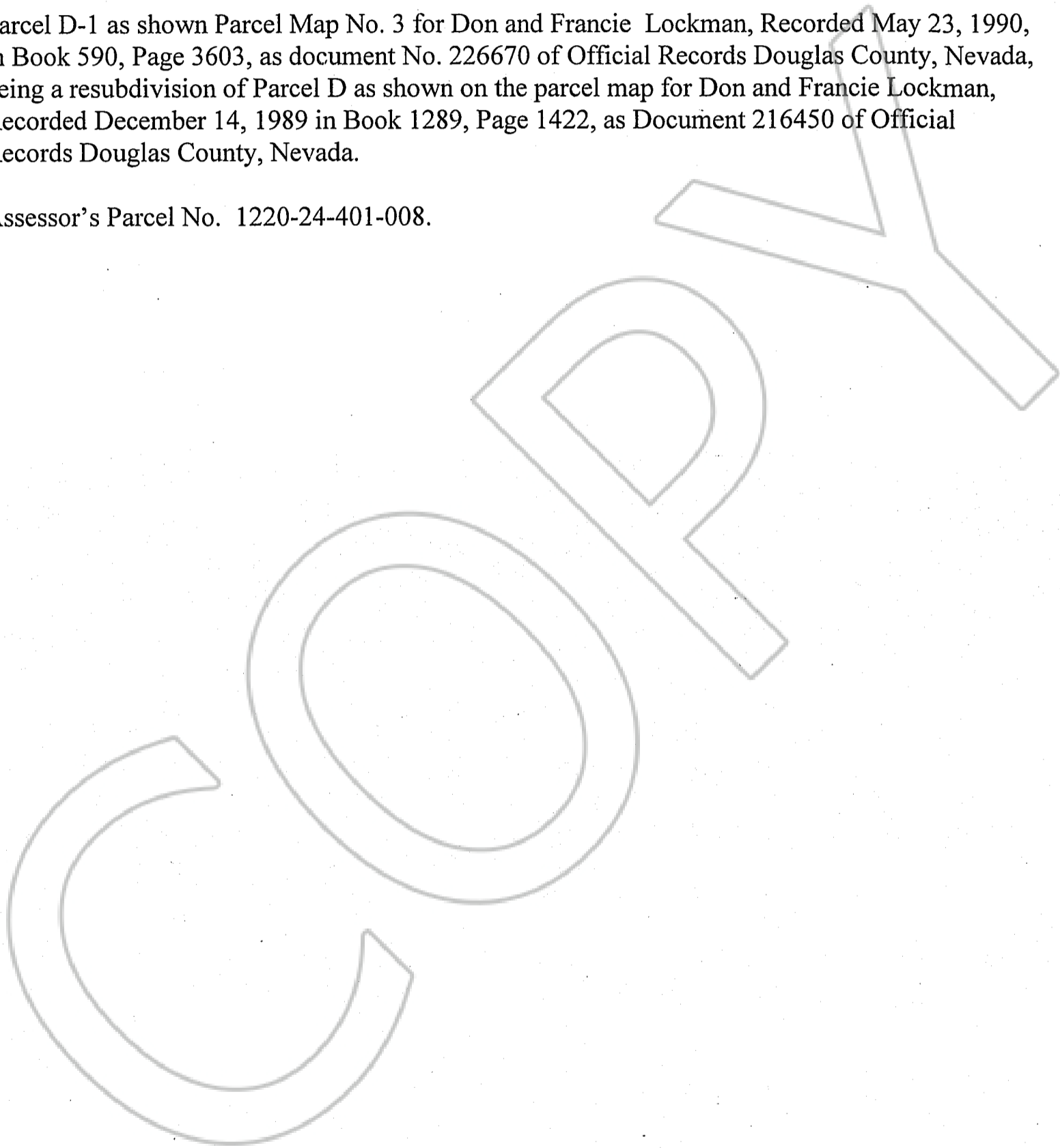

REQUESTED BY
MARQUIS TITLE & ESCROW, INC.
IN OFFICIAL RECORDS OF
DOUGLAS CO., NEVADA

2000 AUG -1 PM 3: 36

LINDA SLATER
RECORDER

\$ *J. Co* PAID *Pa* DEPUTY

0496979

BK0800PG0250