

RECORDING REQUESTED BY  
CHARLES MILTON LONEY  
2338 Channing Way  
Berkeley, CA 94704

✓ Anderson & Drossel  
2041 Bancroft Wx  
Ste 207  
Berkeley CA 94704

AND WHEN RECORDED MAIL TO:

Name [ CHARLES MILTON LONEY  
Street Address [ 2338 Channing Way  
City State Zip [ Berkeley, CA 94704

SPACE ABOVE THIS LINE FOR RECORDER'S USE

**TRUST TRANSFER DEED**

ASSESSORS PARCEL NO. 07-062-200

**Grant Deed (Excluded from Reappraisal Under Proposition 13, i.e., Calif. Const. Art 13A§1 et seq.)**

The undersigned Grantor(s) declare(s) under penalty of perjury that the following is true and correct:

THERE IS NO CONSIDERATION FOR THIS TRANSFER.

Documentary transfer tax is \$ #8 0.00.

Computed on full value of property conveyed, or  Computed on full value less value of liens and encumbrances remaining at time of sale or transfer.

There is no Documentary transfer tax due. (state reason and give Code § or Ordinance number)

GIFT. NOT PURSUANT TO A SALE. NO CONSIDERATION PAID.

Unincorporated area:  City of \_\_\_\_\_ and

This is a Trust Transfer under §62 of the Revenue and Taxation Code and Grantor(s) has (have) checked the applicable exclusion:

Transfer to a revocable trust;

Transfer to a short-term trust not exceeding 12 years with trustor holding the reversion;

Transfer to a trust where the trustor or the trustor's spouse is the sole beneficiary;

Change to trustee holding title;

Transfer from trust to trustor or trustor's spouse where prior transfer to trust was excluded from reappraisal and for a valuable consideration, receipt of which is acknowledged.

Other:

GRANTOR(S): MILTON LONEY

hereby GRANT(S) to CHARLES MILTON LONEY, AS TRUSTEE OF THE LONEY FAMILY TRUST,

the following described real property in the County of DOUGLAS, State of ~~California~~ NEVADA

(SEE ATTACHED LEGAL DESCRIPTION)

(LAKE VILLAGE UNIT NO.1 property)

Dated 8/11/02  
State of California

County of \_\_\_\_\_

On \_\_\_\_\_

before me,

personally appeared

personally known to me (or proved to me on the basis of satisfactory evidence) to be the person(s) whose name(s) is/are subscribed to the within instrument and acknowledged to me that he/she/they executed the same in his/her/their authorized capacity(ies), and that by his/her/their signature(s) on the instrument the person(s), or the entity upon behalf of which the person(s) acted, executed the instrument.

WITNESS my hand and official seal.

(SEE ATTACHED CERTIFICATE)

Signature \_\_\_\_\_

*Milton Loney*  
MILTON LONEY

Grantor - Transferor(s)

Title Order No. \_\_\_\_\_

Escrow, Loan or Attorney File No. \_\_\_\_\_

MAIL TAX STATEMENTS TO: CHARLES MILTON LONEY (SAME AS ABOVE)

NAME

ADDRESS

CITY, STATE, ZIP

**CALIFORNIA ALL-PURPOSE ACKNOWLEDGMENT**

State of California

County of ALAMEDA

} ss.

On 11 AUGUST 2000, before me, ELIZABETH C. RUBIN, NOTARY PUBLIC,  
Date Name and Title of Officer (e.g., "Jane Doe, Notary Public")

personally appeared CHARLES MILTON LONEY \*\*\*\*\*,  
Name(s) of Signer(s)

personally known to me  
 proved to me on the basis of satisfactory evidence

to be the person(s) whose name(s) is/~~are~~ subscribed to the within instrument and acknowledged to me that he/~~she/they~~ executed the same in his/~~her/their~~ authorized capacity(ies), and that by his/~~her/their~~ signature(s) on the instrument the person(s), or the entity upon behalf of which the person(s) acted, executed the instrument.

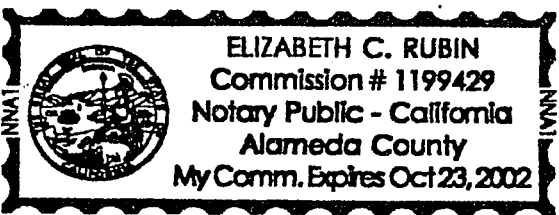

WITNESS my hand and official seal.  
Elizabeth C. Rubin  
Signature of Notary Public

Place Notary Seal Above

**OPTIONAL**

*Though the information below is not required by law, it may prove valuable to persons relying on the document and could prevent fraudulent removal and reattachment of this form to another document.*

**Description of Attached Document**

Title or Type of Document: TRUST TRANSFER DEED-Lake Village, Minden NV

Document Date: 11 AUGUST 2000 Number of Pages: ONE + ATTACH

Signer(s) Other Than Named Above: N/A

**Capacity(ies) Claimed by Signer**

Signer's Name: CHARLES MILTON LONEY

- Individual
- Corporate Officer — Title(s): \_\_\_\_\_
- Partner —  Limited  General
- Attorney in Fact
- Trustee
- Guardian or Conservator
- Other: \_\_\_\_\_

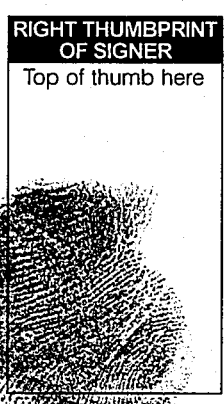

Signer Is Representing: SELF

0497803

BK0800P63004

LEGAL DESCRIPTION

Property located at:

LAKE VILLAGE UNIT NO. 1  
COUNTY OF DOUGLAS, STATE OF NEVADA  
MINDEN, NEVADA

All that certain lot, piece or parcel of land situated in the County of Douglas, State of Nevada, described as follows:

Lot 20, Block B, as shown on the official AMENDED MAP OF LAKE VILLAGE UNIT NO. 1, recorded in the office of the County Recorder of Douglas County, State of Nevada, on June 29, 1970, in Book 1 of Maps as document No. 48473, Official Records of Douglas County, Nevada.

AP #07-062-200

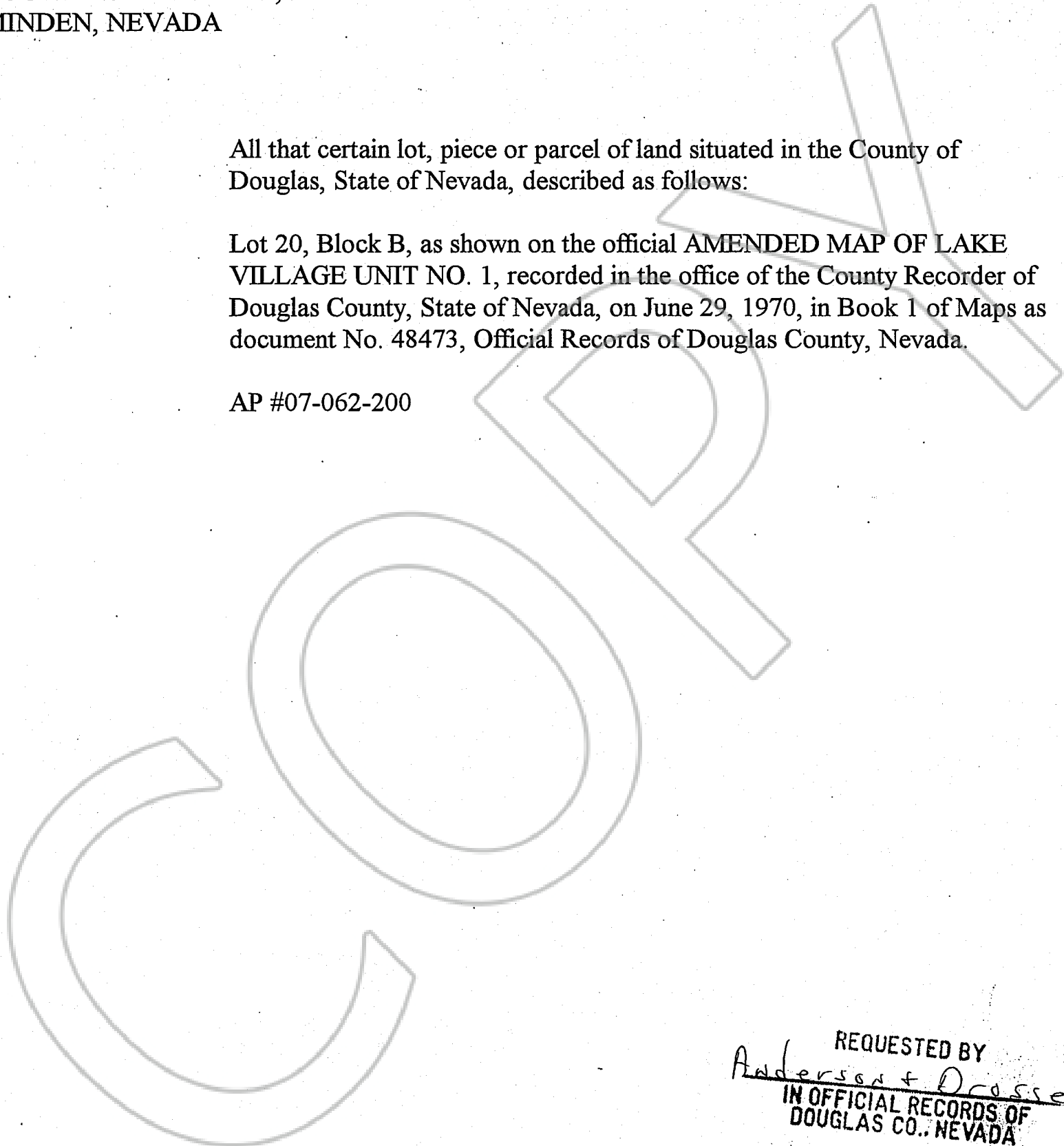

REQUESTED BY  
*Anderson + Drassel*  
IN OFFICIAL RECORDS OF  
DOUGLAS CO., NEVADA

2000 AUG 16 PM 2: 16

LINDA SLATER  
RECORDER

\$ *9.00* PAID *KG* DEPUTY

0497803

BK0800PG3005