

RECORDING REQUESTED BY:
STEWART TITLE COMPANY
WHEN RECORDED MAIL TO:
MAIL TAX STATEMENTS TO:
MR. AND MRS. VINCENT WEAVER
P. O. BOX 914
GARDNERVILLE, NV 89410

ESCROW NO. 000701771
R.P.T.T. \$ 172.90
A.P.N. # 1220-11-001-011
Full Value

CORPORATION
GRANT, BARGAIN, SALE DEED

THIS INDENTURE WITNESSETH: That
BANC ONE FINANCIAL SERVICES, INC.

in consideration of \$10.00, the receipt of which is hereby acknowledged, does hereby Grant, Bargain Sell and Convey to
VINCENT WEAVER and DAYLEEN WEAVER, husband and wife as joint tenants

and to the heirs and assigns of such Grantee forever, all that real property situated in the **unincorporated area**
County of **DOUGLAS** State of Nevada, bounded and described as follows:
SEE EXHIBIT "A" ATTACHED HERETO AND MADE A PART HEREOF

Together with all and singular the tenements, hereditaments and appurtenances thereunto belonging or in anywise appertaining, and any reversions, remainders, rents, issues or profits thereof.

DATE: **August 28, 2000** **BANC ONE FINANCIAL SERVICES, INC.**

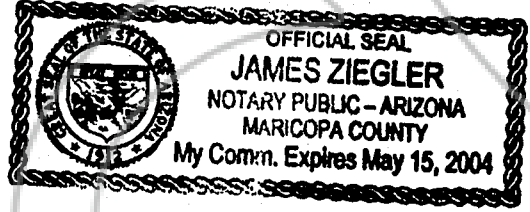

BY: Sheryl DeRonde
BY: Sheryl DeRonde
AUTHORIZED OFFICER
BY: James Ziegler
JAMES ZIEGLER, NOTARY PUBLIC

STATE OF Arizona }
Nevada }
COUNTY OF MARICOPA } ss.
Douglas }

This instrument was acknowledged before me on 8/29/00
by, BY: Sheryl DeRonde

Signature signature above
Notary Public

0498579
BK0800PG5651

EXHIBIT "A"

LEGAL DESCRIPTION

ESCROW NO.: 000701771

All that certain lot, piece or parcel of land situate in the Southeast 1/4 of the Northeast 1/4 Section 11, Township 12 North, Range 20 East, M.D.B.&M., Douglas County, Nevada, further described as follows:

Parcel 2, as set forth on the Parcel Map of STODDARD JACOBSEN Parcels, filed for record in the office of the County Recorder, Douglas County, State of Nevada, on February 12, 1975, in Book 275, Page 331, as Document No. 78188.

Assessors Parcel No. 1220-11-001-011

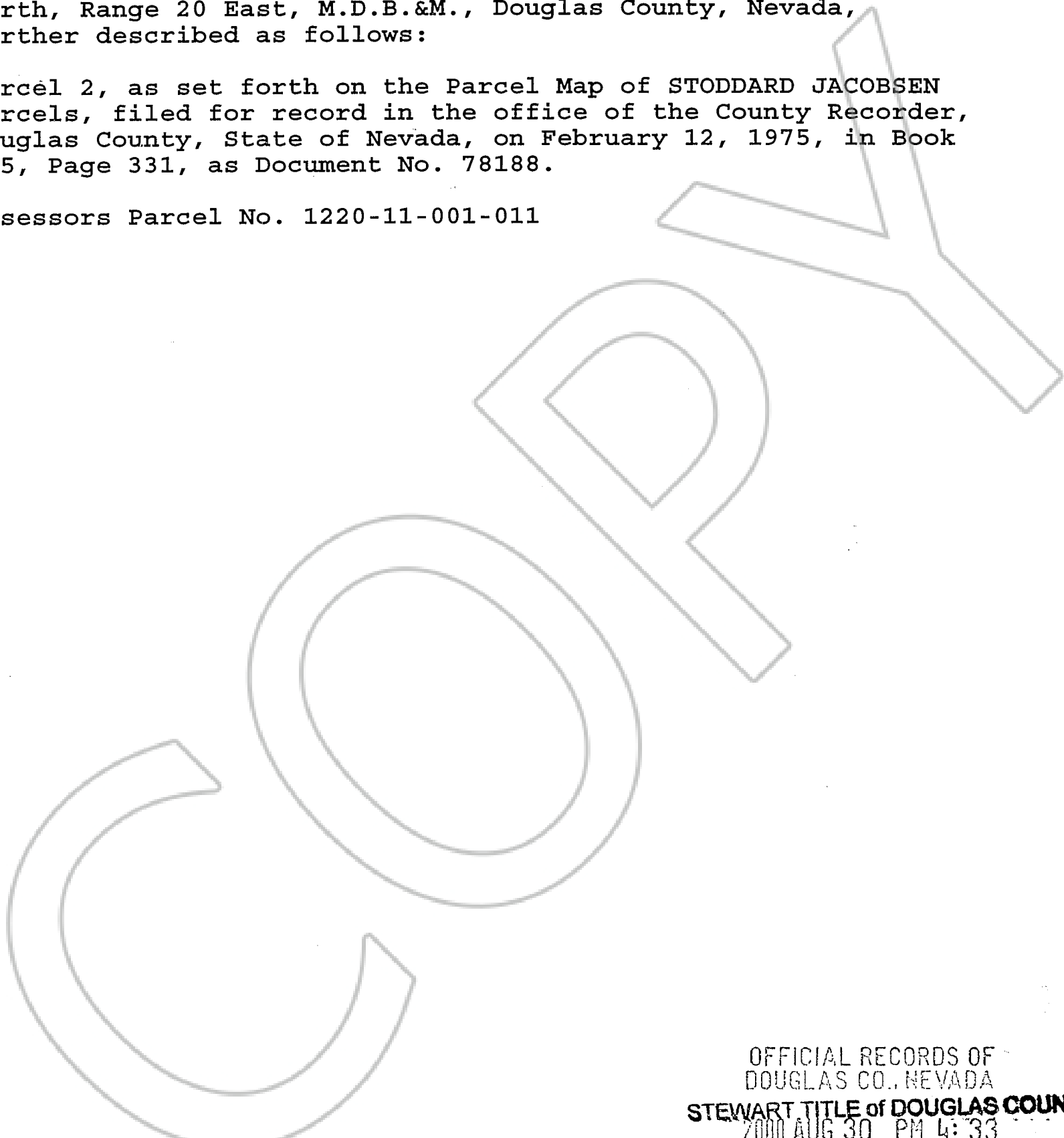

OFFICIAL RECORDS OF
DOUGLAS CO., NEVADA
STEWART TITLE of DOUGLAS COUNTY
2000 AUG 30 PM 4:33

LINDA SLATER, RECORDER

BY *LS* \$8.00

0498579

BK0800PG5652