

✓ Brooke + Shaw

PO Box 2860

Minden NV 89423

R.P.T.T. #8

When Recorded, Mail to:
and Mail Tax Statements to:

Thomas M. Thomure
Alice E. Thomure
2666 Stewart
Minden, Nevada 89423

A.P.N. 1420-34-310-035
(old A.P.N. 21-193-130)

INDIVIDUAL GRANT DEED

THIS INDENTURE WITNESSETH: That for a valuable consideration, receipt of which is hereby acknowledged, Thomas M. Thomure and Alice E. Thomure, Husband and Wife as Joint Tenants, Grantors, do hereby grant, bargain, sell, and convey to Thomas M. Thomure and Alice E. Thomure, Trustees of the Thomas M. Thomure Family Trust, of 2666 Stewart Avenue, Minden, Nevada, Grantees, as their sole and separate property, all that real property in the County of Douglas, State of Nevada, being Assessor's Parcel Number 1420-34-310-035, and specifically described as:

See "Exhibit A" attached hereto and made a part hereof.

Together with all and singular the tenements, hereditaments and appurtenances thereunto belonging or in anywise appertaining, and any reversions, remainders, rents, issues or profits thereof.

Witness our hands this 2nd day of August, 2000.

Thomas M. Thomure

THOMAS M. THOMURE

Alice E. Thomure

ALICE E. THOMURE

///

///

STATE OF NEVADA)
) ss.
COUNTY OF DOUGLAS)

On Aug. 22, 2000, before me, a notary public, personally appeared Thomas M. Thomure, personally known or proved to me to be the person whose name is subscribed to the above instrument who acknowledged that he executed the instrument.

Dorothy J. Muriset
Notary Public



STATE OF NEVADA)
) ss.
COUNTY OF DOUGLAS)

On Aug. 22, 2000, before me, a notary public, personally appeared Alice E. Thomure, personally known or proved to me to be the person whose name is subscribed to the above instrument who acknowledged that she executed the instrument.

Dorothy J. Muriset
Notary Public

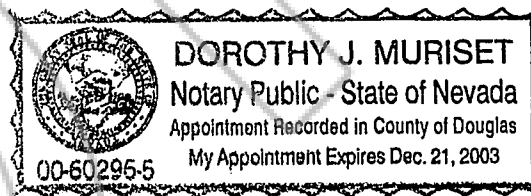
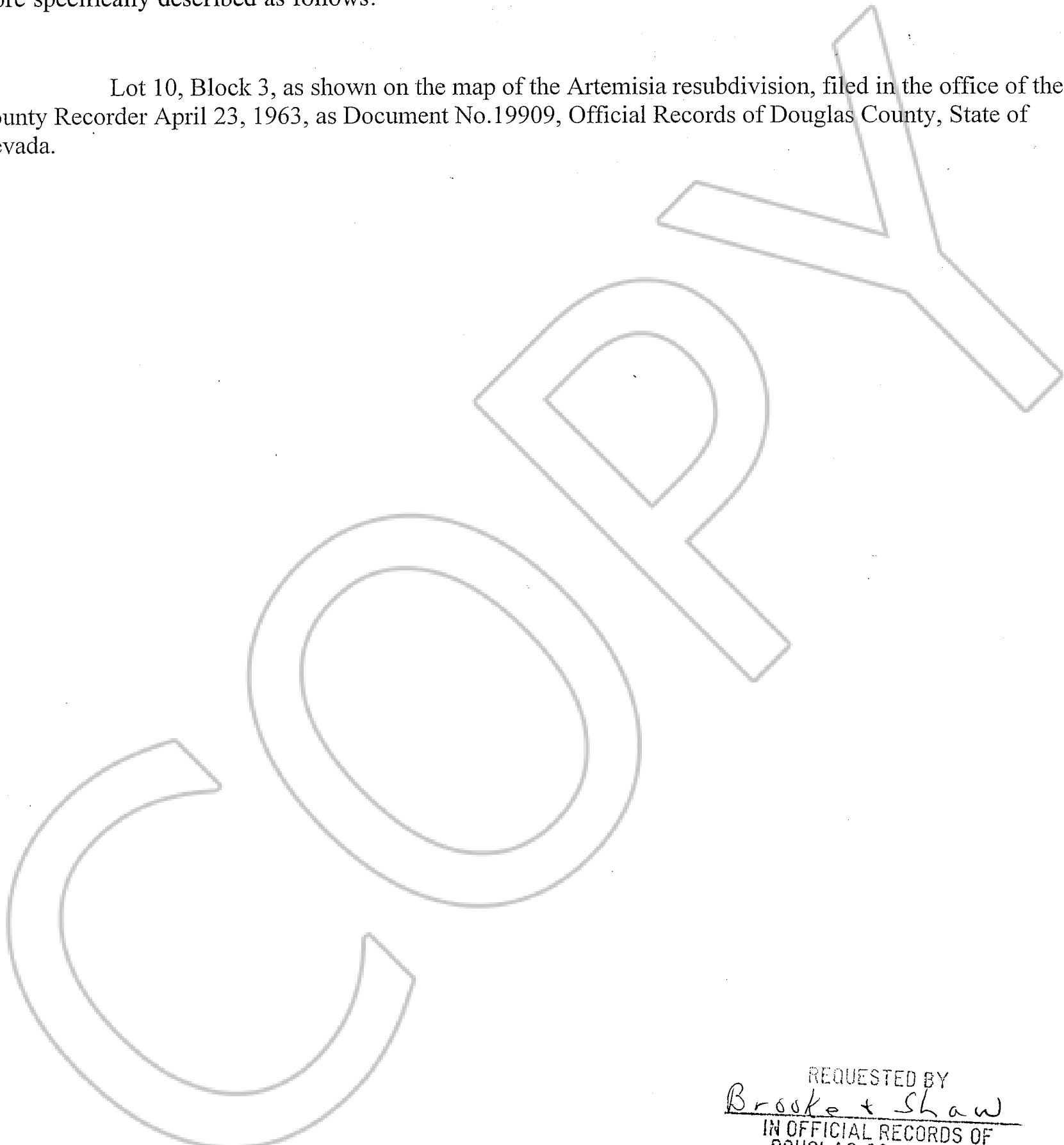

EXHIBIT A

All that real property, being Assessor's Parcel Number 1420-34-310-035, located in Book No. 392, Page No.375 as Document No. 0272477 in the Official Records of Douglas County, State of Nevada more specifically described as follows:

Lot 10, Block 3, as shown on the map of the Artemisia resubdivision, filed in the office of the County Recorder April 23, 1963, as Document No.19909, Official Records of Douglas County, State of Nevada.



REQUESTED BY
Brooke + Shaw
IN OFFICIAL RECORDS OF
DOUGLAS CO., NEVADA

2000 SEP -5 PM 2:29

LINDA SLATER
RECORDER

\$ 9.00 PAID KJ DEPUTY

0498867

BK0900PG0506