

RECORDING REQUESTED BY:  
**STEWART TITLE COMPANY**

WHEN RECORDED MAIL TO:

MAIL TAX STATEMENTS TO:

**JACK PARISO**  
**1968 MARCONI WAY**  
**SOUTH LAKE TAHOE, CA 96150**

ESCROW NO. 000201202

R.P.T.T. \$ .00 #6 SPOUSAL DEED

A.P.N. # 41-150-010

### GRANT, BARGAIN, SALE DEED

THIS INDENTURE WITNESSETH: That **SHERRY PARISO, SPOUSE OF THE HEREIN GRANTEE**

in consideration of \$10.00, the receipt of which is hereby acknowledged, does hereby Grant, Bargain Sell and Convey to **JACK PARISO, A MARRIED MAN AS HIS SOLE AND SEPARATE PROPERTY WHO ACQUIRED TITLE AS A SINGLE MAN**

and to the heirs and assigns of such Grantee forever, all that real property situated in the County of \_\_\_\_\_ State of Nevada, bounded and described as follows:

See Exhibit "A" attached hereto and by reference made a part hereof for complete legal description.

IT IS THE EXPRESS INTENT OF THE GRANTOR, BEING THE SPOUSE OF THE GRANTEE, TO CONVEY ALL RIGHT, TITLE AND INTEREST OF THE GRANTOR, COMMUNITY OR OTHERWISE, IN AND TO THE HEREIN DESCRIBED PROPERTY TO THE GRANTEE AS GRANTEE'S SOLE AND SEPARATE PROPERTY.

Together with all and singular the tenements, hereditaments and appurtenances thereunto belonging or in anywise appertaining, and any reversions, remainders, rents, issues or profits thereof.

DATE: August 11, 2000

**CLAIRE H. LIPPELT**  
Notary Public - Notary Seal  
STATE OF MISSOURI  
Commissioned in Jackson County  
My Commission Expires: 4-25-2004

*Sherry Pariso*  
SHERRY PARISO

STATE OF Missouri }  
                                  } ss.  
COUNTY OF Jackson }

This instrument was acknowledged before me on 8-15-2000,  
by, Sherry Pariso

Signature Claire H. Lippelt  
Notary Public

0499356

BK0900PG2180

LEGAL DESCRIPTION

The land referred to herein is situated in the State of Nevada,  
County of Douglas, described as follows:

Unit A, as set forth on the Condominium Map of Lot 10 of Second  
Amended Map of Tahoe Village Unit No. 2, recorded February 2,  
1979, as Document No. 29640, Official Records of Douglas  
County, State of Nevada.

Assessors Parcel No. 41-150-010

TOGETHER WITH an undivided 1/8th interest in and to that  
portion designated as Common Area as set forth on the  
Condominium Map of Lot 10 of Second Amended Map of Tahoe  
Village No. 2, recorded February 2, 1979 as Document No. 29640,  
Official Records of Douglas County, State of Nevada.

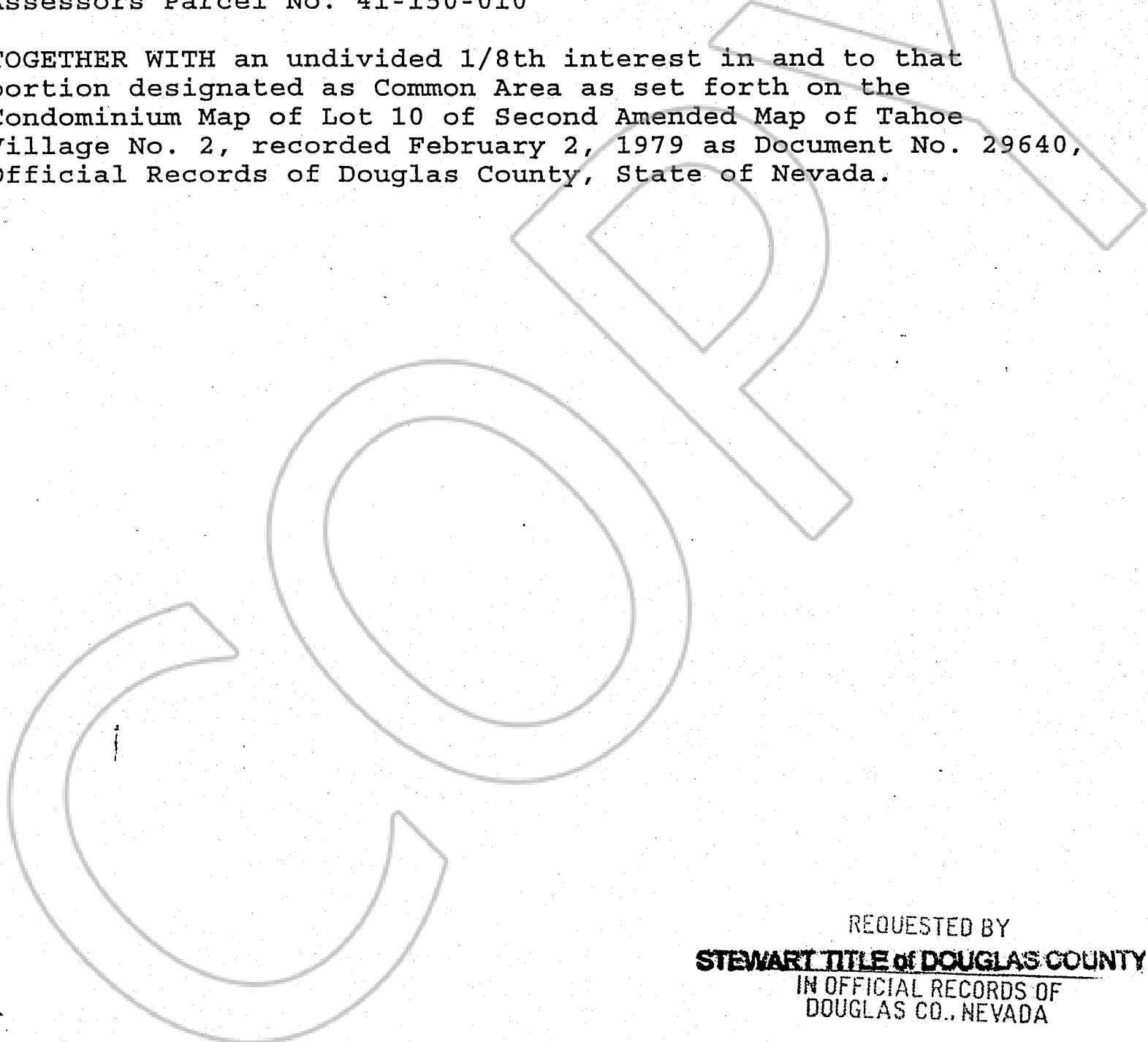

REQUESTED BY  
**STEWART TITLE of DOUGLAS COUNTY**  
IN OFFICIAL RECORDS OF  
DOUGLAS CO., NEVADA

2000 SEP 14 PM 3: 07

LINDA SLATER  
RECORDER

\$ 8<sup>00</sup> PAID Kg DEPUTY

0499356  
BK0900PG2181