

EXHIBIT A

DESCRIPTION

All that certain lot, piece or parcel of land situate in the County of Douglas, State of Nevada, described as follows:

The Southeast $\frac{1}{4}$ of the Northeast $\frac{1}{4}$ of the Southwest $\frac{1}{4}$ of Northeast $\frac{1}{4}$, AND the Southwest $\frac{1}{4}$ of the Northwest $\frac{1}{4}$ of the Southeast $\frac{1}{4}$ of the Northeast $\frac{1}{4}$ of Section 6, Township 14 North, Range 20 East, M.D.B.&M.

EXCEPTING therefrom any portion lying within the boundaries of U.S. Highway 395.

Said lands are set forth on Record of Survey recorded February 26, 1998 in Book 298 of Official Records at Page 4977, Douglas County, Nevada, as Document No. 433544, and Record of Survey recorded April 10, 2000, in Book 0400 of Official Records at Page 1314, Douglas County, Nevada, as Document No. 489613

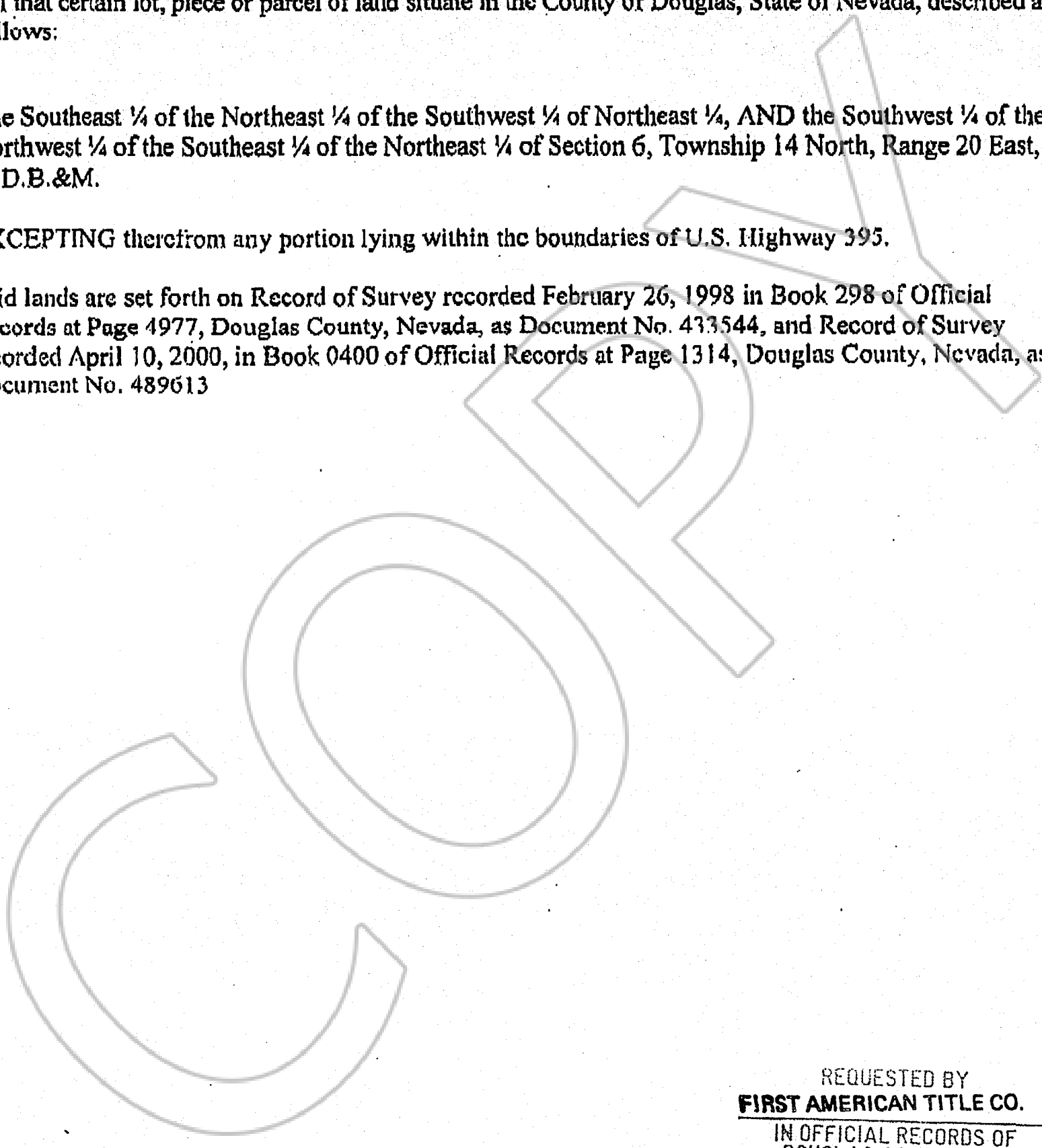

REQUESTED BY
FIRST AMERICAN TITLE CO.
IN OFFICIAL RECORDS OF
DOUGLAS CO., NEVADA

2000 SEP 19 AM 11:28

LINDA SLATER
RECORDER

\$ 8⁰⁰ PAID *kg* DEPUTY

0499615

BK0900PG3129