

EXHIBIT "A"

LEGAL DESCRIPTION

ESCROW NO.: 000801432

Lots 7 & 8, in Block K, as shown on the map of TOWN OF MINDEN,
filed in the Office of the County Recorder of Douglas County,
Nevada, on July 2, 1906, as Document No. 20840.

Assessors Parcel No. 1320-32-111-061

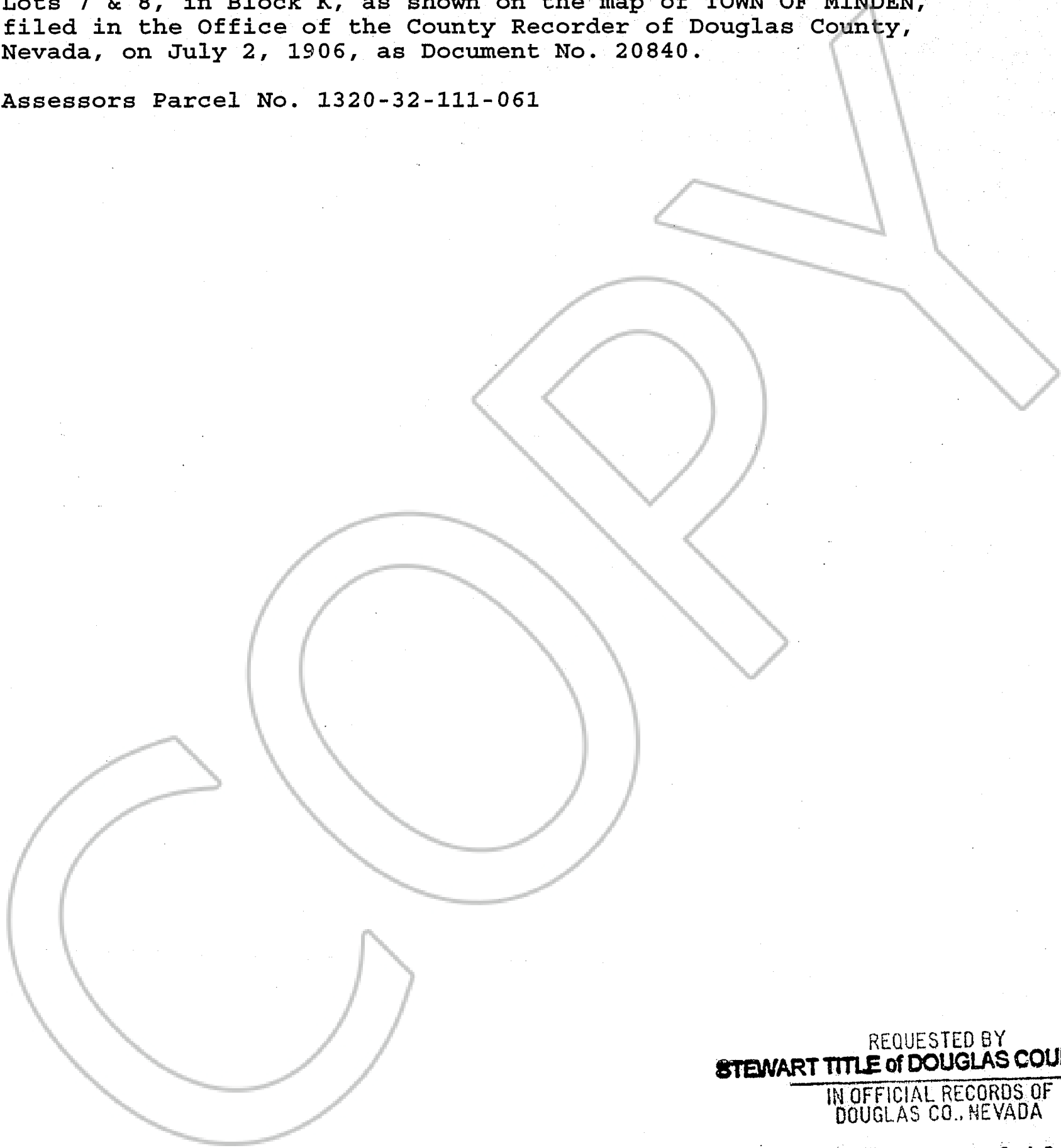

REQUESTED BY
STEWART TITLE of DOUGLAS COUNTY
IN OFFICIAL RECORDS OF
DOUGLAS CO., NEVADA

2000 OCT -6 PM 3:42

LINDA SLATER
RECORDER

\$ 800 PAID BC DEPUTY

0500968
BK 1000 PG 1277