

ASSIGNMENT OF DEED OF TRUST

APN 1220-01-001-030

FOR VALUE RECEIVED, the undersigned hereby grants, assigns and transfers to FLOYD GORDON HENSMAN AND PHYLLIS JEAN HENSMAN, HUSBAND AND WIFE AS JOINT TENANTS

all beneficial interest under that certain Deed of Trust dated JANUARY 19, 2000
executed by SHANE S. TALBOT AND ROBERTA C. TALBOT, HUSBAND AND WIFE
Trustor, to WESTERN TITLE COMPANY, A NEVADA CORPORATION
Trustee,

and recorded as Instrument No.485077, on JANUARY 26, 2000, in
Book 0100, Page 3902, of Official Records in the County Recorder's office of
DOUGLAS County, Nevada, describing land therein as:

SEE DESCRIPTION SHEET ATTACHED HERETO AND MADE A PART HEREOF TO BE READ AND APPROVED

TOGETHER with the note or notes therein described or referred to, the money due and to become due thereon with interest, and all rights accrued or to accrue under said Deed of Trust.

Dated: OCTOBER 31, 2000

STATE OF NEVADA

COUNTY OF DOUGLAS

} s. MOLINE BUILDERS, INC.
S DAVID N. MOLINE, PRESIDENT

This instrument was acknowledged before me on

OCTOBER 31, 2000

by DAVID N. MOLINE PRESIDENT OF
MOLINE BUILDERS, INC.

Carol Costa
Notary Public

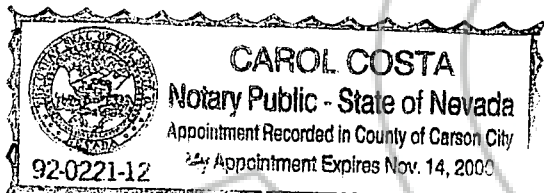

SPACE BELOW THIS LINE FOR RECORDER'S USE

(This area for official notarial seal)

RECORDING REQUESTED BY
Western Title Company, Inc.
AND WHEN RECORDED MAIL TO

Name **WESTERN TITLE COMPANY**
Street **IC DEPT IC NO. 2505**
Address **1626 HIGHWAY 395**
City, State **MINDEN, NEVADA**
Zip

Order No. **00083783-201-CAC**

0502588

BK 1100P60091

Legal Description

All that real property situate in the County of Douglas, State of Nevada, described as follows:

Being within the Northeasterly 1/4 of Section 1, Township 12 North, Range 20 East, M.D.M. Douglas County, Nevada and being further described as follows:

Parcel A-1 of Parcel Map #2038 for MOLINE BUILDERS, INC., a redivision of Parcel A of Parcel Map #2032 for MOLINE BUILDERS, INC., filed for record May 15, 1997, in Book 597, Page 2441, as Document No. 412571, of official records of Douglas County Recorders Office, Minden, Nevada.

Assessor's Parcel Number: 1220-01-001-030

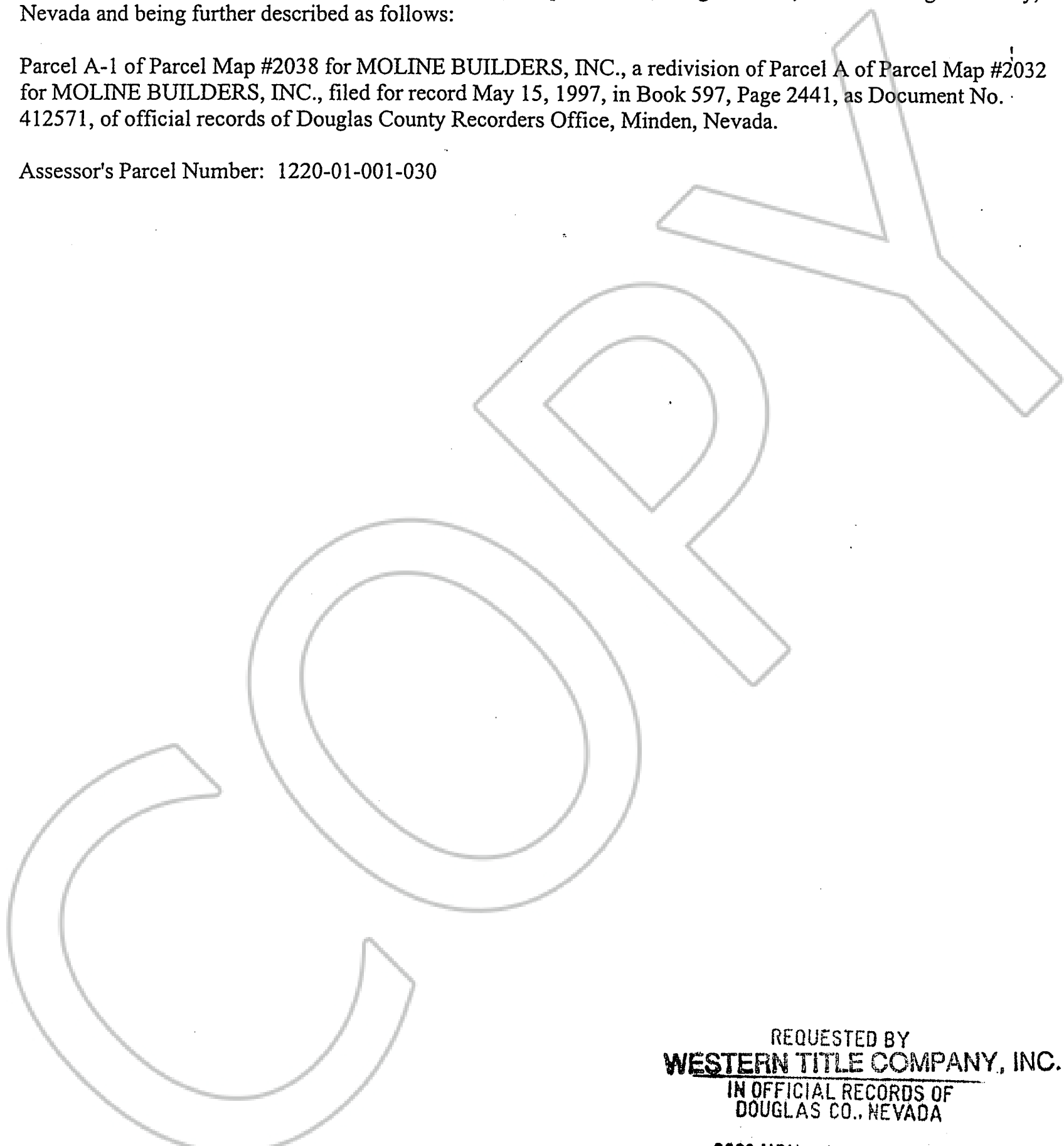

REQUESTED BY
WESTERN TITLE COMPANY, INC.
IN OFFICIAL RECORDS OF
DOUGLAS CO., NEVADA

2000 NOV -1 PM 12: 46

LINDA SLATER
RECORDER

\$ *8.00* PAID *LJ* DEPUTY

0502588
BK 1100PG0092