

Recorded at the request of Community Development  
Rtn to Attn of: Dennis Little

### CERTIFICATE OF AMENDMENT

To: Eric Teitelman, P.E.  
County Engineer  
DOUGLAS COUNTY  
P.O. Box 218  
Minden, NV 89423

This is to amend that certain Parcel Map for Herbig Properties Limited filed for record September 14, 1999 in Book 999, at Page 2558, as Document No. 476559.

The amendments are as follows:

1. The curve data for a portion of the easterly right-of-way of Waterloo Lane of  $\Delta = 24^\circ 49' 07''$ ,  $R = 892.50'$ ,  $L = 386.60'$ ,  $T = 196.38'$  should be corrected to read  $\Delta = 24^\circ 41' 39''$ ,  $R = 892.50'$ ,  $L = 384.66'$ ,  $T = 195.36'$ .

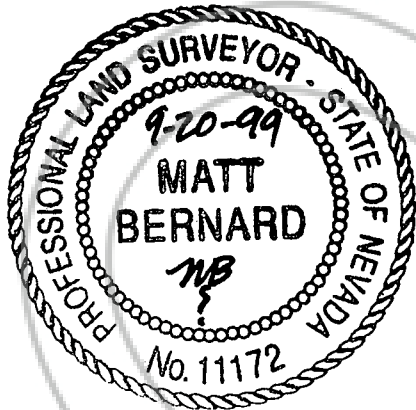

Matt Bernard  
Matt Bernard, P.L.S. 11172

9-20-99  
Date

I hereby certify that I have examined the certificate of amendment and that the changes to the original document specified therein are provided for in applicable sections of NRS 278.010 to 278.630, inclusive, NRS 625.340 to 625.380, inclusive, and local ordinances adopted pursuant thereto, and I am satisfied this certificate of amendment so amends the document as to make it technically correct.

[Signature]  
Eric M. Teitelman, P.E.  
DOUGLAS COUNTY ENGINEER

10/19/00  
Date

0502690

BK 1100PG0468

COPY

REQUESTED BY  
*Anderson Engineering*  
IN OFFICIAL RECORDS OF  
DOUGLAS CO., NEVADA

2000 NOV -3 AM 10: 05

LINDA SLATER  
RECORDER

\$ *8.00* PAID *R* DEPUTY

0502690

BK 1100P60469