

After Recording Return To:

**PEELLE MANAGEMENT CORPORATION**  
ASSIGNMENT JOB #90603  
P.O. BOX 1710  
CAMPBELL, CA 95009-1710  
1-408-866-6868

**CAPITOL COMMERCE MORTGAGE CO.**  
P O BOX 276477  
SACRAMENTO, CA 95827-6477

LOAN NO: **75477**  
APN# **1220-20-001-063**

SPACE ABOVE THIS LINE FOR RECORDER'S USE

*L 1986947*  
*27005*  
*R4449*

**ASSIGNMENT OF DEED OF TRUST**

**CAPITOL COMMERCE MORTGAGE CO., A CALIFORNIA CORPORATION**  
Beneficiary under that certain Deed of Trust dated: **APRIL 24, 2000**

, executed by

**ANTHONY DIRITO, AN UNMARRIED MAN**

and recorded **MAY 5, 2000**, as Instrument No. **0491455** in Book **0500**,  
Page ~~1509~~ **1502**, Official Records of **DOUGLAS** County,  
**NEVADA**

, given to secure payment of the Promissory Note therein described or referred to and  
the money due and to become due thereon with interest, has ENDORSED said Note and does hereby ASSIGN, SELL,  
CONVEY, AND DELIVER to:

**BANKERS TRUST COMPANY AS TRUSTEE**  
**3 Park Plaza, Sixteenth Floor, Irvine, California 92714**

all right, title and interest in said Note and all rights accrued or to accrue under said Deed of Trust.

IN WITNESS WHEREOF, said corporation has executed these presents by its officer thereunto duly authorized.

Dated: **MAY 26, 2000**

**CAPITOL COMMERCE MORTGAGE CO., A CALIFORNIA CORPORATION**

By:

**CINDY ESTES**  
**ASSISTANT SECRETARY**

STATE OF **NEVADA** )  
 ) SS  
COUNTY OF **WASHOE** )

On **MAY 26, 2000** before me, **MORGAN CUMMINGS**

Notary Public, personally appeared **CINDY ESTES**  
personally known to me (or proved to me on the basis of satisfactory evidence) to be the person(s) whose name(s) is/are  
subscribed to the within instrument and acknowledged to me that he/she/they executed the same in his/her/their authorized  
capacity(ies), and that by his/her/their signature(s) on the instrument the person(s), or the entity upon behalf of which the  
person(s) acted, executed the instrument.

WITNESS my hand and official seal.

Signature \_\_\_\_\_ (Seal)

**MORGAN CUMMINGS**



(This area for official notarial seal)

**0502941**

**BK 1100PG 1331**

Legal Description

All that real property situate in the County of Douglas, State of Nevada, described as follows:

Lot 35, in Block F, of MARRON ESTATES, according to the map thereof, filed in the office of the County Recorder of Douglas County, State of Nevada, on September 9, 1980, in Book 980, Page 682, as Document No. 48330 of Official Records.

A.P.N. 1220-20-001-063

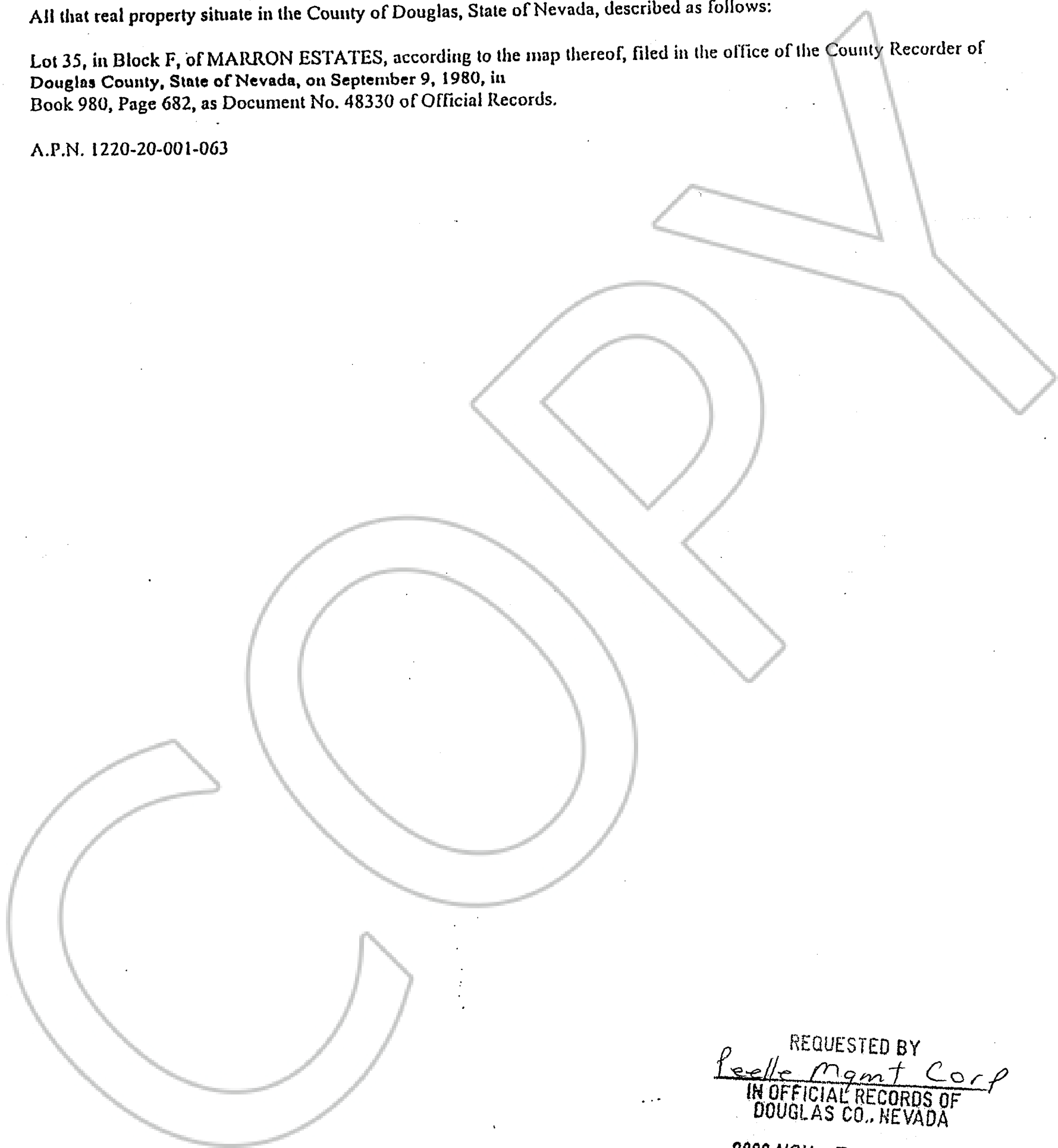

REQUESTED BY  
*Peele Mgmt Corp*  
IN OFFICIAL RECORDS OF  
DOUGLAS CO., NEVADA

2000 NOV -7 AM 8:44

LINDA SLATER  
RECORDER

\$ *8.00* PAID *KJ* DEPUTY

0502941

BK 1100PG 1332