

RECORDING REQUESTED BY:

Fidelity National Title Company

Escrow No. 57545-LMR

Title Order No. 2000-33698

**When Recorded Mail Document
and Tax Statement To:**

Ms. Carol A. Grycko

304 Hibiscus Drive

Honolulu, HI 96815

2000-33698-T02

APN: 42-020-170

GRANT DEED

SPACE ABOVE THIS LINE FOR RECORDER'S USE

The undersigned grantor(s) declare(s)

Documentary transfer tax is \$ City tax \$ 132.60

[X] computed on full value of property conveyed, or

[] computed on full value less value of liens or encumbrances remaining at time of sale,

[] Unincorporated Area City of Stateline

FOR A VALUABLE CONSIDERATION, receipt of which is hereby acknowledged, Joseph Sherwin & Patti A. Reo-Sherwin, Trustees or their successors in trust, under the "Gray Eagle Living Trust", dated June 19, 2000

hereby **GRANT(S)** to Carol A. Grycko, An Unmarried Woman

the following described real property in ~~the City of~~ Stateline
County of Douglas, State of Nevada:

SEE EXHIBIT "A" ATTACHED HERETO AND MADE A PART HEREOF

DATED: October 23, 2000

STATE OF CALIFORNIA

COUNTY OF EL DORADO

ON 10-23-2000 before me,

Lila M Rohrich personally appeared

Joseph Sherwin

personally known to me (or proved to me on the basis of satisfactory evidence) to be the person(s) whose name(s) is/are subscribed to the within instrument and acknowledged to me that he/she/they executed the same in his/her/their authorized capacity(ies), and that by his/her/their signature(s) on the instrument the person(s), or the entity upon behalf of which the person(s) acted, executed the instrument.

Witness my hand and official seal.

Signature

Lila M Rohrich

Joseph Sherwin & Patti A. Reo-Sherwin, Trustees or their successors in trust, under the "Gray Eagle Living Trust", dated June 19, 2000

By: Joseph Sherwin

Joseph Sherwin, Trustee

By: Patti A Reo-Sherwin

Patti A. Reo-Sherwin, Trustee

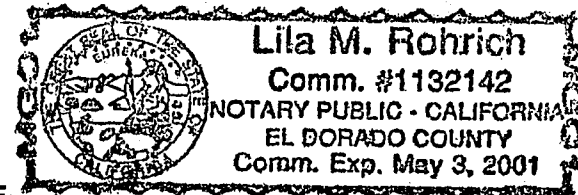
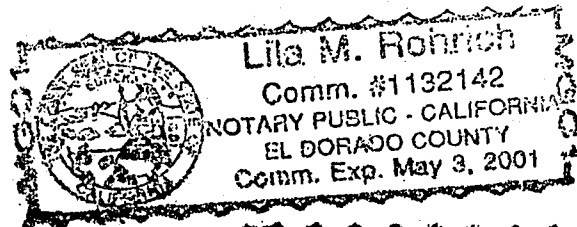

MAIL TAX STATEMENTS AS DIRECTED ABOVE

EXHIBIT "A"
DESCRIPTION

All that certain lot, piece or parcel of land situate in the County of Douglas, State of Nevada, described as follows:

All that certain lot, piece of parcel of land situate in the County of Douglas, State of Nevada described as follows:

Lot 9C, as shown on the SECOND AMENDED MAP of TAHOE VILLAGE NO. 3, recorded in the Office of the County Recorder, Douglas County, Nevada on November 29, 1977 as Document No. 15433.

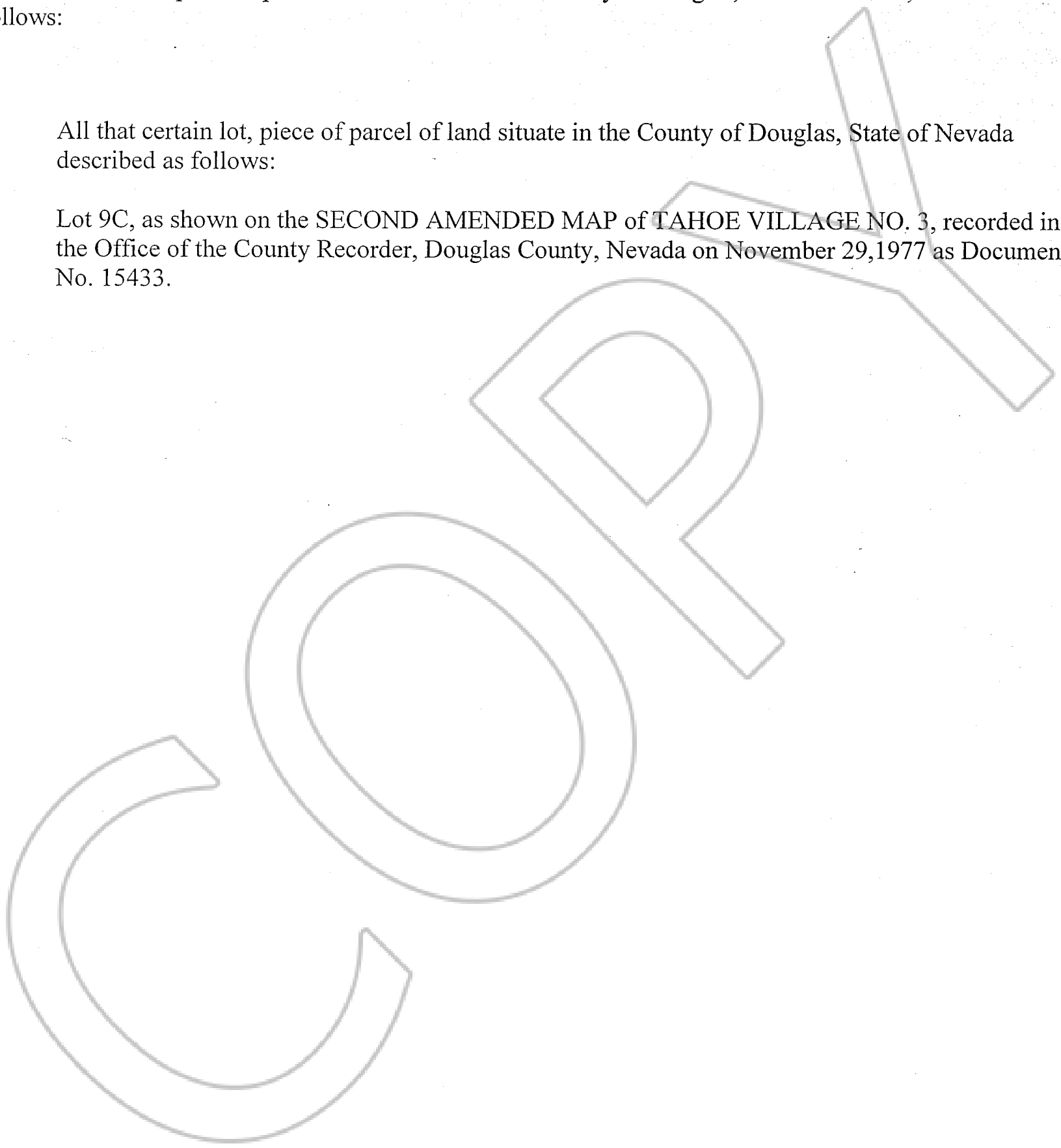

0503128

BK 1100PG 1993

CALIFORNIA ALL-PURPOSE ACKNOWLEDGMENT

No. 5907

State of California

County of El Dorado

On 11-9-00 before me, the undersigned

personally appeared Patti A. Reo-Sherwin

personally known to me - **OR** - proved to me on the basis of satisfactory evidence to be the person(s) whose name(s) is/are subscribed to the within instrument and acknowledged to me that he/she/they executed the same in his/her/their authorized capacity(ies), and that by his/her/their signature(s) on the instrument the person(s), or the entity upon behalf of which the person(s) acted, executed the instrument.

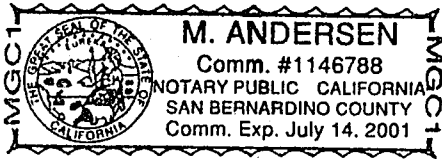

WITNESS my hand and official seal.

[Signature]
SIGNATURE OF NOTARY

OPTIONAL

Though the data below is not required by law, it may prove valuable to persons relying on the document and could prevent fraudulent reattachment of this form.

CAPACITY CLAIMED BY SIGNER

DESCRIPTION OF ATTACHED DOCUMENT

- INDIVIDUAL
- CORPORATE OFFICER
- _____ TITLE(S)
- PARTNER(S) LIMITED
- GENERAL
- ATTORNEY-IN-FACT
- TRUSTEE(S)
- GUARDIAN/CONSERVATOR
- OTHER: _____

_____ TITLE OR TYPE OF DOCUMENT

_____ NUMBER OF PAGES

_____ DATE OF DOCUMENT

_____ SIGNER(S) OTHER THAN NAMED ABOVE

SIGNER IS REPRESENTING:
NAME OF PERSON(S) OR ENTITY(IES)

0503128

BK 1100PG 1994

COPY

REQUESTED BY
FIRST AMERICAN TITLE CO.
IN OFFICIAL RECORDS OF
DOUGLAS CO., NEVADA

2000 NOV -9 AM 3: 57

LINDA SLATER
RECORDER

\$10⁰⁰ PAID *Bh* DEPUTY

0503128

BK 1100PG 1995