

WESTERN ENGINEERING & SURVEYING SERVICES
 CIVIL ENGINEERING • LAND SURVEYING • WASTEWATER • WATER SYSTEMS • LAND USE PLANNING • SUBDIVISIONS

CERTIFICATE OF AMENDMENT

To: Eric Teitelman
 Douglas County Engineer
 P. O. Box 218
 Minden, Nevada 89423

This is to amend PARCEL MAP #1019 for Clark Family Trust, recorded in Book 0796 at Page 4151 as Document No. 392836, Official Records of Douglas County, recorded July 25, 1996.

The Amendment is as follows:

On the above-mentioned Parcel Map, a portion of the line between Parcel 2 and Parcel 3 was omitted. The line should run from the northeasterly corner of Parcel 4 of said Map, which is the radius point of the cul-de-sac; thence N. 29° 35' 06" E., 63.00' to the west end of the south line of Parcel 2, shown on said map as "S. 89° 01' 23" E., 364.88."

David D. Winchell
 DAVID D. WINCHELL, P.E.

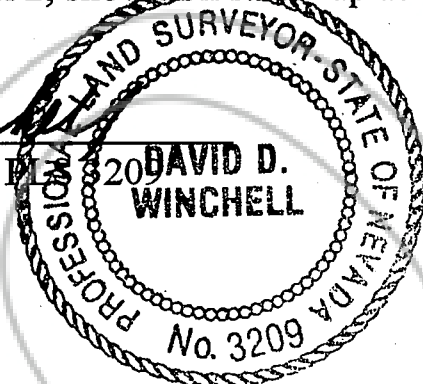

Date: 11/7/2000

I hereby certify that I have examined the certificate of amendment and that the changes to the original document specified therein are provided for in the applicable sections of NRS 278.010 to 278.630, inclusive, NRS 625.340 to 625.380, inclusive, and local ordinances adopted pursuant thereto, and I am satisfied this certificate of amendment so amends the document as to make it technically correct.

Eric Teitelman
 Eric Teitelman, Douglas County Engineer

REQUESTED BY
Western Engineering
 IN OFFICIAL RECORDS OF
 DOUGLAS CO. NEVADA

2000 NOV 30 AM 11:07

LINDA SLATER
 RECORDER

\$7⁰⁰ PAID *k2* DEPUTY

RECEIVED
 NOV 2 2000

0504168

BK 1100PG6041