

Recording Requested By

Name [Redacted]  
Street Address **Monument Mortgage, Inc.  
P.O. Box 5149  
San Ramon, CA 94583-5149**  
City State Zip **Loan # 241015**  
**Servicer Loan #**

Space above this line for recorders use

**Corporation Assignment of Deed of Trust**

FOR VALUE RECEIVED, the undersigned hereby grants, assigns and transfers to

\* 27-005  
1991873  
4451

all beneficial interest under that certain Deed of Trust dated June 28, 2000 executed by  
**Susan Kilby a married woman**

**See attached legal description**

\* **BANK ONE, NATIONAL ASSOCIATION, AS TRUSTEE**  
**1 Bank One Plaza, Suite IL1-0126 (RFC), Chicago, Illinois 60670-0126**

to **First American Title Co.,** APN # 1320-29-116-006 Trustee and recorded as Instrument  
number 0495066 on June 30, 2000 in book 0600, Page 006348, of  
Official Records in the County Recorders office of Douglas County, NV describing land therein as :  
**AS DESCRIBED ON DEED OF TRUST AND REFERRED TO HEREIN**

together with the note or notes therein described or referred to, the money due and to become due thereon with interest, and all rights accrued or to accrue under said Deed of Trust.

State of **California** } SS.  
County of **Contra Costa**

**Monument Mortgage, Inc.,  
a California Corporation**

On **August 2, 2000** before me, **Barbara Pinckard** personally appeared

**Kathleen M. Hall**

**Assistant Secretary**

  
**Kathleen M. Hall**  
**Assistant Secretary**

personally known to me ( or proved to me on the basis of satisfactory evidence ) to be the person(s) whose name(s) is/ are subscribed to the within Instrument and acknowledged to me the he/she/they executed the same in his/her/their authorized capacity(ies), and that by his/her/their signature(s) on the instrument the person(s) or the entity upon behalf of which the person(s) acted, executed the instrument.



WITNESS my hand and official seal

Signature  (Seal)  
**Barbara Pinckard**

MMI Form CA-001

After Recording Return To:

**PEELLE MANAGEMENT CORPORATION**  
ASSIGNMENT JOB #90603  
P.O. BOX 1710  
CAMPBELL, CA 95009-1710  
1-408-866-6868

0504191

BK1100PG6152

DESCRIPTION

All that certain lot, piece or parcel of land situate in the County of Douglas, State of Nevada, described as follows:

Lot 219, as shown on the official plat of WINHAVEN, UNIT NO. 6, filed for record in the office of the County Recorder of Douglas County, Nevada, on August 4, 1994, in Book 894 of Official Records Page 692, as Document No. 343273.

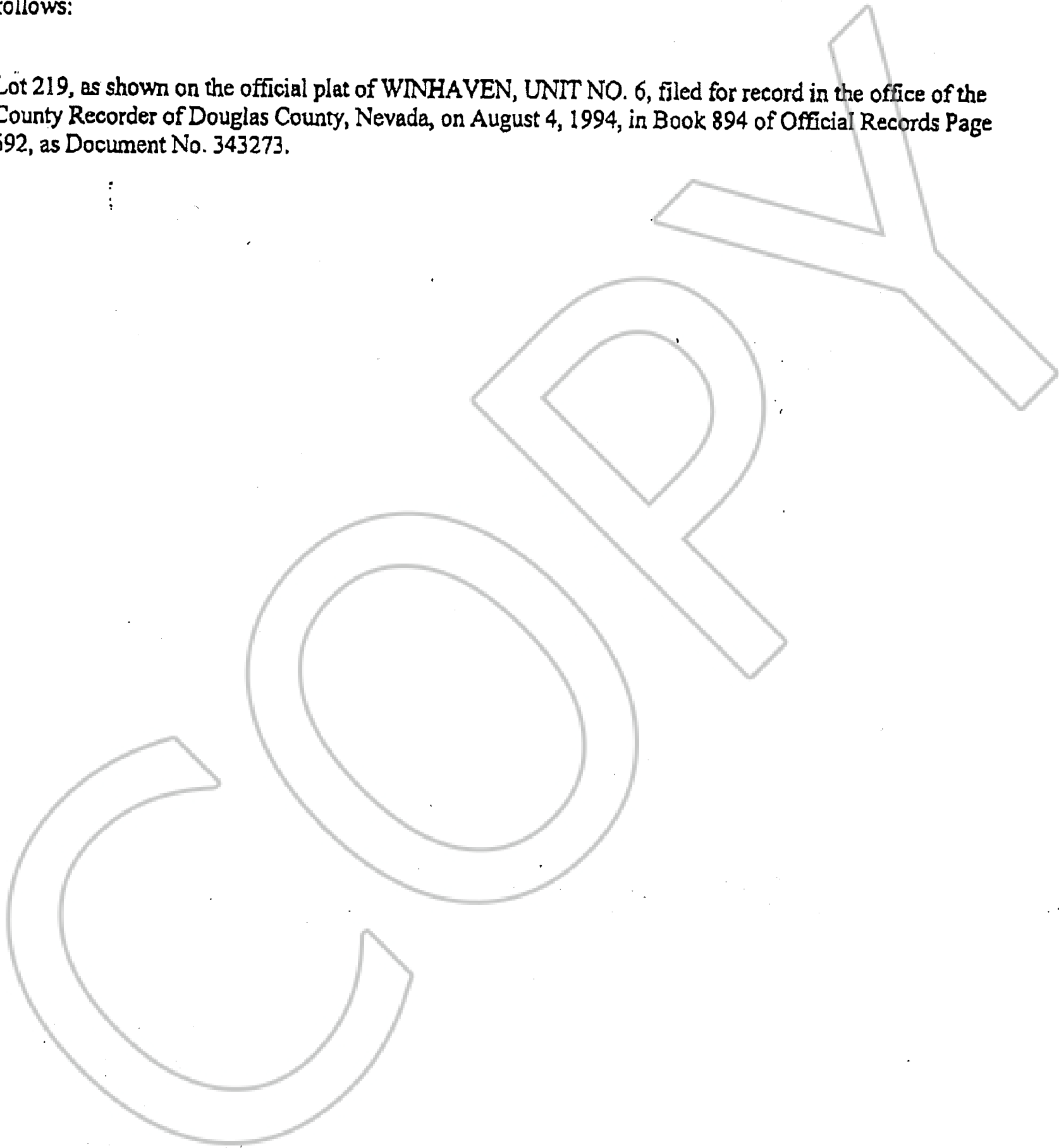

0504191014020

BK 1100PG 6153

1991873  
KILBY  
4451  
SUSAN

COPY

REQUESTED BY  
*Pelle Mgmt*  
IN OFFICIAL RECORDS OF  
DOUGLAS CO., NEVADA

2000 NOV 30 PM 2:02

LINDA SLATER  
RECORDER

05041910010070  
BK 1100PG6154  
\$ 9.00 PAID *AS* DEPUTY