

APN 13-093-070

Deed of Trust and Assignment of Rents

This Deed of Trust made this 8th day of JANUARY 2001 between Rodney Overbo

herein called TRUSTOR, whose address is 3655 Summerhill Dr, Carson City, NV, Douglas County and SUSAN Kuhn

herein called TRUSTEE, and SUSAN Kuhn

herein called Beneficiary,

WITNESSETH: That Trustor IRREVOCABLY GRANTS, TRANSFERS AND ASSIGNS TO TRUSTEE IN TRUST, WITH POWER OF SALE, that property in DOUGLAS County, State of NEVADA described as;

(Set forth legal description AND commonly known address, if known)

3655 Summerhill Dr CARSON CITY, NV 89705 DOUGLAS COUNTY REC 13-093-070

SEE EXHIBIT A

TOGETHER WITH ALL APPURTENANCES in which Trustor has any interest, including water rights benefitting said realty, represented by shares of a company or otherwise; and,

TOGETHER WITH the rents, issues and profits thereof, reserving the right to collect and use the same, except during continuance of some default hereunder, and during continuance of such default, authorizing Beneficiary to collect and enforce the same by any lawful means in the name of any party hereto.

FOR THE PURPOSE OF SECURING (1) Performance of each agreement of Trustor incorporated by reference or contained herein, (2) Payment of the indebtedness evidenced by (1) Promissory Note of even date herewith, and any extension or renewal thereof, in the principal sum of: (\$ 5000.00) DOLLARS FOR PWT TO FLEET MORTGAGE ON 1/9/01 executed by Trustor in favor of Beneficiary, or order. (3) Payment of such additional sums as may hereafter be advanced for the account of Trustor or assigns by Beneficiary with interest thereon.

TO PROTECT THE SECURITY OF THIS DEED OF TRUST, TRUSTOR AGREES: By the execution of this Deed of Trust, that provisions numbered (1) to (16) inclusive of the Master Form Deed of Trust, recorded in the Book and at the Page, or Document No. of Official Records in the Office of the County Recorder of the county where said property is located, noted below opposite the name of such county;

Table with columns: COUNTY, DOCUMENT NUMBER, BOOK, PAGE, COUNTY, DOCUMENT NUMBER, BOOK, PAGE. Lists various counties and their corresponding document details.

which provisions, identical in all counties, are printed on the reverse hereof] hereby are adopted and incorporated herein and made a part hereof as fully as though set forth herein at length; that he will observe and perform said provisions; and that the references to property, obligations, and parties in said provisions shall be construed to refer to the property, obligations, and parties set forth in the Deed of Trust.

The parties agree that with respect to provision 16, the amount of fire insurance required by Covenant 2 shall be \$ and with respect to attorney's fees provided for by covenant 7 the percentage shall be %

The undersigned Trustor requests a copy of any Notice of Default and of any Notice of Sale hereunder be mailed to him at his address hereinbefore set forth.

IN WITNESS WHEREOF, I/We have hereunto set my hand/our hands this 8th day of JANUARY 2001

Signature of Rodney Overbo (Print or type name here)

Signature line (Print or type name here)

STATE OF NEVADA COUNTY OF CARSON CITY

On this 8th day of JANUARY 2001 personally appeared before me, a Notary Public RODNEY OVERBO

RECORDING REQUESTED BY AND MAIL TO NAME SUSAN Kuhn ADDRESS 3068 ABBEY RD CITY/ST/ZIP CHEBOYGAN, MI 49721

NAME Rodney Overbo ADDRESS P.O. Box 2191 CITY/ST/ZIP CARSON CITY, NV 89702

personally known to me to be the person(s) whose name(s) is subscribed to the above instrument who acknowledged that he executed the instrument.

SPACE BELOW THIS LINE FOR RECORDERS USE ONLY

Witness my hand and official seal KASSANDRA WRIGHT NOTARY PUBLIC - NEVADA My Appt. Exp. July 27, 2004

0506491 BK0101PG1349

Exhibit A

The Southeast quarter of the Southeast quarter of the North half of Lot 1 of the Southwest quarter of Section 6, Township 14 North, Range 20 East, M.D.B. & M., excepting therefrom the Northerly 264 feet thereof; and the Northeast quarter of the Northeast quarter of the South half of Lot 1 of the Southwest quarter of Section 6, Township 14 North, Range 20 East, M.D.B. & M., excepting therefrom the Southerly 264 feet thereof.

Assessor's Parcel No. 13-093-07

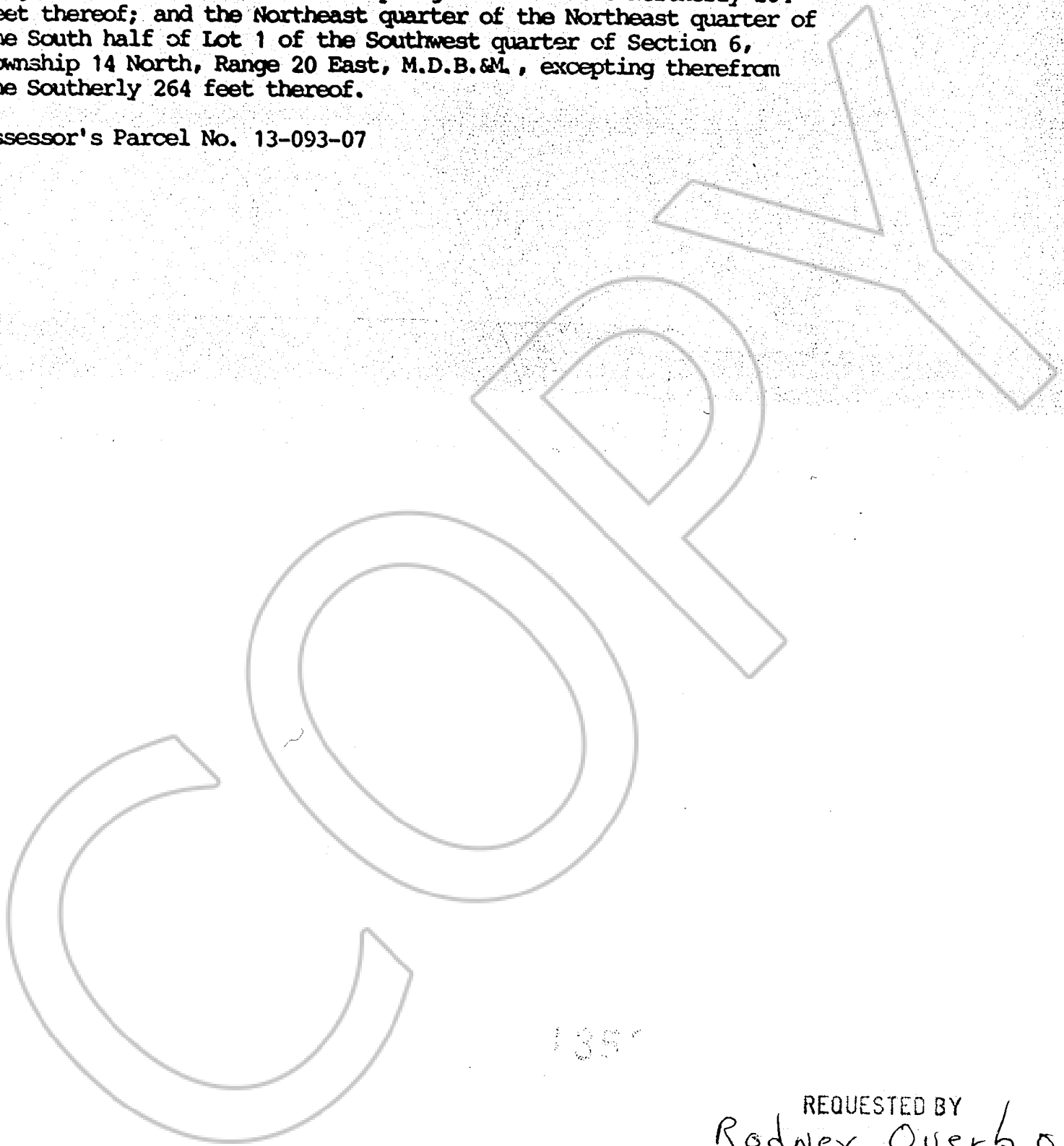

135'

REQUESTED BY
Rodney Overbo
IN OFFICIAL RECORDS OF
DOUGLAS CO., NEVADA

2001 JAN -8 PM 2:46

LINDA SLATER
RECORDER

\$8⁰⁰ PAID Ko DEPUTY

0506491

BK 0101 PG 1350