

Order No. 468020  
Escrow No. -  
Loan No. -  
APN: 35-360-100

WHEN RECORDED MAIL TO:  
Evans Homes  
1528 Hwy 395 N, Ste 240  
Gardnerville, NV 89410

SPACE ABOVE THIS LINE FOR RECORDER'S USE

### NOTICE OF COMPLETION

NOTICE IS HEREBY GIVEN THAT:

1. The undersigned is OWNER of the interest or estate stated below in the property hereinafter described.
2. The FULL NAME of the undersigned is Dan Evans
3. The FULL ADDRESS of the undersigned is 1528 Hwy 395, Suite 240, Gardnerville NV 89410
4. The NATURE OF THE INTEREST or ESTATE of the undersigned is: In fee.

(If other than fee, strike "in fee" and insert, for example, "purchaser under contract of purchase," or "lessee.")

5. The FULL NAMES and FULL ADDRESSES of ALL PERSONS, if any, WHO HOLD SUCH INTEREST or ESTATE with the undersigned as JOINT TENANTS or as TENANTS IN COMMON are:

NAMES	ADDRESSES
<u>Jeff See</u>	<u>144 Hwy 395, Gardnerville, NV</u>
<u>Judith Link</u>	

6. The full names and full addresses of the predecessors in interest of the undersigned if the property was transferred subsequent to the commencement of the work of improvement herein referred to:

NAMES	ADDRESSES

7. A work of improvement on the property hereinafter described was COMPLETED 1-19-01
8. The NAME OF THE ORIGINAL CONTRACTOR, if any, for such work of improvement is EVANS HOMES ( DAN EVANS )

(if no contractor, insert "none.")

9. The street address of said property is 144 Hwy 395, Gardnerville, NV
10. The property on which said work of improvement was completed is in the City of ---  
County of Douglas, State of Nevada, and is described as follows:

See attached exhibit "A"

Date: also known as 144 Highway 395, Gardnerville, NV  
1-19-01

Verification for INDIVIDUAL owner:

STATE OF NEVADA  
COUNTY OF \_\_\_\_\_ } ss.

Signature of owner named in paragraph 2

Dan Evans

The undersigned, being first duly sworn, states that he is the owner of the aforesaid interest or estate in the property described in the above notice; that he has read the same, knows and understands the contents thereof, and that the facts stated therein are true.

Signature of owner named in paragraph 2

Dan Evans

SUBSCRIBED AND SWORN TO before me

on 1-19-01

Signature [Signature]  
Notary Public in and for said state.

Verification for PARTNERSHIP owner:

STATE OF NEVADA  
COUNTY OF \_\_\_\_\_ } ss.

being duly sworn, says:  
That he is one of the partners of \_\_\_\_\_

\_\_\_\_\_, the partnership that executed the foregoing notice as owner of the aforesaid interest or estate in the property therein described; that he makes this verification on behalf of said partnership; that he has read said notice and knows the contents thereof, and that the facts therein stated are true.

Signature of partner \_\_\_\_\_

SUBSCRIBED AND SWORN TO before me

on \_\_\_\_\_

Signature \_\_\_\_\_

Notary Public in and for said state.

Verification for CORPORATE owner:

STATE OF NEVADA  
COUNTY OF \_\_\_\_\_ } ss.

being duly sworn, says:  
That he is the \_\_\_\_\_  
of \_\_\_\_\_

\_\_\_\_\_, the corporation that executed the foregoing notice as owners of the aforesaid interest or estate in the property therein described; that he makes this verification on behalf of said corporation; that he has read said notice and knows the contents thereof, and that the facts therein stated are true.

Signature of officer \_\_\_\_\_

SUBSCRIBED AND SWORN TO before me

on \_\_\_\_\_

Signature \_\_\_\_\_

Notary Public in and for said state.

Name (Typed or Printed)

**J. LESTER**  
Notary Public - State of Nevada  
Appointment Recorded in Douglas County  
No: 98-5080-5 - EXPIRES SEPT. 21, 2002

**0507140**  
**BK0101PG3644**

Name (Typed or Printed)

**EXHIBIT "A"**

**The land referred to in this Report is situated in Douglas County, State of Nevada, and is described as follows:**

Parcel H of Section 5, Township 11 North, Range 21 East, M.D.B.&M.

Reference is hereby made to that certain Record of Survey Map for the United States Department of the Interior, Bureau of Land Management, recorded in the Office of the Douglas County Recorder, State of Nevada, on March 20, 1992 in Book 392 at Page 3301 as File No. 273678, Official Records.

Together with an easement for ingress and egress over those portions of said land as described in Grant of Easement for Right-of-way recorded in the Office of the Douglas County Recorder on July 25, 1995 in Book 795 at Page 3585 as File No. 366767, Official Records.

Assessor's Parcel No. 35-360-100.

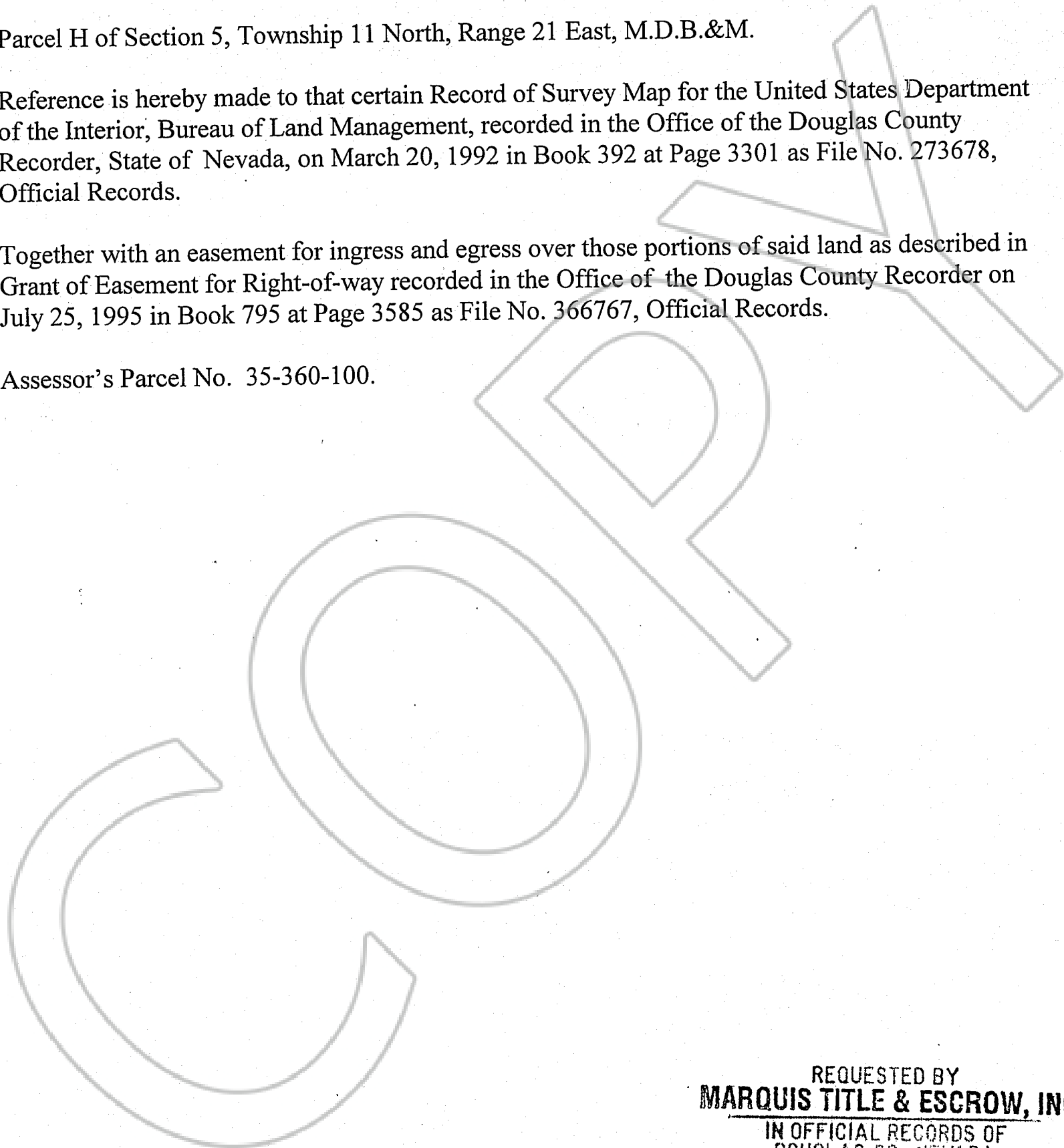

REQUESTED BY  
**MARQUIS TITLE & ESCROW, INC.**

IN OFFICIAL RECORDS OF  
DOUGLAS CO. NEVADA

2001 JAN 22 AM 9:49

LINDA SLATER  
RECORDER

\$ 8.00 PAID KJ DEPUTY

0507140

BK 0101 PG 3645