

**BASIS OF BEARINGS**

THE BASIS OF BEARINGS OF THIS MAP IS THE EAST LINE OF THE PARCEL SHOWN ON THE RECORD OF SURVEY MAP FOR THE UNITED METHODIST CHURCH, DOCUMENT #295178, OFFICIAL RECORDS, DOUGLAS COUNTY, NEVADA. SAID LINE BEARS S1'29'43"E.

**LEGEND**

- SET 5/8" REBAR WITH PLASTIC CAP STAMPED PLS 3090.
- FOUND 5/8" REBAR WITH PLASTIC CAP STAMPED PLS 3090.
- (M) MEASURED.
- (D) DEED, BOOK 389, PAGE 010, DOCUMENT #197298, OFFICIAL RECORDS, DOUGLAS COUNTY, NEVADA.
- (C) CALCULATED.
- (R) RECORD AS PER RECORD OF SURVEY MAP FOR UNITED METHODIST CHURCH, DOCUMENT #295178, OFFICIAL RECORDS, DOUGLAS COUNTY, NEVADA.

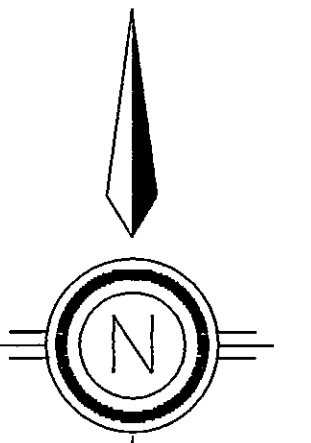

SCALE: 1"=50'

(DOUGLAS COUNTY)

CENTERVILLE LN.

CENTERVILLE

WIRED TAG STAMPED PLS 3090 TO LARGE NAIL SET IN ROTTEN FENCE POST.

(JACOBS FAMILY TRUST, JACOBS, SHIRLEE L. TRUSTEE)

(SILK, GEORGE A. & HELEN M.)

S 39°30'32" E (D)  
18.43' (D)

N 88°30'17" E (D)  
1069.06' (D)

S 01°29'43" E (D)  
50.00' (D)

S 88°30'17" W (D)  
540.59' (D)

(CARSON VALLEY UNITED METHODIST CHURCH)

N 03°52'55" E (D)  
108.13' (D)

456.04' (M) S 01°29'43" E (R)  
456.08' (R) BASIS OF BEARINGS

**SURVEYOR'S CERTIFICATE**

I, WYATT J. OWENS, A PROFESSIONAL LAND SURVEYOR REGISTERED IN THE STATE OF NEVADA, CERTIFY THAT:

1. THIS PLAT REPRESENTS THE RESULTS OF A SURVEY CONDUCTED UNDER MY DIRECT SUPERVISION AT THE INSTANCE OF DICK MCCOLE
2. THE LANDS SURVEYED LIE WITHIN SECTION 4, TOWNSHIP 12, NORTH, RANGE 20, EAST, M.D.B.&M., AND THE SURVEY WAS COMPLETED ON FEBRUARY 7, 2001.
3. THIS PLAT COMPLIES WITH THE APPLICABLE STATE STATUTES AND ANY LOCAL ORDINANCES IN EFFECT ON THE DATE THAT THE GOVERNING BODY GAVE ITS FINAL APPROVAL.
4. THE MONUMENTS DEPICTED ON THIS PLAT ARE OF THE CHARACTER SHOWN, OCCUPY THE POSITIONS INDICATED AND ARE OF SUFFICIENT NUMBER AND DURABILITY.

DATE 2/8/01 Wyatt J. Owens  
WYATT J. OWENS, PLS 3090

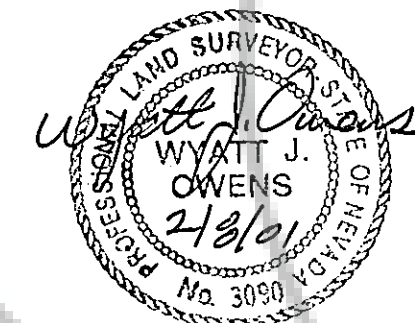

A.P.N. 1220-04-101-002

AREA = 9.049 ACRES

N 77°50'46" E (D)  
4843.28' (D)

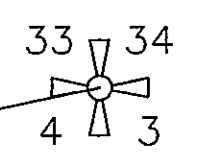

S 79°53'07" E (C)  
786.62' (C)

(ROMAN CATHOLIC BISHOP OF RENO)

(DUDLEY FAMILY TRUST, DUDLEY, MARK R. & BEVERLY A.)

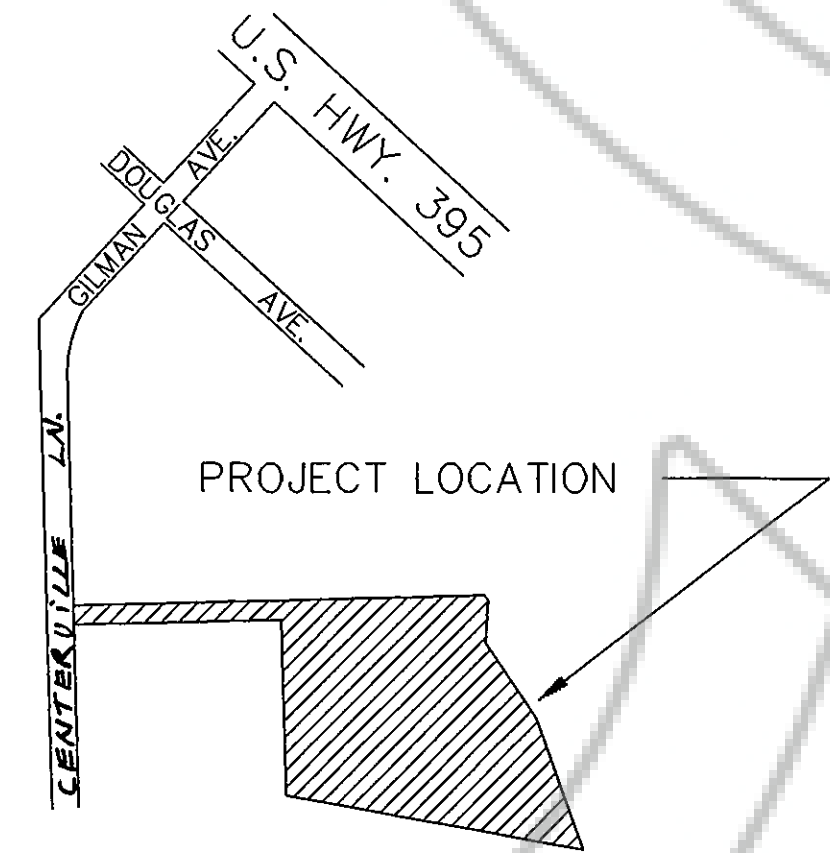

**VICINITY MAP**

NOT TO SCALE

**RECORDER'S CERTIFICATE**

FILED FOR RECORD THIS 8<sup>th</sup> DAY OF FEBRUARY 2001 AT 0 MINUTES PAST 10 O'CLOCK A.M. IN BOOK 020 OF OFFICIAL RECORDS PAGE 1236 DOCUMENT NUMBER 508344 RECORDED AT THE REQUEST OF WYATT J. OWENS. Gloria Baruel, Deputy  
DOUGLAS COUNTY RECORDER

**RECORD OF SURVEY**  
FOR  
**DOLORES EHRLER**  
AND  
**HELEN KUSSEFF DIMITRIEVSKI**  
WITHIN THE NW1/4 OF SECTION 4, T. 12 N., R. 20 E., M.D.B. & M. DOUGLAS COUNTY, NEVADA

SHEET 1 OF 1