

A.P. No. 05-220-04 Adjusted
Escrow No. 2000-26884-KJP
R.P.T.T. Exempt #3

WHEN RECORDED MAIL TO:
Round Hill General Improvement District
P.O. Box 976
Zephyr Cove, NV 89448

GRANT, BARGAIN and SALE DEED

FOR A VALUABLE CONSIDERATION, receipt of which is hereby acknowledged,

Round Hill General Improvement District, a municipal Corporation,

do(es) hereby GRANT, BARGAIN and SELL to

Round Hill General Improvement District, a municipal Corporation,

the real property situate in the County of Douglas, State of Nevada, described as follows:

See Exhibit "A" Attached hereto and made a part hereof

A.P. No. 05-220-04 Adjusted

TOGETHER with all tenements, hereditaments and appurtenances, including easements and water rights, if any, thereto belonging or appertaining, and any reversions, remainders, rents, issues or profits thereof.

Date 3/21/01

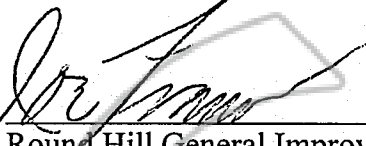

Round Hill General Improvement District
By: Joe Francoeur

State of Nevada
County of Douglas

This instrument was acknowledged before me on 3/21/01, by



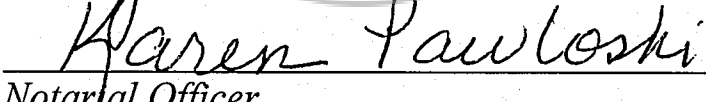

Notarial Officer

 KAREN PAWLOSKI
Notary Public - State of Nevada
Appointment Recorded in Douglas County
No: 96-2898-5 - Expires May 24, 2004

0511392
BK0301PG8146

DESCRIPTION
Adjusted APN 05:220:04

All that real property situate in the County of Douglas, State of Nevada, described as follows:

All that portion of the Northeast 1/4 of the Northeast 1/4 of Section 15, Township 13 North, Range 18 East, M.D.M., more particularly described as follows:

Beginning at the most Westerly corner of that certain parcel of land as described in deed recorded on December 21, 1970, in Book 82, Page 249;

- thence South 44°39'36" East 7.79 feet to the True Point of Beginning;
- thence South 85°23'00" West 138.38 feet;
- thence South 65°23'30" West 56.02 feet;
- thence North 69°36'30" West 41.72 feet;
- thence North 24°36'30" West 76.50 feet;
- thence North 65°23'30" East 106.00 feet;
- thence South 24°36'30" East 100.68 feet;
- thence North 85°23'00" East 123.13 feet;
- thence South 45°20'24" West 105.62 feet;
- thence South 44°39'36" East 115.00 feet;
- thence South 45°20'24" West 115.00 feet;
- thence North 44°39'36" West 107.21 feet to the True Point of Beginning.

Containing 25,504 square feet, more or less.

The Basis of Bearing for this description is that certain Record of Survey filed for record as Document No. 414274.

Note: Refer this description to your title company before incorporating into any legal document.

Prepared by: Turner & Associates, Inc.
Land Surveying
P.O. Box 5067
Stateline, NV 89449

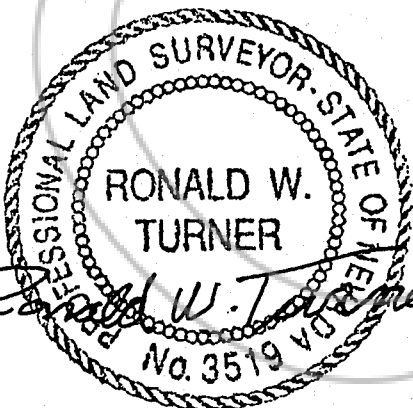

REQUESTED BY
FIRST AMERICAN TITLE CO.

IN OFFICIAL RECORDS OF
DOUGLAS CO. NEVADA

2001 MAR 30 PM 12:13

LINDA SLATER
RECORDER

\$ 8.00 PAID KJ DEPUTY

0511392

BK 0301 PG 8147