

LEGAL DESCRIPTION

The land referred to herein is situated in the State of Nevada,
County of Douglas, described as follows:

Lot 16, of Block B as set forth on the final map of MOUNTAIN
GLEN, PHASE 2, filed for record in the office of the County
Recorder of Douglas County, State of Nevada, on September 28,
1989, in Book 989, Page 3823, as Document No. 211874.

Assessors Parcel Nos. 1320-30-813-039

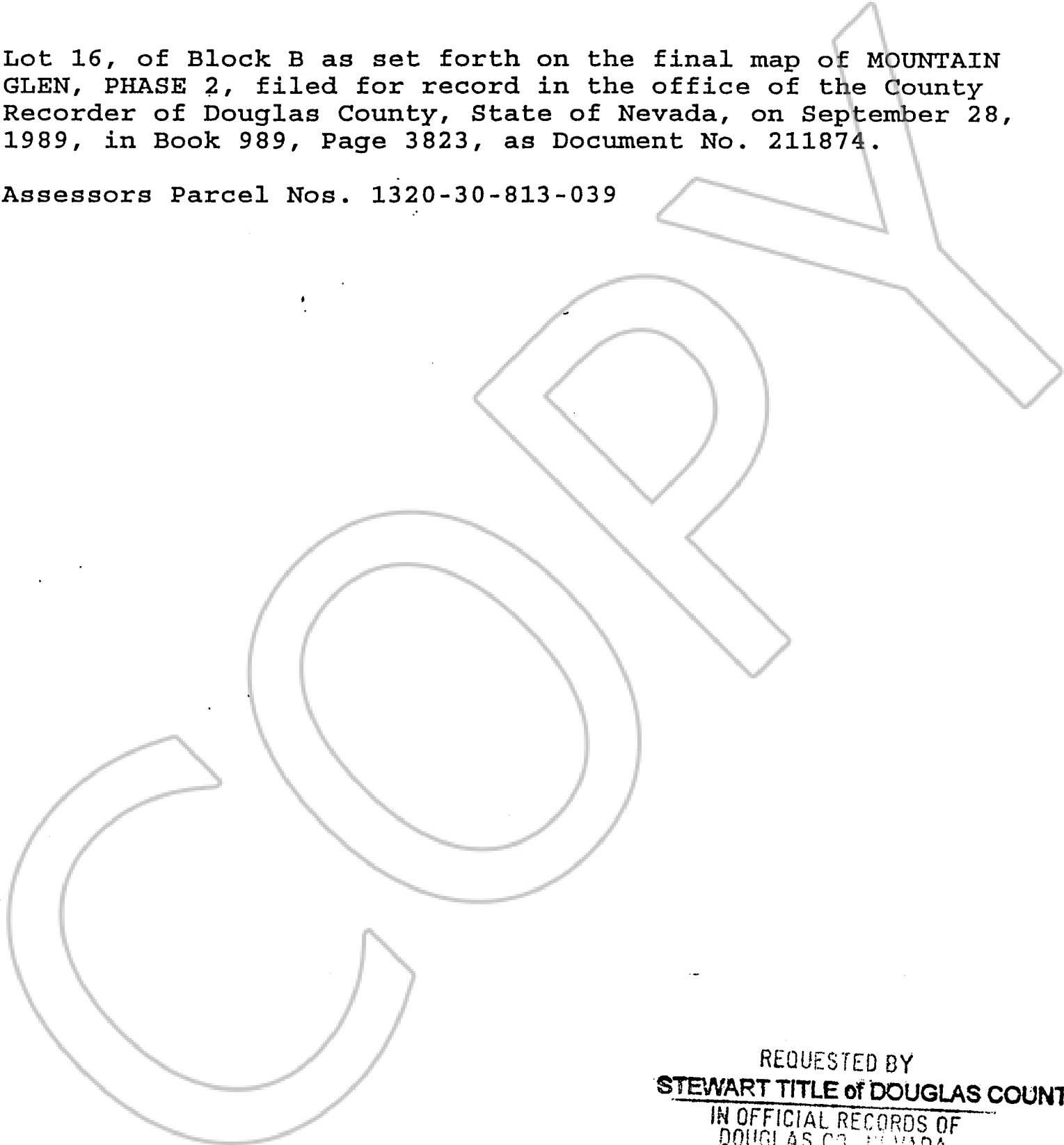

REQUESTED BY
STEWART TITLE of DOUGLAS COUNTY
IN OFFICIAL RECORDS OF
DOUGLAS CO. NEVADA

2001 APR -4 PM 4: 18

LINDA SLATER
RECORDER

\$ 8.00 PAID *[Signature]* DEPUTY

0511699

BK0401PG0918