

RECORDING REQUESTED BY:
STEWART TITLE COMPANY
WHEN RECORDED MAIL TO:
MAIL TAX STATEMENTS TO:

ESCROW NO. 010301205
R.P.T.T. \$ 73.45
A.P.N. # 1220-24-302-001
Full Value

MR. AND MRS. FLETCHER
PO 2879
Gardnerville NV 89410

GRANT, BARGAIN, SALE DEED

THIS INDENTURE WITNESSETH: That **HAROLD L. LONG AND N. JEANETTE LONG, HUSBAND AND WIFE AS JOINT TENANTS**

in consideration of \$10.00, the receipt of which is hereby acknowledged, does hereby Grant, Bargain Sell and Convey to **LARRY FLETCHER AND TANYA FLETCHER, HUSBAND AND WIFE AS JOINT TENANTS**

and to the heirs and assigns of such Grantee forever, all that real property situated in the **unincorporated area** County of **DOUGLAS** State of Nevada, bounded and described as follows:
SEE EXHIBIT "A" ATTACHED HERETO AND MADE A PART HEREOF

Together with all and singular the tenements, hereditaments and appurtenances thereunto belonging or in anywise appertaining, and any reversions, remainders, rents, issues or profits thereof.

DATE: **April 17, 2001**

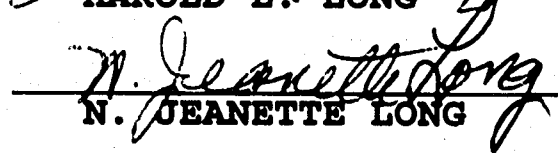

HAROLD L. LONG

N. JEANETTE LONG



STATE OF Nevada }
COUNTY OF Douglas } ss.

This instrument was acknowledged before me on 4-19-01
by, HAROLD L. LONG and N. JEANETTE LONG

Signature Mary H. Kelsch
Notary Public

0512645
BK0401PG4941

EXHIBIT "A"

LEGAL DESCRIPTION

ESCROW NO.: 010301205

The real property situate in the Northwest 1/4 of the Southwest 1/4 of Section 24, Township 12 North, Range 20 East, M.D.B.&M., more particularly described as follows:

Parcel 4-A, as set forth on Parcel Map for HAROLD L. LONG, et ux, filed for record in the Office of the Douglas County Recorder on November 12, 1989, Book 1189, Page 2027, Document No. 214812, of Official Records.

Assessors Parcel No. 1220-24-302-001

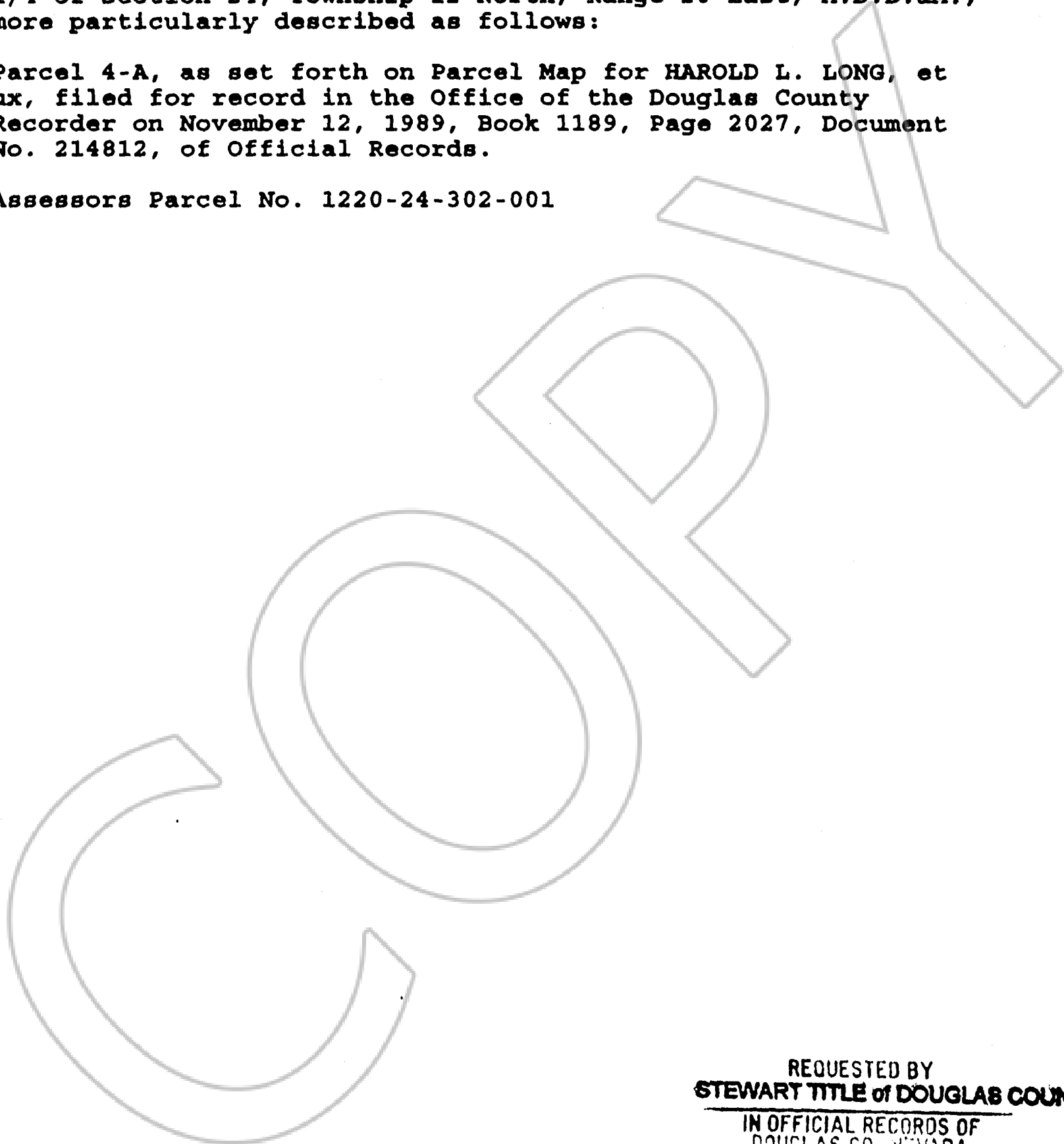

REQUESTED BY
STEWART TITLE of DOUGLAS COUNTY
IN OFFICIAL RECORDS OF
DOUGLAS CO. NEVADA

2001 APR 19 PM 3:44

LINDA SLATER
RECORDER

SL PAID *kg* DEPUTY

0512645

BK0401PG4942