

**SURVEYOR'S CERTIFICATE:**

I, DAVID D. WINCHELL, A PROFESSIONAL LAND SURVEYOR REGISTERED IN THE STATE OF NEVADA, CERTIFY THAT:

1. THIS PLAT REPRESENTS THE RESULTS OF A SURVEY CONDUCTED UNDER MY SUPERVISION AT THE INSTANCE OF JERALD R. JACKSON.
2. THE LANDS SURVEYED LIE WITHIN A PORTION OF SECTION 26, TOWNSHIP 12 NORTH, RANGE 19 EAST, M.D.B.&M. AND THE SURVEY WAS COMPLETED ON OCTOBER 12, 1998.
3. THIS PLAT COMPLIES WITH APPLICABLE STATUTES OF THIS STATE AND ANY LOCAL ORDINANCES IN EFFECT ON THE DATE THAT THE SURVEY WAS CONDUCTED IN ACCORDANCE WITH CHAPTER 625 OF THE NEVADA ADMINISTRATIVE CODE.
4. THE MONUMENTS DEPICTED ON THE PLAT ARE OF THE CHARACTER SHOWN, OCCUPY THE POSITIONS INDICATED, AND ARE OF SUFFICIENT QUALITY.

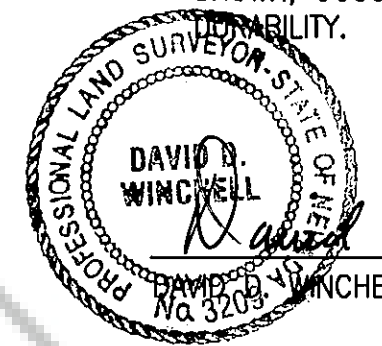

DAVID D. WINCHELL  
 P.L.S. 3209  
 DATE 5/23/2001

**NOTES:**

1. THE PURPOSE OF THIS RECORD OF SURVEY IS TO SHOW THE RELATIONSHIP OF THE CORRECTED LOCATIONS OF THE 30' PRIVATE ACCESS EASEMENT TO THE LOT LINES SHOWN ON THE ORIGINAL FINAL MAP FOR JACKSON CREEK RANCH ESTATES, BK. 298, Pg. 4120, DOCUMENT No. 433187, OFFICIAL RECORDS OF DOUGLAS COUNTY.
2. THE LOT LINES THAT ARE SHOWN ON THE FINAL MAP FOR JACKSON CREEK RANCH ESTATES ARE TO REMAIN THE SAME.

**LEGEND**

- △ - INDICATES CALCULATED POINT, NOTHING FOUND OR SET
- - INDICATES 5/8" REBAR AND CAP SET PER THE FINAL MAP JACKSON CREEK RANCH ESTATES, DOC. No. 433187, OFFICIAL RECORDS OF DOUGLAS COUNTY, NEVADA
- - INDICATES SET 5/8" REBAR AND CAP P.L.S. 3209
- ⊙ - INDICATES SET CLASS "A" CENTERLINE MONUMENT P.L.S. 3209

**BASIS OF BEARINGS**

THE BEARING N 71°25'06" E FOR THE NORTHWESTERLY LINE AS SHOWN PER THE FINAL MAP FOR JACKSON CREEK RANCH ESTATES, AS DOCUMENT No. 433187, OFFICIAL RECORDS OF DOUGLAS COUNTY WAS USED AS THE BASIS OF BEARINGS FOR THIS MAP.

**COUNTY RECORDER'S CERTIFICATE:**

FILED THIS 31<sup>ST</sup> DAY OF May, 2001, AT  
47 MINUTES PAST 2 O'CLOCK P.M. IN BOOK OS01,  
 AT PAGE 9960, DOCUMENT NUMBER 515523  
 RECORDED AT THE REQUEST OF Jerald Jackson

*[Signature]*  
 DOUGLAS COUNTY RECORDER Chief Deputy

**AMENDED RECORD OF SURVEY FOR JERALD R. JACKSON (Trustee of the Jerald R. Jackson 1975 Trust)**

A Record of Survey, originally filed in the Official Records of Douglas County, Nevada, on November 16, 1998, in Book 1198, at Page 3140, as Document No. 454054, is being amended and filed of record so that the Lot numbers shown on the Record of Survey will now coincide with the Assessor's Parcel Numbers which have now been assigned to each of the Lots in Jackson Creek Ranch Estates Subdivision

BEING A PORTION OF THE N. 1/2 OF SECTION 26 TOWNSHIP 12 NORTH, RANGE 19 EAST, M.D.B. & M. DOUGLAS COUNTY NEVADA SHEET 1 OF 1 SHEET

**WESTERN ENGINEERING & SURVEYING SERVICES**  
 33032 SILVER SAGE DRIVE  
 CARSON CITY, NEVADA 89701  
 (702) 884-3200 FAX (702) 884-3211