

10-
GRANT, BARGAIN AND SALE DEED

RPTT \$ # 3

APN: 1420-34-501-018, 1420-34-601-002 & 1420-34-601-003

THIS INDENTURE WITNESSETH: That

FOR A VALUABLE CONSIDERATION, receipt of which is hereby acknowledged,
KENNETH EARL BRAMWELL and CONSTANCE ALEATH J. BRAMWELL, HUSBAND AND WIFE AS JOINT
TENANTS

doe(es) hereby GRANT(s) BARGAIN SELL and CONVEY to
KENNETH EARL BRAMWELL and CONSTANCE ALEATH J. BRAMWELL, HUSBAND AND WIFE AS JOINT
TENANTS

and to the heirs and assigns of such Grantee forever, all the following real property situated in the county of DOUGLAS,
state of Nevada bounded and described as follows:

SEE EXHIBIT "A", "B" & "C" ATTACHED HERETO AND MADE A PART HEREOF

TOGETHER with all tenements, hereditaments and appurtenances, if any, thereto belonging or appertaining, and any
reversions, remainders, rents, issues or profits thereof.

Dated: April 23, 2001

STATE OF UTAH

COUNTY OF Weber

} ss. Kenneth Earl Bramwell
KENNETH EARL BRAMWELL

This instrument was acknowledged before me on

April 24, 2001

by Kenneth Bramwell, Constance Bramwell

Constance Aleath J. Bramwell
CONSTANCE ALEATH J. BRAMWELL

Melissa Rentmeister
Notary Public

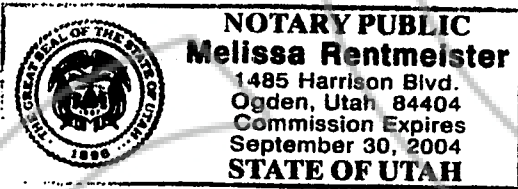

(This area for official notarial seal)

SPACE BELOW THIS LINE FOR RECORDER'S USE

✓ WHEN RECORDED MAIL TO

Name **KENNETH EARL BRAMWELL**
Street Address **1120 EAST, 1675 NORTH**
NORTH OGDEN, UTAH 84404
City, State
Zip
Order No. **00084368-201-KLS**

0515958

0480204/23/01

BK0601PG1688

PTN 1420-34-601-003

LEGAL DESCRIPTION
(New Parcel 6A)

That portion of the Northeast $\frac{1}{4}$ of Section 34, Township 14 North, Range 20 East, M.D.B. & M., in the County of Douglas, State of Nevada, being more particularly described as follows:

Beginning at the Northwestern corner of Parcel 6 as said parcel is shown on that Certain Land Division Map for Kenneth E. Bramwell, recorded in Book 1282 at Page 951 as Document No. 74022 of the Official Records of said Douglas County; thence Easterly along the Northerly line of said Parcel 6, N. $89^{\circ} 57' 06''$ E., 236.77 feet; thence S. $0^{\circ} 02' 13''$ W., 183.98 feet; thence S. $89^{\circ} 57' 06''$ W., 236.77 feet to a point on the Easterly right-of-way line of Fuller Avenue, which is the Westerly line of said Parcel 6; thence Northerly along said Westerly line N. $0^{\circ} 02' 13''$ E., 183.98 feet to the Point of Beginning.

Said Parcel Contains 1.000 Acres (43,561 square feet), more or less.

Prepared By:

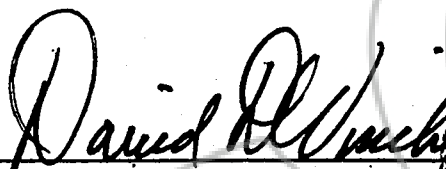
David D. Winchell, PLS 3209



Dated: 3/15/2001

0515958

BK0601PG1689

PTH 1430-34-601-003

LEGAL DESCRIPTION
(New Parcel 7A)

That portion of the Northeast ¼ of Section 34, Township 14 North, Range 20 East, M.D.B. & M., in the County of Douglas, State of Nevada, being more particularly described as follows:

Beginning at the Northwesterly corner of Parcel 6 as said parcel is shown on that Certain Land Division Map for Kenneth E. Bramwell, recorded in Book 1282 at Page 951 as Document No. 74022 of the Official Records of said Douglas County, said corner being on the Easterly right-of-way line of Fuller Avenue; thence Southerly along the Westerly line of said Parcel 6, S. 0° 02' 13" W., 183.98 feet to the TRUE POINT OF BEGINNING; thence N. 89° 57' 06" E., 236.77 feet; thence S. 0° 02' 13" W., 183.98 feet; thence S. 89° 57' 06" W., 236.77 feet to a point on the Easterly right-of-way line of Fuller Avenue, which is the Westerly line of said Parcel 6; thence Northerly along said Westerly line N. 0° 02' 13" E., 183.98 feet to the TRUE POINT OF BEGINNING.

Said Parcel Contains 1.000 Acres (43,561 square feet), more or less.

Prepared By:

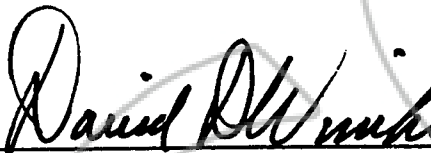
David D. Winchell, PLS 3209



Dated: 3/15/2001

0515958

BK0601PG1690

PTN 1420-34-501-018
PTN 1420-34-601-002

LEGAL DESCRIPTION
(New Parcel 8A)

That portion of the Northeast ¼ of Section 34, Township 14 North, Range 20 East, M.D.B. & M., in the County of Douglas, State of Nevada, being more particularly described as follows:

Beginning at the Northwestern corner of Parcel 8 as said parcel is shown on that Certain Land Division Map for Kenneth E. Bramwell, recorded in Book 1282 at Page 951 as Document No. 74022 of the Official Records of said Douglas County, said corner being on the Southerly right-of-way line of Stephanie Way; thence Easterly along the Northerly line of said Parcel 8, N. 89° 57' 00" E., 399.00 feet to the Northeasterly corner of said Parcel 8; thence Southerly along the Easterly line of said Parcel 8, S. 0° 23' 09" E., 2581.13 feet to the Southeasterly corner of said Parcel 8, said corner being on the Northerly right-of-way line of Downs Drive; thence Westerly along the Southerly line of said Parcel 8, S. 89° 57' 07" W., 963.54 feet to the Southwesterly corner of said Parcel 8; thence N. 0° 02' 13" E., 219.00 feet; thence S. 89° 57' 07" W., 320.00 feet to the Southwesterly corner of said Parcel 8, said corner being on the Easterly right-of-way line of Fuller Avenue; thence Northerly along the Westerly line of said Parcel 8, N. 0° 02' 13" E., 663.12 feet; thence N. 89° 57' 06" E., 236.77 feet; thence N. 0° 02' 13" E., 367.96 feet to a point on the Northerly line of Parcel 6 of said Land Division Map; thence Easterly along the Northerly line of said Parcel 6, N. 89° 57' 06" E., 638.48 feet to the Northeasterly corner of said Parcel 6; thence Northerly along the Westerly line of said Parcel 8 of said Land Division Map, N. 0° 22' 59" W., 1331.01 feet to the Point of Beginning.

Said Parcel Contains 45.286 Acres, more or less.

Prepared By:

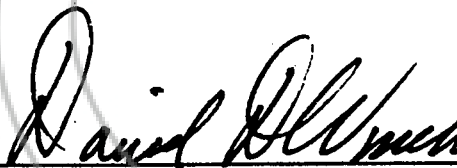
David D. Winchell, PLS 3209

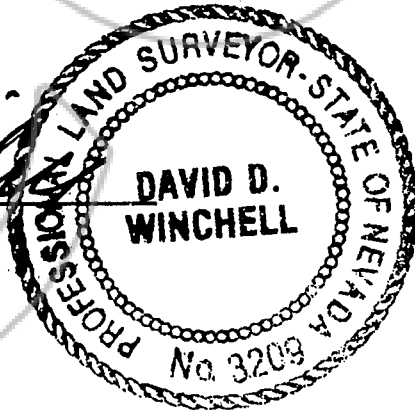

Dated: 3/15/2001

REQUESTED BY

UNOFFICIAL RECORDS OF
DOUGLAS CO., NEVADA

2001 JUN -7 PM 1:04

0515958

BK0601PG1691

LINDA SLATER
RECORDER

\$ 10.00 PAID AB DEPUTY