

84760CLH  
APN 1320-33-714-031

**POWER OF ATTORNEY**  
(Special)

**WARNING: THIS DOCUMENT GIVES YOUR ATTORNEY-IN-FACT THE POWER TO ACT FOR YOU IN ANY WAY YOU COULD ACT FOR YOURSELF. IT MAY BE IN YOUR BEST INTEREST TO CONSULT WITH AN ATTORNEY TO EXPLAIN ANYTHING ABOUT THIS FORM THAT YOU DO NOT UNDERSTAND. YOU HAVE THE RIGHT TO REVOKE OR TERMINATE THIS POWER OF ATTORNEY AT ANYTIME.**

**KNOWN ALL MEN BY THESE PRESENTS: That: I, LYNN D. TOWLE**  
the undersigned (jointly and severally, if more than one) do hereby appoint BRADFORD A. TOWLE  
as my exclusive, true and lawful Attorney-in-Fact in my capacity, for me and in my name, for the special and limited purpose(s) of

**PURCHASING REAL PROPERTY AND, EXECUTING LOAN DOCUMENTS**  
with respect to the following described property in the County of Douglas, State of Nevada:  
See Exhibit A attached hereto and made a part hereof.

more commonly known as: 1313 BROOKE WAY, GARDNERVILLE, NV 89410

For such limited and special purposes, said Attorney(s) is/are hereby authorized in Principal's name, and for Principal's use and benefit:

(A) to loan, advance, defer payment of, demand, sure for, collect, and receive all sums of money, debts, accounts, legacies, bequests, interests, dividends, annuities, and demands as are now or shall hereafter become due, owing, payable, or belonging to Principal, and take all lawful means in the name of Principal for the recovery thereof and to compromise the same, and give satisfaction, releases or discharges for the same:

(B) to buy and sell land, exchange, mortgage, hypothecate, foreclose, assign, transfer, convey and in any lawful manner deal in and with land, make contracts of every kind relative to land, any interests therein or the possession thereof, and take possession and exercise control over the use thereof:

(C) to buy, sell, exchange, mortgage, hypothecate, foreclose, assign, transfer, convey and in any lawful manner deal in and with goods, wares, and merchandise, choses in action, certificates or shares of capital stock, and other property in possession or in action, and to make, do and transact all and every kind of business or whatever nature:

(D) to execute, acknowledge and deliver contracts of sale, escrow instructions, deeds, leases (including both oil and gas and community oil and gas leases), assignments of leases, covenants, agreements, assignments of agreements, mortgages, conveyances in trust to secure indebtedness or other obligations, and assign the beneficial interest thereunder, subordination's of liens or encumbrances, indemnities, bills of lading, bills, bonds, notes, receipts, evidences of debt, requests for partial or full reconveyance of deeds of trust, releases and satisfactions of mortgages, judgments, and other debts, and other instruments in writing of whatever kind and nature, all upon such terms and conditions and under such covenants as said Attorney shall provide.

(E) to receive any Notice of Right to Cancel under the Truth in Lending Act on my behalf, to modify or waive my right to rescind to pass without exercising such right to rescind, and to confirm that such right to rescind has not been exercised.

0517281

0527526/19/01

BK0601PG7541

(F) to sign, seal, execute, deliver and acknowledge such instruments in writing of whatever kind and nature as may be necessary or proper in the premises.

(G) To receive and endorse check for net proceeds of loan or hypothecation of Note

GIVING AND GRANTING to said Attorney full power and authority to do all and every act and thing whatsoever requisite and necessary to be done relative to any of the foregoing as fully to all intents and purposes as Principal might or could do if personally present.

All that said Attorney shall lawfully do or cause to be done under the authority of this Power of Attorney is expressly approved, ratified and confirmed.

Signed this 20<sup>th</sup> day of June, 2001

LYNN D. TOWLE x Lynn D. Towle (your signature)

**CERTIFICATE OF ACKNOWLEDGMENT OF NOTARY PUBLIC**

STATE OF <sup>Montana</sup> ~~NEVADA~~  
COUNTY OF Lewis & Clark } ss

This instrument was acknowledged before me on

June 20, 2001

by Duff L. Shephard

WITNESS my hand and official seal.

Duff L. Shephard  
Notary Public

(This area for official notarial seal)

SPACE BELOW THIS LINE FOR RECORDER'S USE

**RECORDING REQUESTED BY  
Western Title Company, Inc.  
AND WHEN RECORDED MAIL TO**

Name Mr. and Mrs. Bradford Towle  
Street Address 1313 Brooke Way  
City, State Gardnerville, Nv 89410  
Zip  
Order No. 00084760-201-CLH

SEAL

0517281

0537526/19/01

BK0601PG7542

Exhibit A

All that real property situate in the County of Douglas, State of Nevada, described as follows:

Lot 31, in Block F. as shown on the FINAL SUBDIVISION MAP #1006-8 OF CHICHESTER ESTATES PHASE 6, filed for record in the office of the County Recorder of Douglas County, State of Nevada, on February 16, 2000, in Book 0200, Page 2552, as Document NO. 486411.

ASSESSOR'S PARCEL NO. 1320-33-714-031

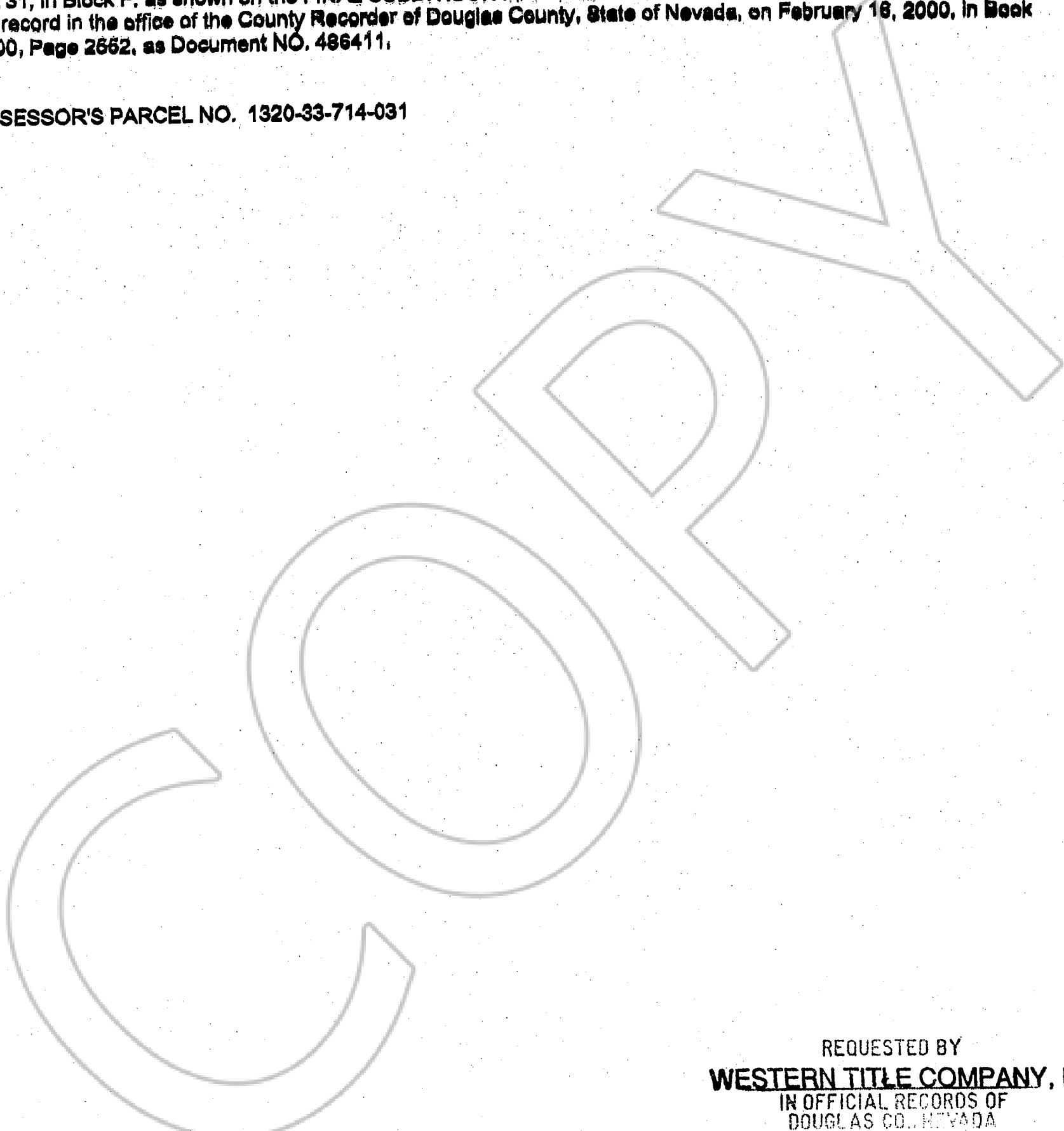

REQUESTED BY  
**WESTERN TITLE COMPANY, INC.**  
IN OFFICIAL RECORDS OF  
DOUGLAS CO., NEVADA

2001 JUN 27 PM 4: 23

LINDA SLATER  
RECORDZR

\$ 9.00 PAID KD DEPUTY

0517281

BK0601PG7543