

14  
Loan No.: 123134-9

✓  
Prepared by: CYNTHIA DUFF  
Household Mortgage Services  
577 Lamont Road  
Elmhurst, IL 60126

STATE OF NEVADA  
SUBSTITUTION OF TRUSTEE AND FULL RECONVEYANCE

WHEREAS,  
Original Trustor is: FEDERICO S. CLAVERIA, AN UNMARRIED MAN

Original Trustee is:  
WESTERN TITLE

Original Beneficiary is:  
GOODRICH AND PENNINGTON MORTGAGE FUND, INC.  
Recorded in DOUGLAS COUNTY, Nevada as  
Document No., in Volume, Page, Deed of Trust Date:  
INST: 442406 BK: 698 PG: 4518 DOT DATED: 6-19-1998

LEGAL DESCRIPTION.....SEE ATTACHMENT "A" MADE A PART HEREOF  
PARCEL NUMBER: 11-370-06

WHEREAS, the undersigned Beneficiary desires to substitute a  
new Trustee under said Deed of Trust in place and stead of  
WESTERN TITLE

Now, therefore, the undersigned hereby substitutes itself as  
Trustee under said Deed of Trust and does hereby reconvey,  
without warrranby, to the person or persons legally entitled  
thereto, the Estate now held by it thereunder.

Dated: June 22, 2001

MORTGAGE ELECTRONIC REGISTRATION SYTEMS, INC.

*Cynthia Duff*  
\_\_\_\_\_  
CYNTHIA DUFF, Asst. Vice President

State of Illinois )  
County of Dupage )

SEAL

MIN #1000460000380349 /  
888-679-MERS

0517615  
BK0701PG0307



EXHIBIT A - PROPERTY DESCRIPTION

ALL THAT CERTAIN LOT, PIECE OR PARCEL OF LAND SITUATE IN THE COUNTY OF DOUGLAS, STATE OF NEVADA, DESCRIBED AS FOLLOWS:

PARCEL ONE:

PARCEL D OF LOT 553 AS SHOWN ON THAT PARCEL MAP FOR WALTER E. REISS, M.D., RECORDED OCTOBER 15, 1980, IN BOOK 1080, PAGE 1184, DOCUMENT NO. 49654, OFFICIAL RECORDS OF DOUGLAS COUNTY, NEVADA.

BEING A PARCEL MAP OF LOT 553 AS SHOWN ON THE AMENDED MAP OF SUMMIT VILLAGE, RECORDED IN THE OFFICE OF THE COUNTY RECORDER OF DOUGLAS COUNTY, NEVADA, ON SEPTEMBER 16, 1968, AS DOCUMENT NO. 43419, OFFICIAL RECORDS OF DOUGLAS COUNTY, NEVADA.

PARCEL TWO:

A 1/8 INTEREST IN THE COMMON AREA OF LOT 553 AS SHOWN ON THAT PARCEL MAP FOR WALTER E. REISS, M.D., RECORDED OCTOBER 15, 1980 IN BOOK 1080, PAGE 1184, DOCUMENT NO. 49654, OFFICIAL RECORDS OF DOUGLAS COUNTY, NEVADA.

A.P.N. 11-370-06

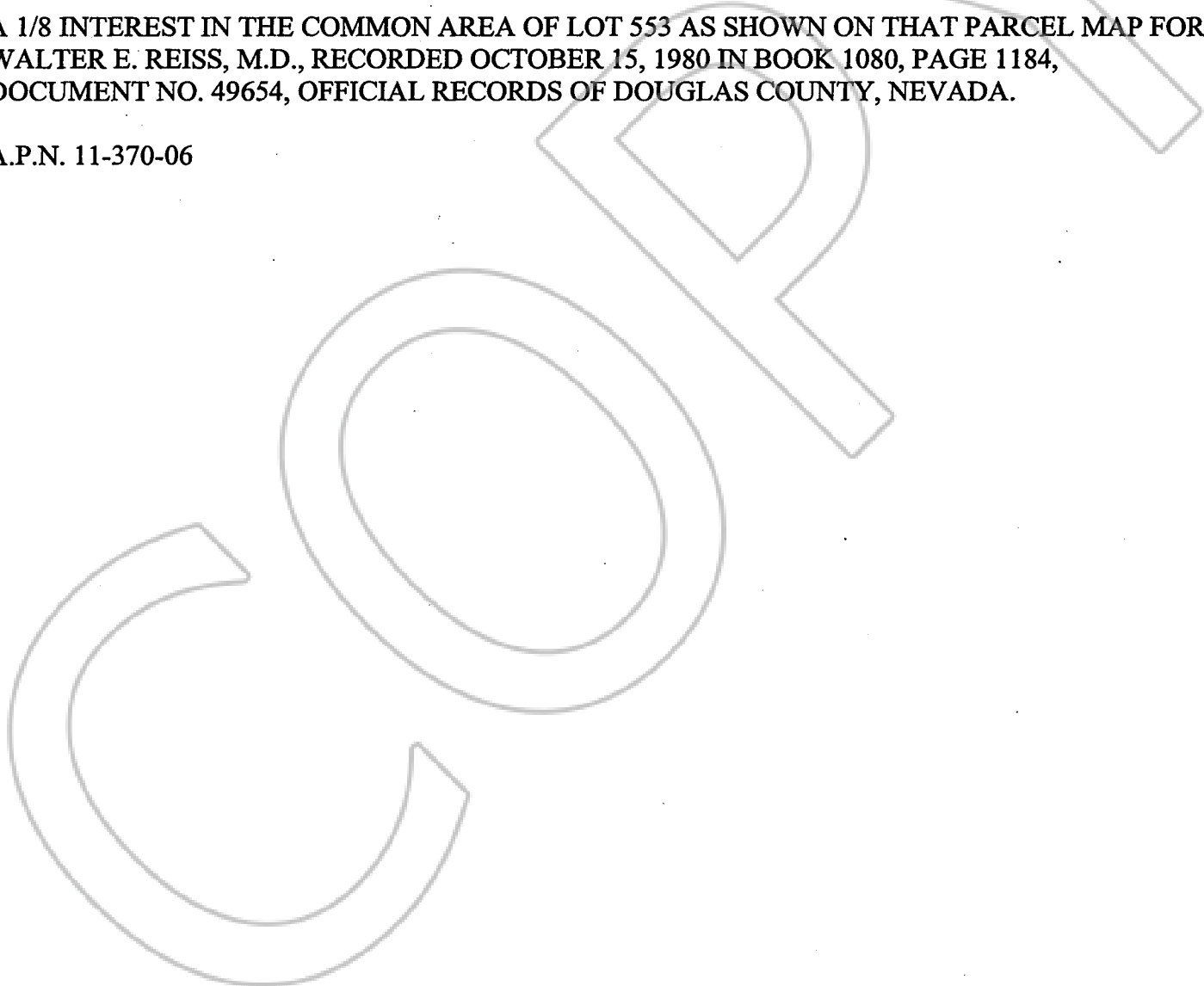

0517615  
BK0701PG0309

DESCRIPTION

All that certain lot, piece or parcel of land situate in the County of Douglas, State of Nevada, described as follows:

PARCEL ONE:

Parcel D of lot 553 as shown on that parcel Map for WALTER E. REISS, M.D., recorded October 15, 1980, in Book 1080, Page 1184, Document No. 49654, Official Records of Douglas County, Nevada.

Being a Parcel Map of Lot 553 as shown on the Amended Map of SUMMITT VILLAGE, recorded in the office of the County Recorder of Douglas County, Nevada, on September 16, 1968, as Document No. 43419, Official Records of Douglas County, Nevada.

PARCEL TWO:

A 1/8 interest in the common area of Lot 553 as shown on that parcel map for WALTER E. REISS, M.D., recorded October 15, 1980 in Book 1080, Page 1184, Document No. 49654, Official Records of Douglas County, Nevada.

A.P.N. 11-370-06

COPY

REQUESTED BY  
Household Bank  
IN OFFICIAL RECORDS OF  
DOUGLAS CO., NEVADA

2001 JUL -3 AM 9: 54

LINDA SLATER  
RECORDER

\$ 14<sup>00</sup> PAID Ka DEPUTY

0517615

BK0701PG0311