

APN: 1420-06-401-019

RECORDED AT THE REQUEST OF:
Jeremme Mc Gilvray

WHEN RECORDED MAIL TO:

Jeremme Mc Gilvray
C/o George Soetje
PO Box 4581
Carson City, Nv. 89702

DOCUMENTARY TRANSFER TAX \$ 129,000 167.70

Computed on the consideration or value of property conveyed; OR
 Computed on the consideration or value less liens or encumbrances remaining at time of sale.

GRANT DEED

APN: 13-104-040

FOR A VALUABLE CONSIDERATION, receipt of which is hereby acknowledged,

George Soetje, an unmarried man

hereby GRANT(S) to

Jeremme Mc Gilvray, an unmarried man

the real property in the City of Carson City
County of Douglas

State of Nevada described as

SHOWN ON EXHIBIT "A" ATTACHED HERETO AND MADE A PART HEREOF

Dated

6/18/01

STATE OF

COUNTY OF

Carson City

} ss.

George Soetje
George Soetje

On

6/18/01

before me,

Jennifer Calhoun a notary public

personally appeared

George Soetje

person(s) whose name(s) is/are subscribed to the within instrument and acknowledged to me that he/she/they executed the same in his/her/their authorized capacity(ies), and that by his/her/their signature(s) on the instrument the person(s) or the entity upon behalf of which the person(s) acted, executed the instrument. WITNESS my hand and official seal.

Signature

Jennifer Calhoun

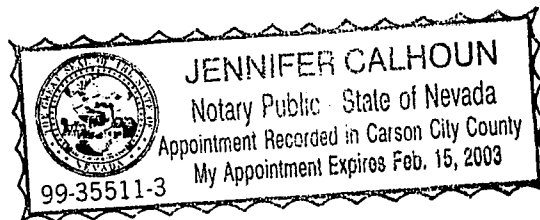

0517625

BK0701PG0321

Exhibit "A"

Legal Description:

The following Real Property in the State of Nevada, County of Douglas, City of Carson City and described as follows:

The Westerly 220 feet of a portion of the Southwest Quarter of the Southeast Quarter of the South Half of Lot 1 of the Southwest Quarter of Section 6, Township 14 North, Range 20 East, lying southerly of the existing road to Jacks Valley.

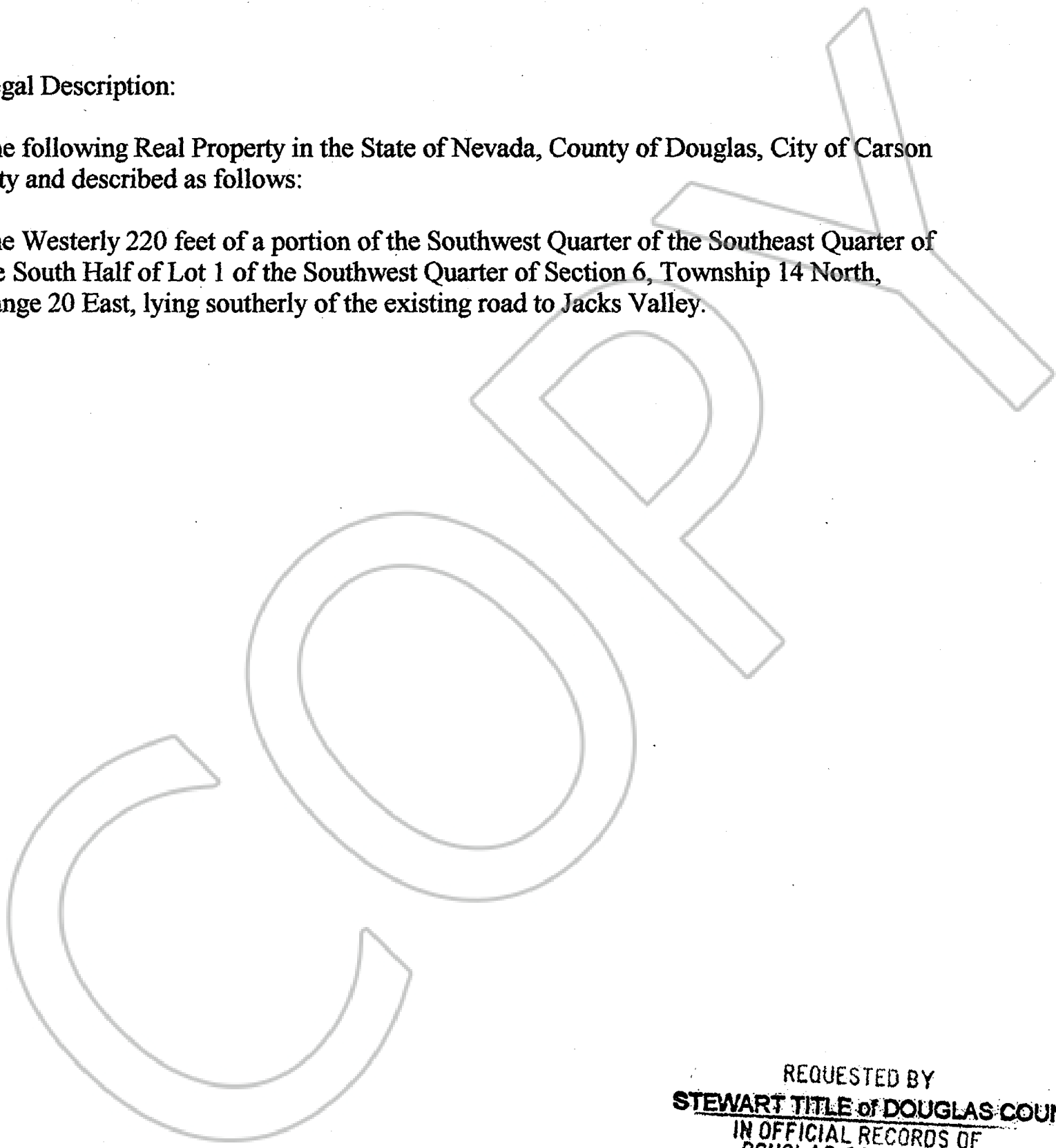

REQUESTED BY
STEWART TITLE of DOUGLAS COUNTY
IN OFFICIAL RECORDS OF
DOUGLAS CO., NEVADA

2001 JUL -3 AM 10: 25

LINDA SLATER
RECORDER

\$ 8.00 PAID Kg DEPUTY

0517625

BK0701PG0322