

EXHIBIT "A"

LEGAL DESCRIPTION

ESCROW NO.: 010301979

All that portion of the Southeast 1/4 of Section 28, Township 14 North, Range 20 East, M.D.B.&M., more particularly described as follows:

Parcel 2 as set forth on Parcel Map LDA #00-062 for WEST RIDGE HOMES, INC., filed for record in the office of the county Recorder of Douglas County, State of Nevada on June 28, 2001, Book 0601, Page 7776, as Document No. 517343.

APN 1420-28-801-009

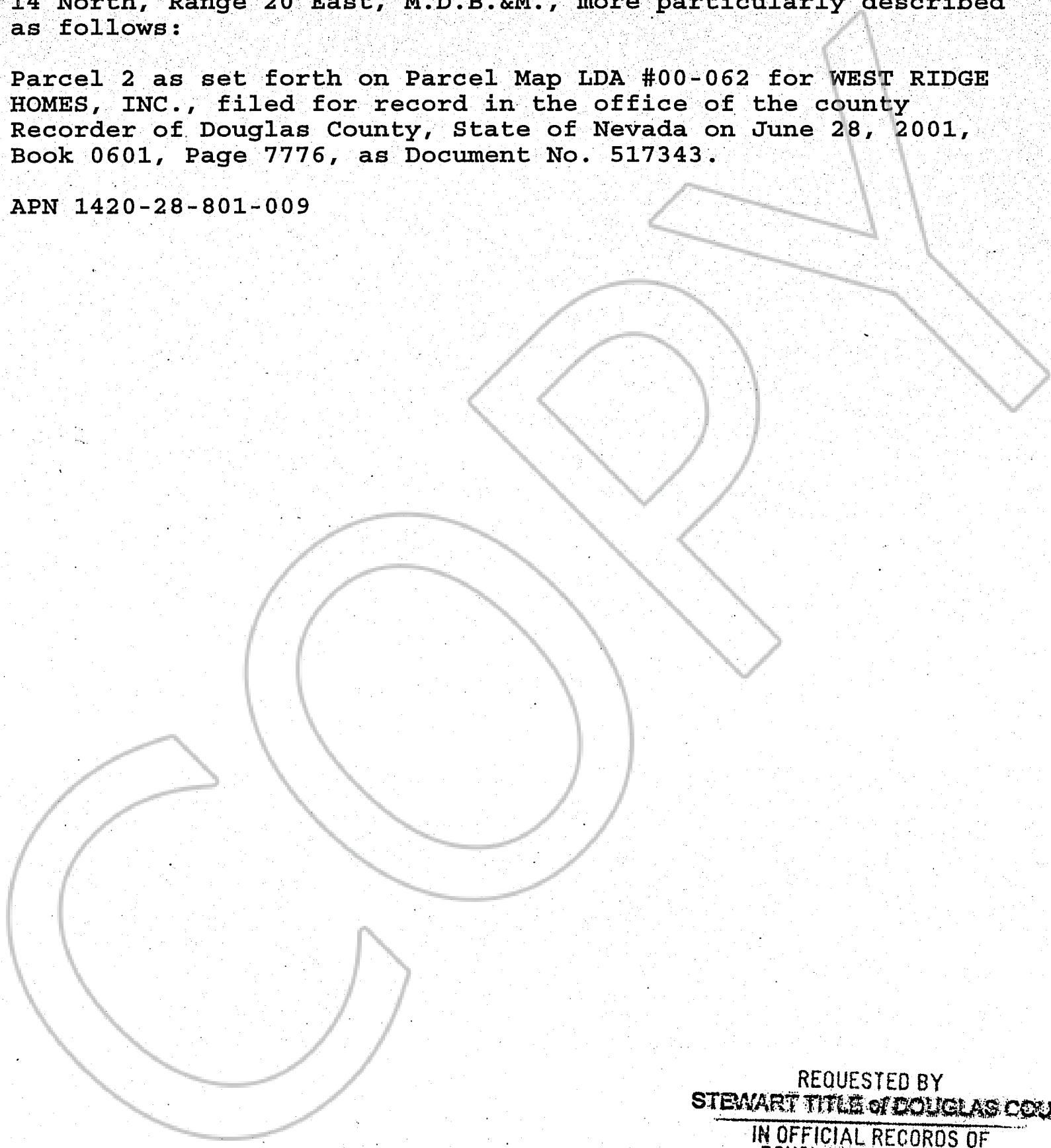

REQUESTED BY
STEWART TITLE of DOUGLAS COUNTY
IN OFFICIAL RECORDS OF
DOUGLAS CO., NEVADA

2001 JUL 27 PM 4: 09

LINDA SLATER
RECORDER

\$ 8.00 PAID [Signature] DEPUTY

0519395

BK0701PG7419