

RECORDING REQUESTED BY
AND WHEN RECORDED MAIL TO:

Wells Fargo Home Mortgage, Inc.
3601 MINNESOTA DRIVE, STE 200
BLOOMINGTON, MN 55435
Attn: MAC # 4701-022
Loan #: 5843787

Space Above this Line for County Recorder

Corporation Assignment of Mortgage/Deed of Trust

FOR VALUE RECEIVED, the undersigned hereby grants, assigns and transfers to:

First Union National Bank, As Trust Administrator
9639 DR. PERRY ROAD, STE 124, IJAMSVILLE, MD 21754

all beneficial interest under that certain Deed of Trust dated: October 31, 2000
executed by: DONALD W. NIEMANN and CHINA NIEMANN

To
, Trustor
, Trustee

and recorded as Instrument No. 048970 on September 07, 2000 in Book: 0900
Page: 0812, of Official Records in the County Recorders office of DOUGLAS County
NV, describing land therein as:

LEGAL DESCRIPTION AS SHOWN AND/OR ATTACHED TO THE DEED OF TRUST REFERRED TO HERE!

Pin or Tax ID #: 07-245-060

Property Address: 216 TERRACE VIEW, STATELINE, NV 89449

TOGETHER with the note or notes therein described or referred to, the money due and to become due thereon with interest, and all rights accrued or to accrue under said Mortgage/Deed of Trust.

Dated: August 01, 2001

State of Minnesota) ss.
County of Hennepin

On August 01, 2001



Wells Fargo Home Mortgage,
Inc.
a California Corporation

[Signature]
Lana Elsenpeter
Assistant Secretary

before me

personally appeared Lana Elsenpeter, Assistant Secretary of Wells Fargo Home Mortgage, Inc. a California Corporation known to me (or proved to me on the basis of satisfactory evidence) to be the person(s) whose name(s) is/are subscribed to the within instrument and acknowledged to me that he/she/they executed the same in his/her/their authorized capacity(ies). entity upon behalf of which the person(s) acted, executed the instrument.
WITNESS my hand and official seal.

[Signature] (Seal)

FOR NOTARY SEAL OR STAMP

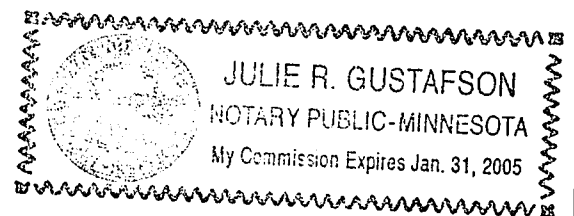

0522525

BK0901PG2146

DESCRIPTION

All that certain lot, piece or parcel of land situate in the County of Douglas, State of Nevada, described as follows:

Lot 42, as shown on the map of LAKEWOOD KNOLLS SUBDIVISION, Douglas County, Nevada, filed in the Office of the County Recorder of Douglas County, Nevada, on May 29, 1958, under Document No. 13163.

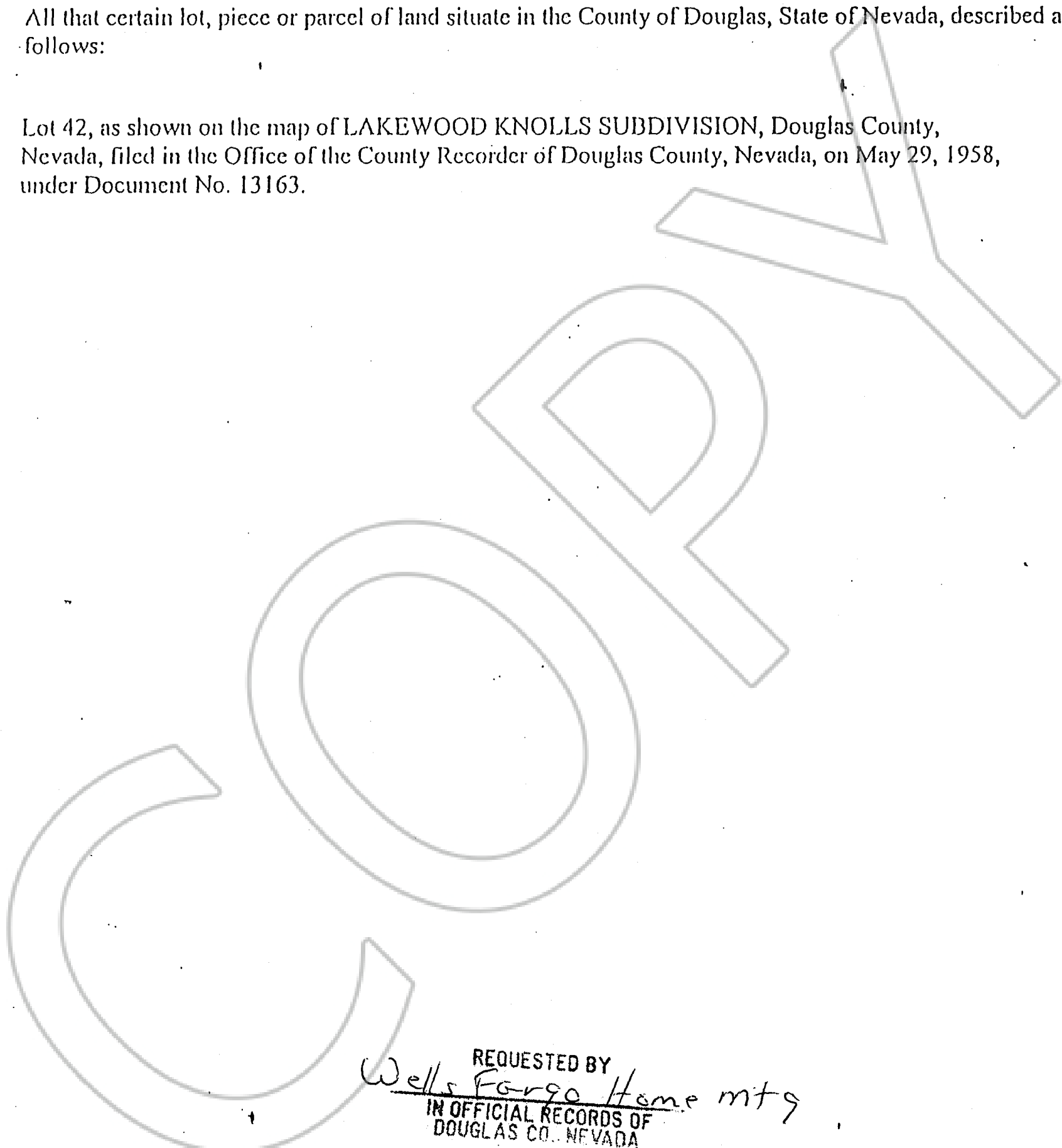

REQUESTED BY
Wells Fargo Home mtg
IN OFFICIAL RECORDS OF
DOUGLAS CO., NEVADA

2001 SEP 10 AM 11:51

LINDA SLATER
RECORDER

\$ 8.00 PAID *KD* DEPUTY

0522525
BK0901PG2147

0498970
BK0900PG0829