

GRANT, BARGAIN AND SALE DEED

APN: 1420-33-701-023 1420-33-701-024 1420-33-701-025

RPTT \$ 6 #3

Full Value
 Full Value less liens

THIS INDENTURE WITNESSETH: That

FOR A VALUABLE CONSIDERATION, receipt of which is hereby acknowledged,

SIERRA VIEW DEVELOPMENT LLC, DANIEL C. FITCH AND GILBERT SHIRLEY

doe(es) hereby GRANT(s) BARGAIN SELL and CONVEY to
SIERRA VIEW DEVELOPMENT LLC

and to the heirs and assigns of such Grantee forever, all the following real property situated in the city _____ county of
Douglas, state of Nevada bounded and described as follows:
See Exhibit A attached hereto and made a part hereof.

TOGETHER with all tenements, hereditaments and appurtenances, if any, thereto belonging or appertaining, and any reversions, remainders, rents, issues or profits thereof.

Dated: September 14, 2001

STATE OF NEVADA

COUNTY OF DOUGLAS } s.s

On SEPTEMBER 17, 2001 personally
appeared before me, a Notary Public,

DANIEL C. FITCH & GILBERT SHIRLEY

personally known or proved to me to be the person whose name is
subscribed to the above instrument who acknowledged that he
executed the instrument.

Signature _____

[Handwritten Signature]

SIERRA VIEW DEVELOPMENT, BY

[Handwritten Signature]
DANIEL C. FITCH

[Handwritten Signature]
GILBERT SHIRLEY



(This area for official notarial seal)

SPACE BELOW THIS LINE FOR RECORDER'S USE

WHEN RECORDED MAIL TO:
Name **SIERRA VIEW DEVELOPMENT LLC**
Street Address P.O. BOX 3841
City, State Zip STATELINE, NV 89449

MAIL TAX STATEMENTS TO:
Name **SIERRA VIEW DEVELOPMENT LLC**
Street Address P.O. BOX 3841
City, State Zip STATELINE, NV 89449

Order No. 00085174-201-CLH

0522919
BK0901PG3864

Exhibit A

All that real property situate in the County of Douglas , State of Nevada, described as follows:

PARCEL A:

Parcel H-1 as set forth on parcel map for Virginia G. Orcutt, filed for record on November 7, 1990, Book 1190, Page 754, as Document No. 238264, Official Records, Douglas County, Nevada.

A.P.N.: 1420-33-701-023

PARCEL B:

Parcel H-2 as set forth on parcel map for Virginia G. Orcutt, filed for record on November 7, 1990, Book 1190, Page 754, as Document No. 238264, Official Records, Douglas County, Nevada.

A.P.N.: 1420-33-701-024

PARCEL C:

The North 681.74 feet of the West 322.11 feet of the East 1,636.02 feet of the Southeast ¼ of Section 33, Township 14 North, Range 20 East M.D.B.&M., Douglas County, Nevada.

EXCEPTING THEREFROM the North 30 feet of said land.

Reference is made to that certain Parcel Map for Harold Clapham filed for record in the Office of the County Recorder of Douglas County, Nevada on May 7, 1974 in Book 574, Page 225 as Document No. 73074.

A.P.N.: 1420-33-701-025

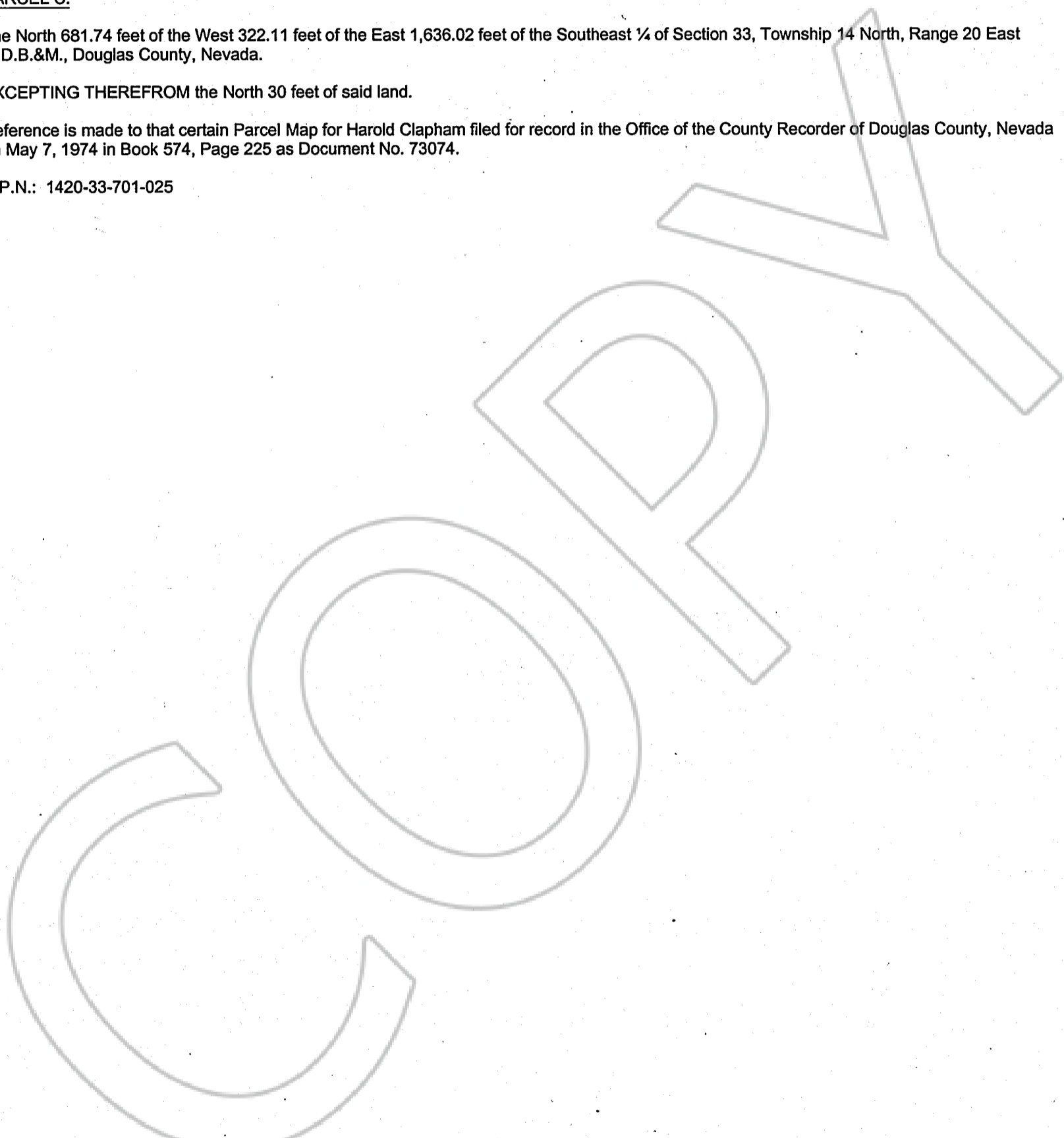

REQUESTED BY
WESTERN TITLE COMPANY, INC.
IN OFFICIAL RECORDS OF
DOUGLAS CO., NEVADA

2001 SEP 17 PM 4: 26

LINDA SLATER
RECORDER

\$ 8.00 PAID Kg DEPUTY

0522919
BK0901PG3865