

EXHIBIT "A"

LEGAL DESCRIPTION

ESCROW NO.: 010102096

Lot 96, as shown on the map of SIERRA VIEW SUBDIVISION, filed in the office of the County Recorder on April 18, 1960, under File No. 15897.

Assessors Parcel No. 1420-34-710-060

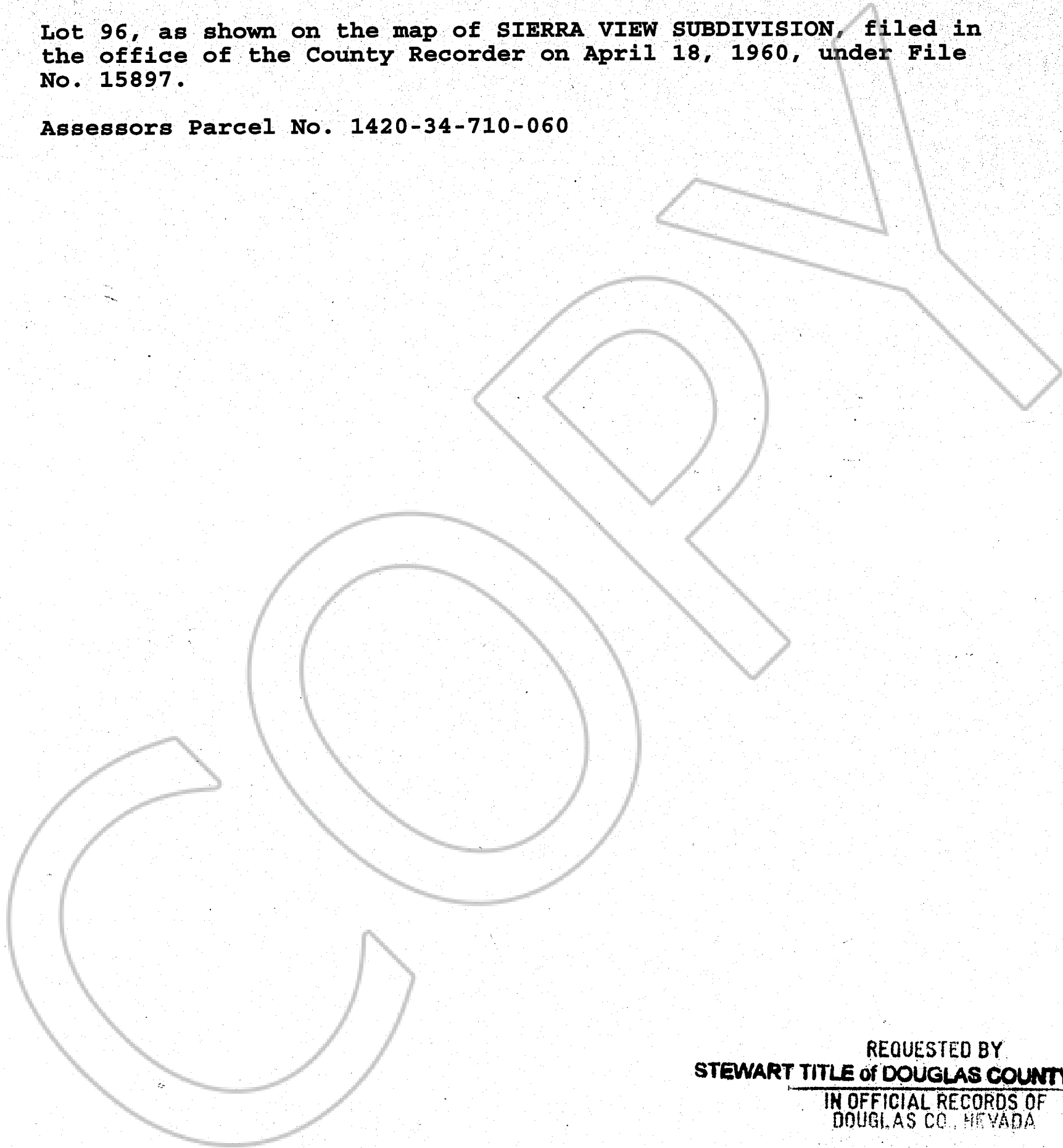

**REQUESTED BY
STEWART TITLE of DOUGLAS COUNTY**

**IN OFFICIAL RECORDS OF
DOUGLAS CO., NEVADA**

2001 SEP 26 PM 3:42

**LINDA SLATER
RECORDER**

\$ *800* PAID *BC* DEPUTY

**0523596
BK0901PG6547**