

GRANT, BARGAIN AND SALE DEED

APN: 1220-15-510-015
RPTT \$ 375.70

Full Value
 Full Value less liens

THIS INDENTURE WITNESSETH: That

FOR A VALUABLE CONSIDERATION, receipt of which is hereby acknowledged,
TERRY L. FOLEY and JANIS E. FOLEY, Husband and Wife

doe(es) hereby GRANT(s) BARGAIN SELL and CONVEY to
CHARLES FECTEAU JR. and WENDY FECTEAU, BOTH UNMARRIED PERSONS, as Joint Tenants

and to the heirs and assigns of such Grantee forever, all the following real property situated in the city _____ county of
Douglas, state of Nevada bounded and described as follows:
See Exhibit A attached hereto and made a part hereof.

TOGETHER with all tenements, hereditaments and appurtenances, if any, thereto belonging or appertaining, and any reversions, remainders, rents,
issues or profits thereof.

Dated: October 2, 2001

STATE OF ~~NEVADA~~ GEORGIA

COUNTY OF Cobb

} s.s.

Terry L. Foley
TERRY L. FOLEY

On OCTOBER 8 2001 personally
appeared before me, a Notary Public, TERRY L. FOLEY & JANIS E. FOLEY

Janis E. Foley
JANIS E. FOLEY

FUSWORTH G O'CONNOR

personally known or proved to me to be the person whose name is
subscribed to the above instrument who acknowledged that he
executed the instrument.

Signature

Fusworth G O'Connor

Notary Public, Cobb County, Georgia
My Commission Expires March 18, 2002

SEAL

(This area for official notarial seal)

SPACE BELOW THIS LINE FOR RECORDER'S USE

WHEN RECORDED MAIL TO:
Name **CHARLES F. FECTEAU JR.**
Street Address **P.O. BOX 594**
GARDNERVILLE, NV 89410
City, State
Zip

MAIL TAX STATEMENTS TO:
Name **CHARLES F. FECTEAU JR.**
Street Address **SAME AS ABOVE**
City, State
Zip

Order No. 00085262-201-CLH

0524846

BK 1001 PG 3368

06133910/2/01

All that real property situate in the County of Douglas, State of Nevada, described as follows:

PARCEL 1

Lot 14, as shown on the map of the Official Plat of GARDNERVILLE RANCHOS, filed in the office of the County Recorder of Douglas County, state of Nevada, on November 30, 1964, in Book 1 of Maps, Page 40, File No. 26665.

PARCEL 2

Together with an easement for ingress, egress and maintenance of drainage facilities over a portion of Lot 1 as shown on the Map of GARDNERVILLE RANCHOS UNIT NO. 3, recorded in the office of the Douglas County Recorder on June 4, 1965, as Document No. 28378, as reserved in Deed from C.E. SWIFT to WILLARD D. ATWELL and SAMMIE L. ATWELL, recorded July 21, 1975, in Book 1275, Page 588, as Document No. 81717 Official Records, Douglas County, Nevada, described as follows:

Beginning at the most Southerly corner of said Lot 1;
thence North 43°00'30" East, 121.95 feet to a point;
thence in a Northwesterly direction, 152 feet more or less to a point on the Easterly side of Riverview Drive, said point being 146 feet from the Southerly line of Fairway Drive;
thence South 43°00'30" West, to the Southwesterly corner of said Lot 1, which is also the subdivision boundary;
thence South 36°07'01" East, 152.74 feet to the Point Of Beginning.

A.P.N. 1220-15-510-015

NOTE (NRS 111.312): The above metes and bounds description appeared previously in that certain Deed of Trust, recorded in the office of the County Recorder of Douglas County, Nevada on March 10, 1995, in Book 395, Page 1332, as Document No. 357676, of Official Records.

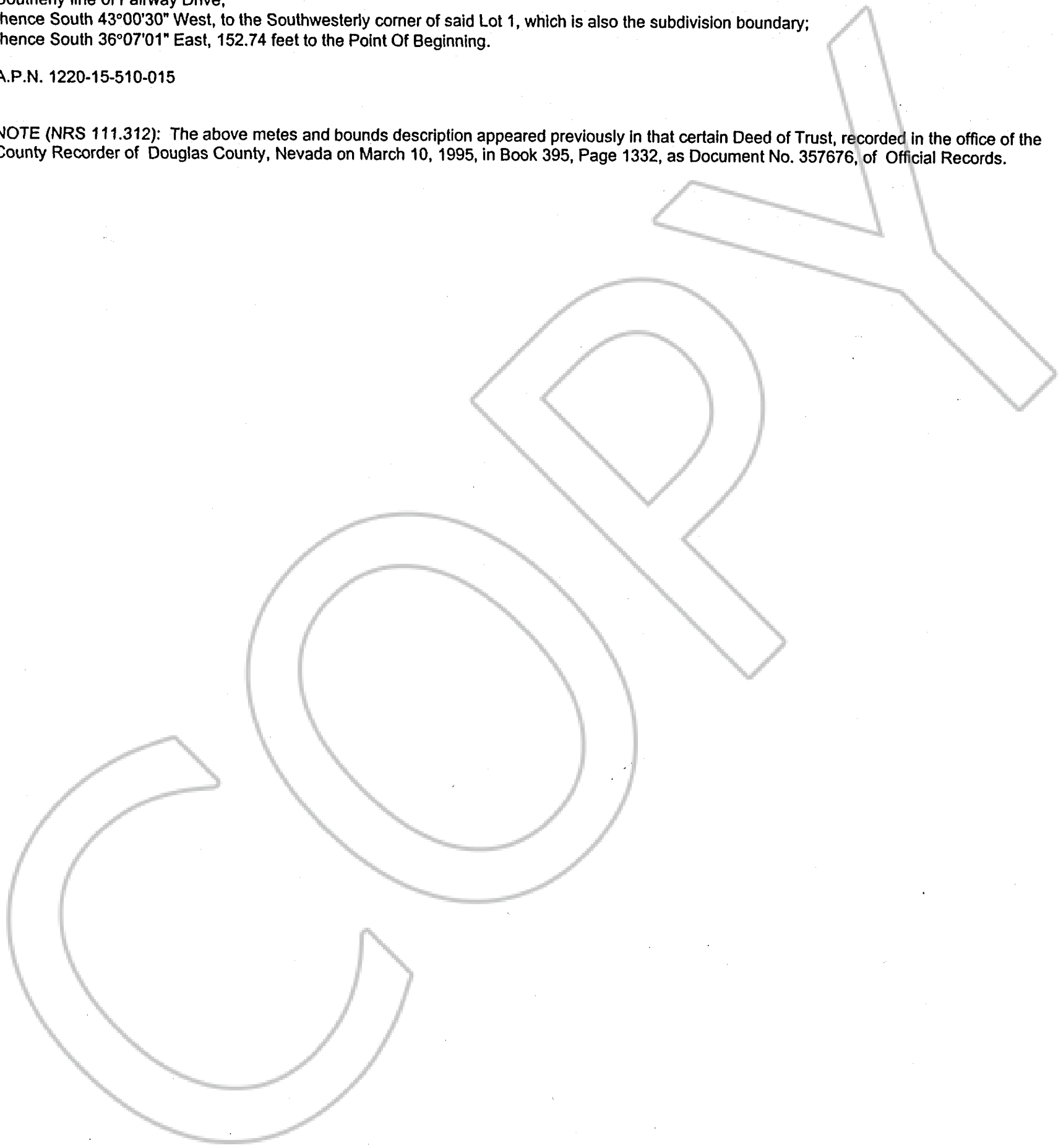

REQUESTED BY
WESTERN TITLE COMPANY, INC.

IN OFFICIAL RECORDS OF
DOUGLAS CO., NEVADA

2001 OCT 12 AM 10: 07

LINDA SLATER
RECORDER

\$15⁰⁰ PAID *Kg* DEPUTY

0524846
BK 1001 PG 3369