

LEGAL DESCRIPTION

The land referred to herein is situated in the State of Nevada, County of Douglas, described as follows:

All that certain lot, piece or parcel of land situate in the Northwest 1/4 of Section 32, Township 14 North, Range 20 East, M.D.B.&M., Douglas County, Nevada, further described as follows:

Parcel 25C, as set forth on the Parcel Map for FRANK PETRASICH, filed for record in the office of the County Recorder, Douglas County, Nevada on June 24, 1991, in Book 691, Page 3494, as Document No. 253524.

A.P.N. 1420-32-001-003

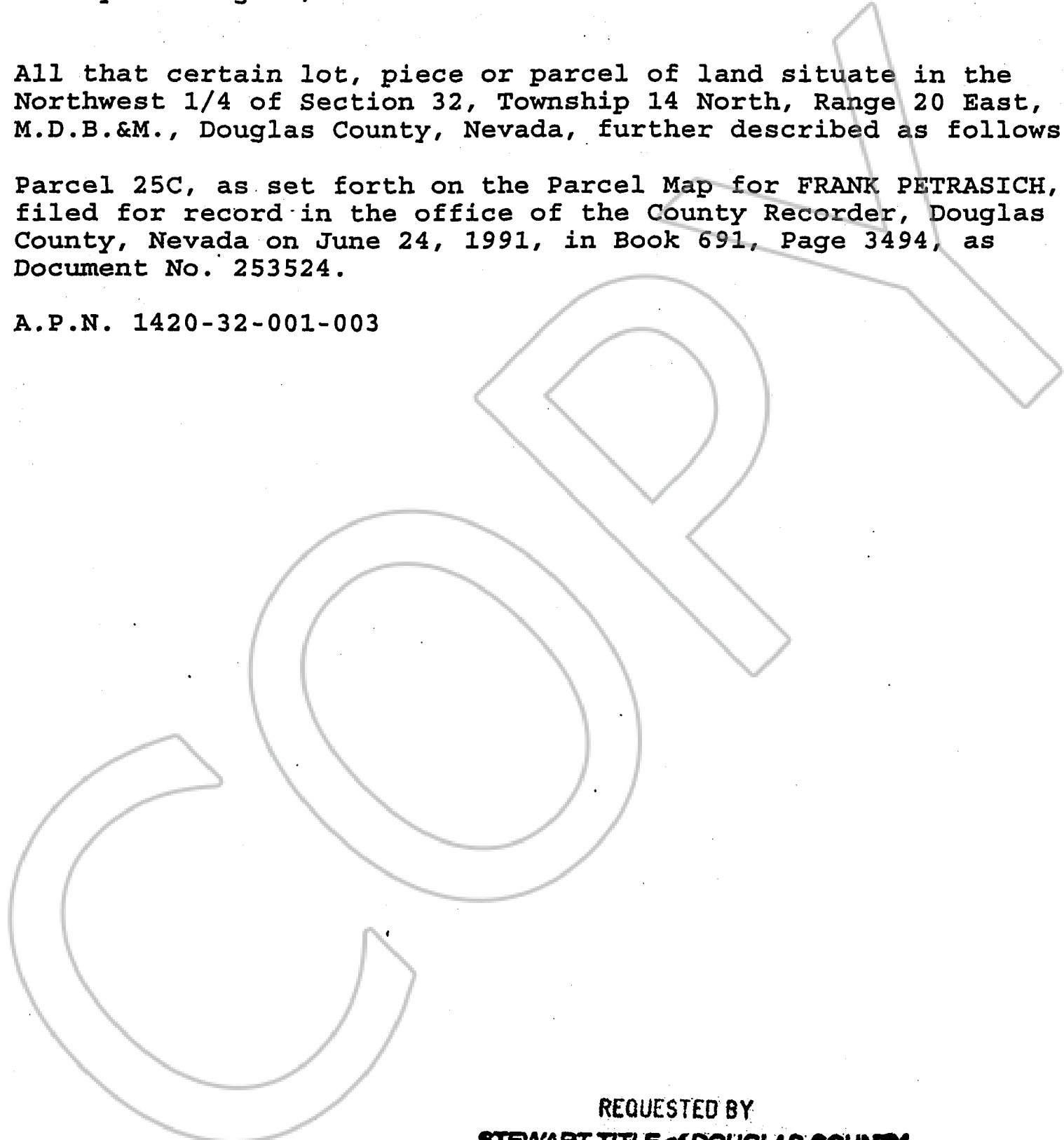

REQUESTED BY
STEWART TITLE of DOUGLAS COUNTY
IN OFFICIAL RECORDS OF
DOUGLAS CO., NEVADA

2001 OCT 15 AM 10:36

LINDA SLATER
RECORDER

\$15⁰⁰ PAID *kg* DEPUTY

STEWART TITLE
Guaranty Company