

NF
Comm Dev
Jerry Bowden

APPROVED 10/4/2001 #52
DOUGLAS COUNTY COMMISSIONERS MEETING
Recorded at the request of:
Douglas County, NV
C/o Community Development Department
Attn.: Mimi Moss

FILED
NO. 2001.276

'01 OCT 16 A8:26

BARBARA REED
BY *[Signature]* DEPUTY

ABANDONMENT: DA 01-066

AN ORDER OF ABANDONMENT VACATING A 30-FOOT PUBLIC ACCESS EASEMENT FROM EAST VALLEY TO SAWMILL AND A 50-FOOT WIDE PUBLIC ACCESS EASEMENT ALONG STILLWATER AND COTTONTAIL ROADS FROM THE INTERSECTION OF SAWMILL ROAD EAST ALONG STILLWATER AND NORTH ALONG COTTONTAIL.

WHEREAS Douglas County, a political subdivision of the State of Nevada, presently holds an easement interest within the Southwest ¼ of the Southeast ¼ of Section 26, Township 13 North, Range 20 East, M.D.B. & M., further described as a portion of Lot 9 & 10 as shown on that record of Survey Map, Document No. 51917, as modified by the realignment of East Valley Road as shown on that Record of Survey, Document No. 178318, both on file in the official records of Douglas County, Nevada, being more particularly described as follows:

The southerly 50-feet of the above-described portion of Lot 9, bounded easterly by the easterly line of Lot 9, said line being also the east line of said southwest ¼ of the southeast ¼ of Section 26, and bounded westerly by the westerly line of said Lot 9, said line being also the westerly line of said southeast ¼ of the southeast ¼ of Section 26.

The easterly 50-feet of the above-described portion of Lot 9, bounded northerly by the northerly line of Lot 9, and bounded southerly by the southerly line of said Lot 9, said line being also the southerly line of said southeast ¼ of the southeast ¼ of Section 26.

The southerly 30-feet of the above-described portion of Lot 10, bounded easterly by the easterly line of said southwest ¼ of the southeast ¼ of Section 26, and bounded westerly by said realignment of East Valley Road.

WHEREAS Douglas County, pursuant to the provisions of NRS 278.480 may vacate or abandon by formal order any portion of a public roadway which is in excess of its needs; and,

WHEREAS on September 11, 2001, the Douglas County Planning Commission held a public hearing in conformance with the provisions of NRS 278.240 to take testimony for said abandonment and did find that the release of the aforesaid described easement was not inconsistent with the Douglas County Master Plan; and,

WHEREAS on October 4, 2001, the Douglas County Board of Commissioners held a public hearing to take testimony for said abandonment and did find that the subject easement is in excess of the needs of Douglas County, and that the public will not be materially injured by the abandonment.

0525275

BK1001PG4967

NOW THEREFORE be it ordered by the Board of Douglas County Commissioners, that the aforesaid easements and incidents thereto, as described on the attached Legal Description, is hereby abandoned subject to the following condition and stipulation:

1. The abandonment shall be consistent with Sections 278.240 and 278.480 of the Nevada Revised Statutes.

DATED this 4 day of Oct., 2001.

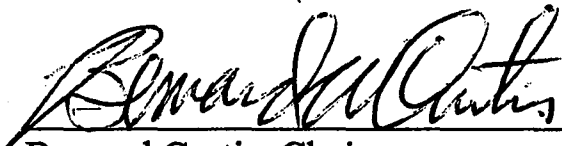

Bernard Curtis, Chairman
Douglas County Board of Commissioners

STATE OF NEVADA)
) ss.
COUNTY OF DOUGLAS)

On the 8 day of Oct., 2001, Bernard Curtis, Chairman of the Douglas County Board of Commissioners, personally appeared before me, Barbara J. Reed, Douglas County Clerk, and acknowledged to me, that in conformance with the direction of the Board of Douglas County Commissioners meeting of October 4, 2001, he executed the above instrument on behalf of Douglas County, a political subdivision of the State of Nevada.



Barbara J. Reed, Douglas County Clerk

BY:  DEPUTY

0525275
BK 1001 PG 4968

EXHIBIT

LEGAL DESCRIPTION

EASEMENT ABANDONMENT

All that certain real property situate in the southwest $\frac{1}{4}$ of the southeast $\frac{1}{4}$ of Section 26, Township 13 North, Range 20 East, M.D.M., further described as a portion of Lot 9 as shown on that Record of Survey Map, Document No. 51917, Official Records of Douglas County, Nevada, being more particularly described as follows:

The easterly 50 feet of the above-described Lot 9, bounded northerly by the northerly line of said Lot 9, and bounded southerly by the southerly line of said Lot 9, said line being also the southerly line of said southeast $\frac{1}{4}$ of the southeast $\frac{1}{4}$ of Section 26.

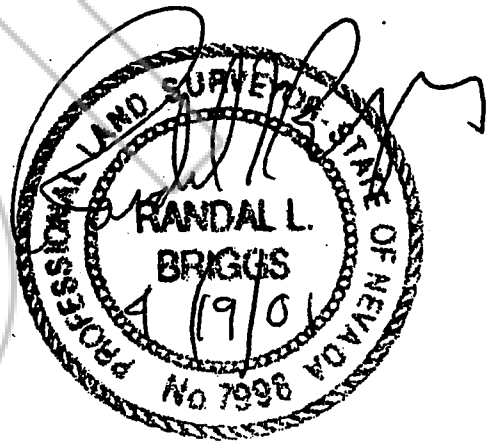

EXHIBIT

LEGAL DESCRIPTION

EASEMENT ABANDONMENT

All that certain real property situate in the southwest $\frac{1}{4}$ of the southeast $\frac{1}{4}$ of Section 26, Township 13 North, Range 20 East, M.D.M., further described as a portion of Lot 9 as shown on that Record of Survey Map, Document No. 51917, Official Records of Douglas County, Nevada, being more particularly described as follows:

The southerly 50 feet of the above-described Lot 9, bounded easterly by the easterly line of said Lot 9, said line being also the east line of said southeast $\frac{1}{4}$ of the southeast $\frac{1}{4}$ of Section 26, and bounded westerly by the westerly line of said Lot 9, said line being also the westerly line of said southeast $\frac{1}{4}$ of the southeast $\frac{1}{4}$ of Section 26.

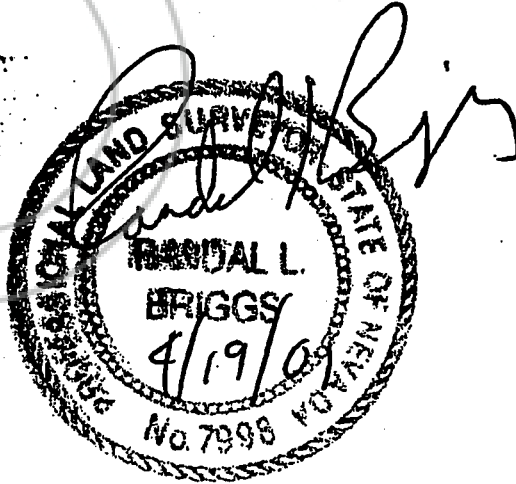

EXHIBIT

LEGAL DESCRIPTION

EASEMENT ABANDONMENT

All that certain real property situate in the southwest $\frac{1}{4}$ of the southeast $\frac{1}{4}$ of Section 26, Township 13 North, Range 20 East, M.D.M., further described as a portion of Lot 10 as shown on that Record of Survey Map, Document No. 51917, as modified by the realignment of East Valley Road as shown on that Record of Survey, Document No. 178318, both on file in the Official Records of Douglas County, Nevada, being more particularly described as follows:

The southerly 30 feet of the above-described portion of Lot 10, bounded easterly by the easterly line of said portion of Lot 10, said line being also the easterly line of said southwest $\frac{1}{4}$ of the southeast $\frac{1}{4}$ of Section 26, and bounded westerly by said realignment of East Valley Road.

Prepared by
DAVID L. BRATCHER
LUMOS & ASSOC.
800 E. College Pkwy.
Carson City, NV 89706

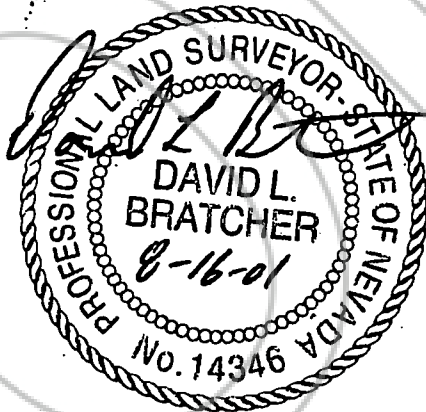

BK1001PG4972
0525275

SURVEYORS CERTIFICATE

PREPARED UNDER THE SUPERVISION OF
RANDAL L. BRIGGS, PLS 7998.

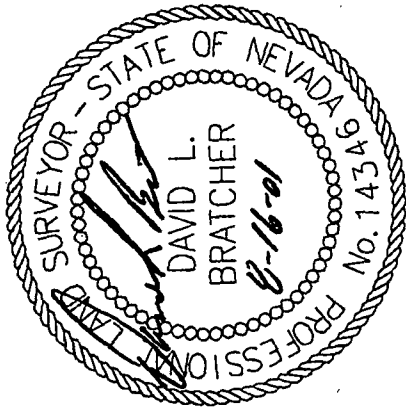

APN 1320-26-002-012
GARREN, RICHARD M. & SANDRA D.

APN 1320-26-002-014
BARNETT, MARK A & S A

APN 1320-26-002-006
EASTSIDE MEMORIAL PARK INC.

EXISTING 30' EASEMENT
N 89°27'01" W 1338.84'

AMBER WAY
N 89°27'01" W 1228.26'

EXISTING 50' EASEMENT

EXISTING 80'
ROADWAY
EASEMENT

EXISTING 30' PUE
EXISTING 30' PUE

N 01°11'20" E 1338.25'

WHITE RABBIT ASSOCIATES
APN 1320-26-002-016
(MODIFIED LOT 10)

WHITE RABBIT ASSOCIATES
LOT 9

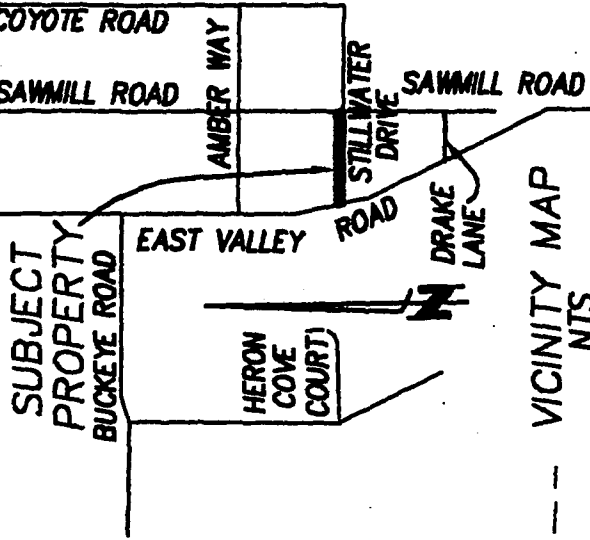

VICINITY MAP
NTS

EXISTING 50' EASEMENT
TO BE ABANDONED
PER SEPARATE DOCUMENT

N 89°59'30" W 1332.06'

APN 1320-35-001-036
BULLARD, SALLY ANN

EXISTING 50' EASEMENT

SAWMILL ROAD

APN 1320-35-001-035
MARTINEZ, LAWRENCE & B ET AL

N 89°59'30" W 1200.24'

SCALE: 1" = 300'

EAST

VALLEY

L=470.46'
R=2000.00'
A=13°28'40"
tan=236.32'

ROAD N 12°34'02" W
329.37'

REFERENCES

- (A) RECORD OF SURVEY FOR NEVIS INDUSTRIES, INC., FILED FOR RECORD DECEMBER 23, 1980, BK. 1280, PG.1510, OFFICIAL RECORDS OF DOUGLAS COUNTY, NEVADA, DOCUMENT NO. 51917.
- (B) RECORD OF SURVEY TO SUPPORT LOT LINE ADJUSTMENTS, FILED FOR RECORD MAY 18, 1988, BK. 588, PG. 2532, OFFICIAL RECORDS OF DOUGLAS COUNTY, NEVADA, DOCUMENT NO. 178318.

MAP TO ACCOMPANY
AN
EASEMENT ABANDONMENT
FOR

APN 1320-26-002-016

A PORTION OF THE SE 1/4 SECTION 26, T. 13N., R. 20 E., M.D.M.
DOUGLAS COUNTY, NEVADA

JOB NO. 5249-000

BK1001PG4973
0525275

EXISTING 30' EASEMENT
N 89°27'01" W 1338.84'

APN 1320-26-002-006
EASTSIDE MEMORIAL PARK INC.

APN 1320-26-002-012
GARRIN, RICHARD M. & SANDRA D.

EXISTING
50' EASEMENT

N 89°27'01" W

1228.26' AMBER WAY

EXISTING 50' EASEMENT

SCALE : 1" = 300'

WHITE RABBIT ASSOCIATES
APN 1320-26-002-016
(MODIFIED LOT 10)

EXISTING 30' PUE

WHITE RABBIT ASSOCIATES
LOT 9

EXISTING 30' PUE

EXISTING 50' EASEMENT -
ACCESS EASEMENT TO BE ABANDONED,
PER SEPARATE DOCUMENT,
PUBLIC UTILITY EASEMENT TO REMAIN

N 01°41'20" E
1338.25'

EXISTING 30' PUE
TO BE ABANDONED PER
SEPARATE DOCUMENT

N 89°59'30" W 1200.24'

EXISTING 30' PUE

APN 1320-35-001-035
MARTINEZ, LAWRENCE & B ET AL

N 89°59'30" W 1332.06'

APN 1320-35-001-036
BULLARD, SALLY ANN

EXISTING 50' EASEMENT

SAWMILL ROAD

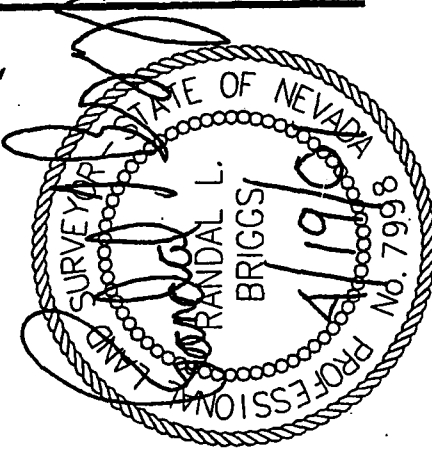

SURVEYORS CERTIFICATE

PREPARED UNDER THE SUPERVISION OF
RANDAL L. BRIGGS, PLS 7998.

N 00°34'49" E 1331.94'
APN 1320-25-002-005
BLM

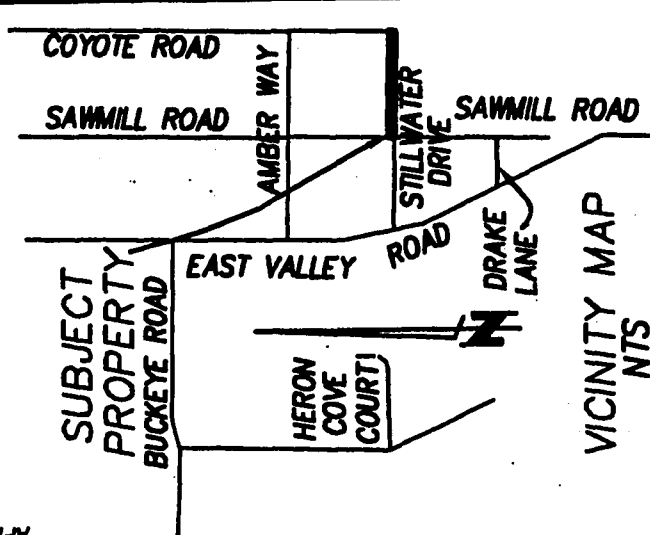

VICINITY MAP
NTS

MAP TO ACCOMPANY
AN
EASEMENT ABANDONMENT
FOR

REFERENCES

- (A) RECORD OF SURVEY FOR NEVIS INDUSTRIES, INC.,
FILED FOR RECORD DECEMBER 23, 1980, BK. 1280, PG.1510,
OFFICIAL RECORDS OF DOUGLAS COUNTY, NEVADA,
DOCUMENT NO. 51917.

APN 1320-26-002-015

A PORTION OF THE SE 1/4 SECTION 26, T. 13N., R. 20 E., M.D.M.
DOUGLAS COUNTY, NEVADA

JOB NO. 5249-000

BK 1001 PG 4974
0525275

SURVEYORS CERTIFICATE
PREPARED UNDER THE SUPERVISION OF
RANDAL L. BRIGGS, PLS 7998.

EXISTING 30' EASEMENT
N 89°27'01" W 1338.84'

APN 1320-26-002-012
GARREN, RICHARD M. & SANDRA D.
EXISTING 50' EASEMENT

EXISTING 50' EASEMENT

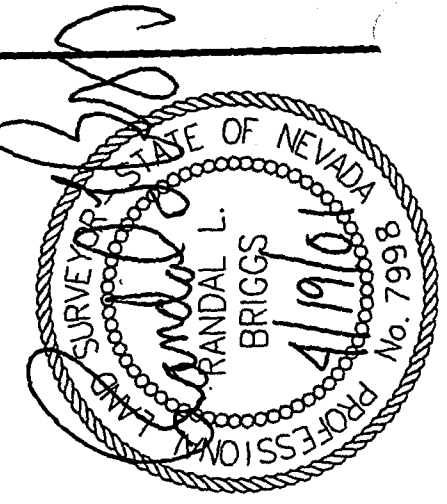

N 89°27'01" W 1200.24'

APN 1320-26-002-016
BARNETT, MARK A & S A

EXISTING 30' PUE

EXISTING 50' EASEMENT

EXISTING 50' EASEMENT -
ACCESS EASEMENT ABANDONED
PER THIS DOCUMENT
(PUBLIC UTILITY EASEMENT TO REMAIN)

EXISTING 50' EASEMENT
TO BE ABANDONED
PER SEPARATE DOCUMENT

SCALE: 1" = 300'

WHITE RABBIT ASSOCIATES
APN 1320-26-002-016
(MODIFIED LOT 10)

WHITE RABBIT ASSOCIATES
LOT 9

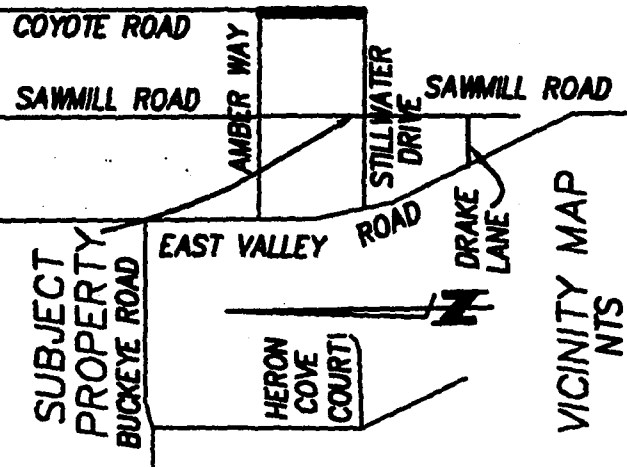

VICINITY MAP
NTS

N 89°59'30" W 1200.24'

APN 1320-35-001-035
MARTINEZ, LAWRENCE & B ET AL

EXISTING 50' EASEMENT

N 89°59'30" W 1332.00'

APN 1320-35-001-036
BULLARD, SALLY ANN

EXISTING 50' EASEMENT

EXISTING 50' EASEMENT

EXISTING 50' EASEMENT

EXISTING 50' EASEMENT

EXISTING 50' EASEMENT

MAP TO ACCOMPANY
AN
EASEMENT ABANDONMENT
FOR

REFERENCES

- (A) RECORD OF SURVEY FOR NEVIS INDUSTRIES, INC., FILED FOR RECORD DECEMBER 23, 1980, BK. 1280, PG.1510, OFFICIAL RECORDS OF DOUGLAS COUNTY, NEVADA, DOCUMENT NO. 51917.

APN 1320-26-002-015

A PORTION OF THE SE 1/4 SECTION 26, T. 13N., R. 20 E., M.D.M. DOUGLAS COUNTY, NEVADA JOB NO. 5249-000

COPY

REQUESTED BY
DOUGLAS COUNTY
IN OFFICIAL RECORDS OF
DOUGLAS CO., NEVADA

2001 OCT 16 PM 12: 14

LINDA SLATER
RECORDER

\$ 0 PAID KX DEPUTY

CERTIFIED COPY

The document to which this certificate is attached is a full, true and correct copy of the original on file and on record in my office.

DATE: October 16, 2001
Clerk of the 9th Judicial District Court
of the State of Nevada, in and for the County of Douglas.

By [Signature] Deputy

SEAL

0525275
BK 1001 PG 4975

0525275
BK 1001 PG 4975