

RECORDING REQUESTED BY:
STEWART TITLE COMPANY
WHEN RECORDED MAIL TO:
MAIL TAX STATEMENTS TO:

GRANTEE
701 IVY STREET
CARSON CITY, NV. 89703

R.P.T.T. \$ 6.50
ESCROW NO. 01022342
Full Value 010502652

GRANT, BARGAIN, SALE DEED

THIS INDENTURE WITNESSETH: That
LYMAN GEORGE EDWARD MCKAY AND MARJORIE EVELYN MCKAY AS TRUSTEES
OF THE MCKAY FAMILY TRUST DATED JUNE 14, 1982

in consideration of \$10.00, the receipt of which is hereby acknowledged, does hereby Grant, Bargain Sell and Convey to
GEORGE MITCHELL and AIDA MITCHELL, HUSBAND AND WIFE AS JOINT TENANTS

and to the heirs and assigns of such Grantee forever, all that real property situated in the City of **GARDNERVILLE**
County of **DOUGLAS** State of Nevada, bounded and described as follows:
SEE EXHIBIT "A" ATTACHED HERETO AND MADE A PART HEREOF

Together with all and singular the tenements, hereditaments and appurtenances thereunto belonging or in anywise
appertaining, and any reversions, remainders, rents, issues or profits thereof.

DATE: October 11, 2001

THE MCKAY FAMILY TRUST
DATED JUNE 14, 1982

BY: Lyman George Edward McKay
LYMAN GEORGE EDWARD MCKAY
TRUSTEE

BY: Marjorie Evelyn McKay
MARJORIE EVELYN MCKAY
TRUSTEE

STATE OF _____
COUNTY OF _____ ss.

*See Attached California
all-Purpose Acknowledgment*

This instrument was acknowledged before me on _____
by, LYMAN GEORGE EDWARD MCKAY and
MARJORIE EVELYN MCKAY

Signature _____
Notary Public

0525586
BK1001PG6113

CALIFORNIA ALL-PURPOSE ACKNOWLEDGMENT

State of California

County of

San Diego

} ss.

On

10-12-01

Date

, before me,

Marjorie Evelyn McKay and
Lyman George Edward McKay

Name and Title of Officer (e.g., "Jane Doe, Notary Public")

personally appeared

Yvette L. Prather, Notary

Name(s) of Signer(s)

- personally known to me
- proved to me on the basis of satisfactory evidence

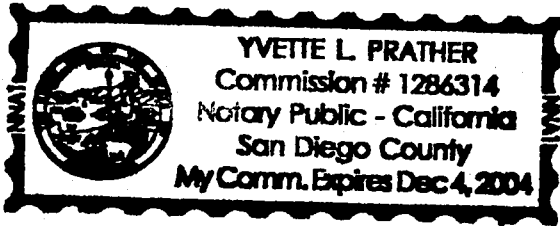

to be the person(s) whose name(s) is/are subscribed to the within instrument and acknowledged to me that he/she/they executed the same in his/her/their authorized capacity(ies), and that by his/her/their signature(s) on the instrument the person(s), or the entity upon behalf of which the person(s) acted, executed the instrument.

WITNESS my hand and official seal.

Yvette L. Prather

Signature of Notary Public

Place Notary Seal Above

OPTIONAL

Though the information below is not required by law, it may prove valuable to persons relying on the document and could prevent fraudulent removal and reattachment of this form to another document.

Description of Attached Document

Title or Type of Document:

Certificate of Trust

Document Date:

Number of Pages:

1

Signer(s) Other Than Named Above:

Capacity(ies) Claimed by Signer

Signer's Name:

- Individual
- Corporate Officer — Title(s): _____
- Partner — Limited General
- Attorney in Fact
- Trustee
- Guardian or Conservator
- Other: _____

RIGHT THUMBPRINT OF SIGNER

Top of thumb here

Signer Is Representing:

0525586
BK 1001 PG 6114

LEGAL DESCRIPTION

The land referred to herein is situated in the State of Nevada, County of Douglas, described as follows:

Lot 22, as shown on the Amended Map of TOPAZ LODGE SUBDIVISION, FIRST AND SECOND SECTIONS, filed in the office of the County Recorder of Douglas County, State of Nevada, on September 16, 1958, under File No. 13594.

Assessor's Parcel No. 1022-29-411-006.

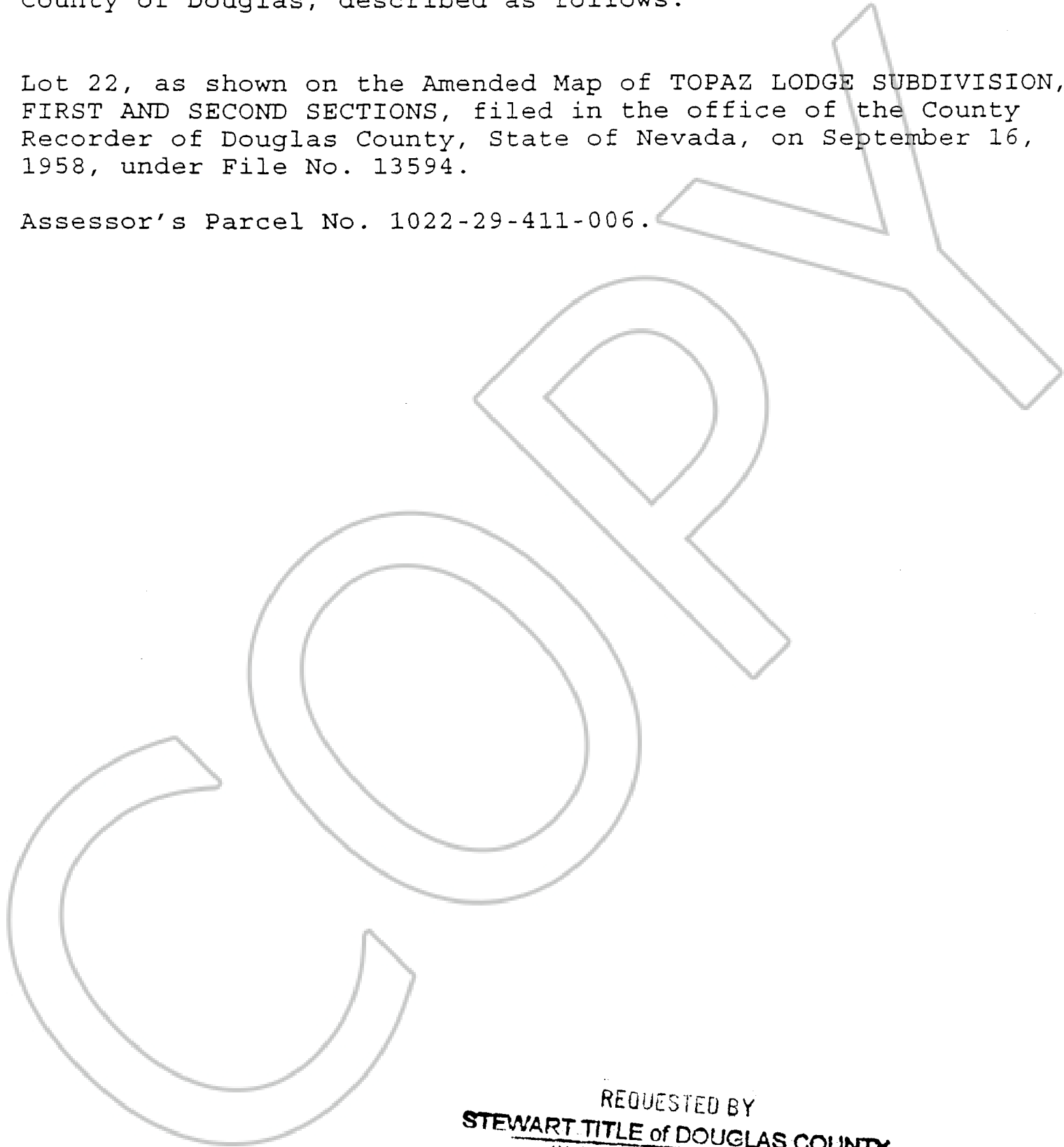

REQUESTED BY
STEWART TITLE of DOUGLAS COUNTY
IN OFFICIAL RECORDS OF
DOUGLAS CO., NEVADA

2001 OCT 18 PM 3:48

LINDA SLATER
RECORDER

\$ 16.00 PAID BC DEPUTY

STEWART TITLE
Guaranty Company

0525586

BK1001PG6115