

DESCRIPTION OF ADJUSTED PARCEL 3A, REFLECTING A BOUNDARY LINE ADJUSTMENT, BEING A PORTION OF THE W 1/2 OF SECTION 30, T.14N., R.20E., M.D.B. & M., DOUGLAS COUNTY, NEVADA AND BEING MORE PARTICULARLY DESCRIBED AS FOLLOWS:

COMMENCING AT THE NORTHWEST CORNER OF SAID SECTION 30; THENCE S 00°44'27" W, 420.00 FEET; THENCE S 89°15'11" E 1548.72 FEET TO THE **TRUE POINT OF BEGINNING**; THENCE S 89°15'11" E, 671.62 FEET; THENCE S 33°27'12" E 102.77 FEET; THENCE S 00°37'25" W 1251.97 FEET; THENCE N 68°16'53" W 783.89 FEET; THENCE N 00°44'27" E 1056.40 FEET TO THE **TRUE POINT OF BEGINNING**.

CONTAINING 20.01 ACRES, MORE, OR LESS.

BASIS OF BEARINGS: THE BASIS OF BEARINGS IS THE WEST LINE OF PARCEL 2A-1 AS SHOWN ON RECORD OF SURVEY MAP 433854, DOUGLAS COUNTY, NEVADA.

(N 00°44'27" E)

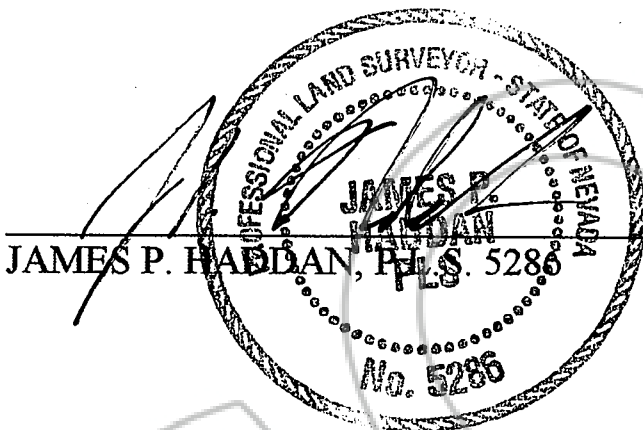

JAMES P. HADDAN, PLS. 5286

10/25/01
(Date)

0526807
BK 1101PG0226

DESCRIPTION OF ADJUSTED PARCEL 4A, REFLECTING A BOUNDARY LINE ADJUSTMENT, BEING A PORTION OF THE WEST 1/2 OF SECTION 30, T.14N., R.20E., M.D.B. & M., DOUGLAS COUNTY, NEVADA AND BEING MORE PARTICULARLY DESCRIBED AS FOLLOWS:

COMMENCING AT THE NORTHWEST CORNER OF SAID SECTION 30; THENCE S 00°44'27" W, 420.00 FEET TO THE TRUE POINT OF BEGINNING; THENCE S 89°15'11" E, 1548.72 FEET; THENCE S 00°44'27" W, 1056.40 FEET; THENCE S 68°16'53" E, 783.89 FEET; THENCE S 00°37'25" W, 937.13 FEET; THENCE N 89°22'35" W, 1096.30 FEET; THENCE N 12°49'33" W, 313.70 FEET; THENCE N 03°47'47" E, 264.69 FEET; THENCE N 33°49'23" E, 114.16 FEET; THENCE N 50°39'15" W 39.84 FEET; THENCE N 54°30'06" W, 146.63 FEET; THENCE N 82°25'26" W, 95.33 FEET; THENCE N 68°29'52" W, 100.44 FEET; THENCE N 48°28'02" W, 119.77 FEET; THENCE N 72°42'56" W, 163.47 FEET; THENCE S 87°09'40" W, 87.51 FEET; THENCE S 78°36'48" W, 144.04 FEET; THENCE N 72°00'17" W, 194.29 FEET; THENCE N 73°17'39" W 111.34 FEET; THENCE N 80°53'27" W, 89.71 FEET; THENCE N 00°44'27" E 1148.69 FEET TO THE TRUE POINT OF BEGINNING.

CONTAINING 72.53 ACRES, MORE, OR LESS.

BASIS OF BEARINGS: THE BASIS OF BEARINGS IS THE WEST LINE OF PARCEL 2A-1 AS SHOWN ON RECORD OF SURVEY MAP 433854, DOUGLAS COUNTY, NEVADA.
(N 00°44'27" E)

J.P.
JAMES P. HADIBAN, P.L.S. No. 5286
PRESIDENTIAL LAND SURVEYOR - STATE OF NEVADA
JAMES P. HADIBAN, P.L.S.
No. 5286

10/25/01
(Date)

REQUESTED BY
STEWART TITLE & DOUGLAS COUNTY
IN OFFICIAL RECORDS OF
DOUGLAS CO., NEVADA

2001 NOV -1 PM 3: 54

LINDA SLATER
RECORDER

\$ *10.00* PAID *BC* DEPUTY

0526807

BK 1101 PG 0227