

Line Table

LINE	BEARING	DISTANCE
L1	N 56°04'58" E	69.60'
L2	N 89°48'06" W	9.12'

Curve Table

CURVE	LENGTH	RADIUS	DELTA	TANGENT
C1	20.26'	3025.00'	00°23'01"	10.13'

Owner's Certificate

WE, JOHN & ANDRAE JO (JODY) LAXAGUE, CERTIFY THAT WE ARE THE LEGAL OWNERS OF THIS PARCEL AND DO HEREBY GRANT PERMANENT EASEMENTS FOR UTILITY INSTALLATION AS DESIGNATED ON THIS MAP, AND CONSENT TO THE PREPARATION AND RECORDING OF THIS MAP.

John Laxague
JOHN LAXAGUE
Andrae Jo (Jody) Laxague
ANDRAE JO (JODY) LAXAGUE

STATE OF Nevada S.S.
COUNTY OF Douglas

ON THIS 25th DAY OF October, 2001, PERSONALLY APPEARED BEFORE ME, A NOTARY PUBLIC, JOHN LAXAGUE, PERSONALLY KNOWN (OR PROVED) TO ME TO BE THE PERSON WHOSE NAME IS SUBSCRIBED TO THE ABOVE INSTRUMENT WHO ACKNOWLEDGED HE EXECUTED IT.

Janice K Condon
NOTARY PUBLIC
STATE OF Nevada
COUNTY OF Douglas S.S.



ON THIS 25th DAY OF October, 2001, PERSONALLY APPEARED BEFORE ME, A NOTARY PUBLIC, ANDRAE JO (JODY) LAXAGUE, PERSONALLY KNOWN (OR PROVED) TO ME TO BE THE PERSON WHOSE NAME IS SUBSCRIBED TO THE ABOVE INSTRUMENT WHO ACKNOWLEDGED HE EXECUTED IT.

Janice K Condon
NOTARY PUBLIC

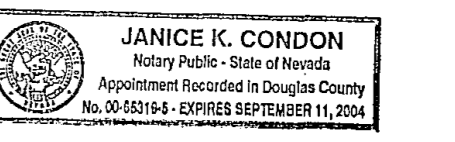

Surveyor's Certificate

I, DARRYL M. HARRIS, A PROFESSIONAL LAND SURVEYOR LICENSED IN THE STATE OF NEVADA, CERTIFY THAT:

- THIS PLAT REPRESENTS THE RESULTS OF A SURVEY CONDUCTED UNDER MY DIRECT SUPERVISION AT THE INSTANCE OF JOHN & ANDRAE JO (JODY) LAXAGUE.
- THE LAND SURVEYED LIES WITHIN A PORTION OF SECTION 34, T.13 N., R.20 E., M.D.M., AND THE SURVEY WAS COMPLETED ON SEPTEMBER 28, 2001.
- THIS PLAT COMPLIES WITH THE APPLICABLE STATE STATUTES AND ANY LOCAL ORDINANCE IN EFFECT ON THE DATE THAT THE GOVERNING BODY GAVE ITS FINAL APPROVAL.
- THE MONUMENTS DEPICTED ON THE PLAT ARE OF THE CHARACTER SHOWN, OCCUPY THE POSITIONS INDICATED AND ARE OF SUFFICIENT NUMBER AND DURABILITY.

Darryl M. Harris
DARRYL M. HARRIS
PROFESSIONAL LAND SURVEYOR
STATE OF NEVADA
No. 6497
10-19-01

Recorder's Certificate

FILED FOR RECORD THIS 14th DAY OF November, 2001, AT 9 MINUTES PAST 4 O'CLOCK P.M., IN BOOK 1101 OF OFFICIAL RECORDS, AT PAGE 4274; DOCUMENT NO. 527108. RECORDED AT THE REQUEST OF JOHN LAXAGUE.

Carol M. McCulloch
CAROL M. McCULLOCH
CHIEF DEPUTY
DOUGLAS COUNTY RECORDER

FINAL PARCEL MAP (LDA 01-054)
FOR
John & Andrae Jo (Jody) Laxague
PORTION OF THE WEST 1/2 OF SECTION 34
T. 13 N., R. 20 E., M.D.M.
DOUGLAS COUNTY, NEVADA

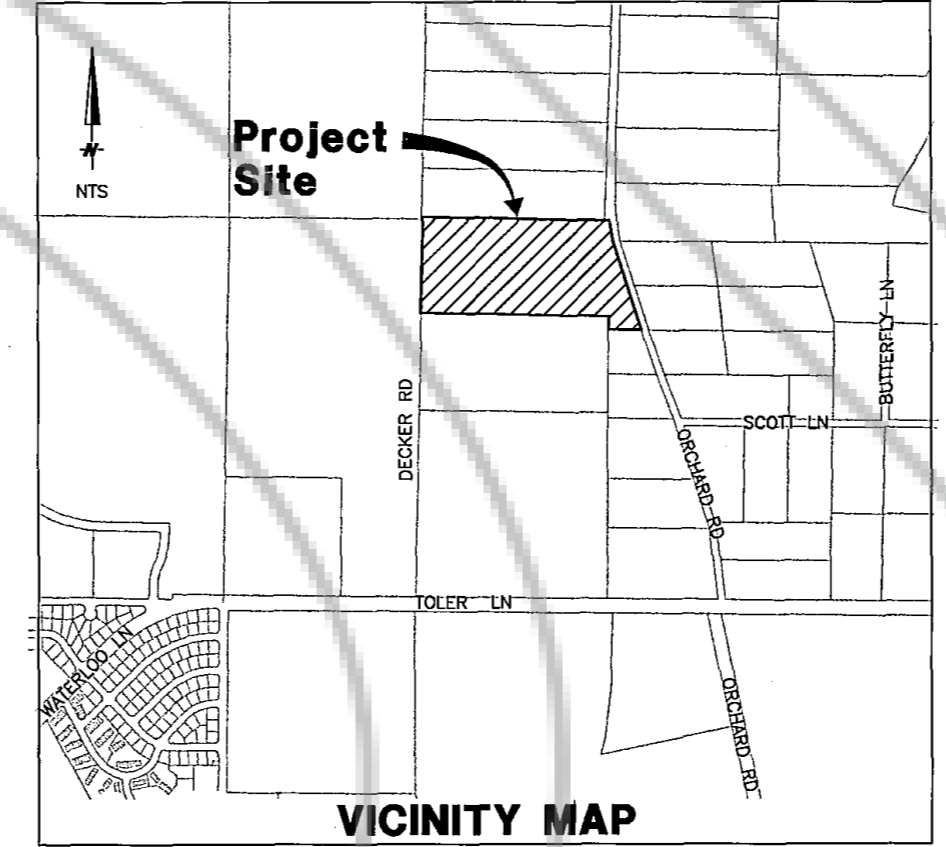

County Tax Collector's Certificate

I, BARBARA J. REED, DOUGLAS COUNTY CLERK-TREASURER AND EX-OFFICIO TAX COLLECTOR, DO HEREBY CERTIFY THAT ALL PROPERTY TAXES ON THIS LAND FOR THE FISCAL YEAR HAVE BEEN PAID. *As taxes paid 11/14/01*

Barbara J. Reed
BARBARA J. REED
DOUGLAS COUNTY CLERK-TREASURER
DATE 11/14/01

Community Development Department Certificate

IT IS HEREBY CERTIFIED THAT THIS PLAT WAS REVIEWED AND APPROVED BY THE DOUGLAS COUNTY DEPARTMENT OF COMMUNITY DEVELOPMENT ON THE 14th DAY OF November, 2001. THIS PLAT IS IN SUBSTANTIAL CONFORMANCE WITH THE TENTATIVE MAP AND ALL CONDITIONS OF APPROVAL HAVE BEEN SATISFIED. IN ADDITION, ALL OFFERS OF DEDICATION FOR ALL PUBLIC ROADWAYS AND OTHER PUBLIC USES WERE REJECTED WITH THE RESERVATION TO ACCEPT SAID OFFERS AT A LATER DATE.

Michelle Moss
MICHELLE MOSS
PLANNING/ECONOMIC DEVELOPMENT MANAGER
DATE 11-09-01

County Engineer's Certificate

I, ERIC M. TEITELMAN, DOUGLAS COUNTY ENGINEER, DO HEREBY CERTIFY THAT I HAVE EXAMINED THIS MAP, AND ALL PHYSICAL IMPROVEMENTS AS REQUIRED BY THE PARCEL MAP REGULATIONS HAVE BEEN COMPLETED, AND I AM SATISFIED THAT THIS MAP IS TECHNICALLY CORRECT.

Eric M. Teitelman
ERIC M. TEITELMAN, P.E.
DOUGLAS COUNTY ENGINEER
DATE 11/5/01

County Clerk's Certificate

IT IS HEREBY CERTIFIED THAT THIS PLAT WAS PRESENTED TO THE DEPARTMENT OF COMMUNITY DEVELOPMENT ON THE 9th DAY OF November, 2001, AND WAS DULY APPROVED. IN ADDITION ALL OFFERS OF DEDICATION FOR PUBLIC ROADWAYS AND OTHER PUBLIC USES WERE REJECTED WITH THE RESERVATION TO ACCEPT SAID OFFERS AT A LATER DATE.

Barbara J. Reed
BARBARA J. REED
COUNTY CLERK
DATE 11-9-01

Title Certificate

THIS IS TO CERTIFY THAT THE PARTIES AS LISTED WITHIN THE OWNERS CERTIFICATE ARE THE ONLY PARTIES OF RECORD HAVING INTEREST IN THE TRACTS OF LAND EMBRACED WITHIN THE GRAPHIC BORDER SHOWN ON THIS PLAT. THE FOLLOWING IS A COMPLETE LIST OF LIEN AND/OR HOLDERS OF RECORD.

Janice K Condon
STEWART TITLE
DATE 9-20-2001

Utility Companies' Certificate

WE, THE UNDERSIGNED PUBLIC UTILITIES, ACCEPT AND APPROVE THE PUBLIC UTILITY EASEMENT AS SHOWN ON THIS PLAT. THIS APPROVAL DOES NOT GUARANTEE ACCESSIBILITY FOR SERVICE.

Michael Price
MICHAEL PRICE
SIERRA PACIFIC POWER COMPANY
DATE 10-24-01
Ladonna K. Fesler
LADONNA K. FESLER
VERIZON
DATE 10-24-01

Legend:

- FND POINT AS INDICATED.
- SET 5/8" REBAR W/CAP PLS 6497
- CALCULATED POSITION (NOTHING SET)

Notes:

- THERE IS A 7.5' PUBLIC UTILITY EASEMENT ALONG ALL ROAD FRONTAGES AND A 5' PUBLIC UTILITY EASEMENT ALONG ALL OTHER LOT LINES.
- ANY FURTHER DIVISION OF THESE PARCELS MAY BE SUBJECT TO SUBDIVISION IMPROVEMENTS AS PROVIDED UNDER NRS 278.462(3).
- DOUGLAS COUNTY DOES NOT INSURE THE DEVELOPMENT OF ANY LOT WHERE WELLS AND SEPTIC SYSTEMS ARE REQUIRED FOR WATER AND SEWER SERVICE.
- THE USE OF AN INDIVIDUAL SEWAGE DISPOSAL SYSTEM IS FOR TEMPORARY USE ONLY. THE PARCELS SHALL CONNECT TO A COMMUNITY SEWER SYSTEM WHEN SUCH SYSTEM IS WITHIN 330 FEET OF THE PARCELS.
- MAINTENANCE OF ALL DRAINAGE FACILITIES AND EASEMENTS SHALL BE THE RESPONSIBILITY OF THE INDIVIDUAL PROPERTY OWNERS OR OTHER PRIVATE ENTITY, INCLUDING A HOMEOWNER'S ASSOCIATION. DOUGLAS COUNTY REJECTS ANY OFFER OF DEDICATION OF DRAINAGE FACILITIES OR DRAINAGE EASEMENTS.
- OBSTRUCTING THE FLOW OR ALTERING THE COURSE OF A DRAINAGE CHANNEL IS PROHIBITED.
- TOTAL AREA SURVEYED IS 21.818 ACRES.

Basis of Bearing:

THE SOUTH LINE OF THE LAXAGUE PARCEL AS SHOWN ON THE RECORD OF SURVEY FOR JOHN AND JODY LAXAGUE, DOCUMENT #142028, OF THE DOUGLAS COUNTY RECORDER'S OFFICE (N. 89°48'06" W.)

ENGINEERING • PLANNING • RESOURCE MANAGEMENT
RESOURCE CONCEPTS, INC.
340 N. MINNESOTA STREET • CARSON CITY, NEVADA 89703-4152 • OFFICE: 775-883-1600 • FAX: 775-883-1656 • WEB SITE: WWW.RCI-NV.COM

DATE	REVISION

JOB NO. 01-069-01
DATE 10/19/01
DRAWN RES
CHECKED
SHEET 1 OF 1