

EXHIBIT "A"

LEGAL DESCRIPTION

ESCROW NO.: 010802557

Being a portion of the Northwest 1/4 of Section 35, Township 14 North, Range 20 East, described as follows:

Parcel B of Parcel Map for Helen Goodnight filed for record in the office of the County Recorder of Douglas County, State of Nevada, on November 12, 1980, Book 1180, Page 551, as Document No. 50549.

Assessors Parcel No. 1420-35-101-025

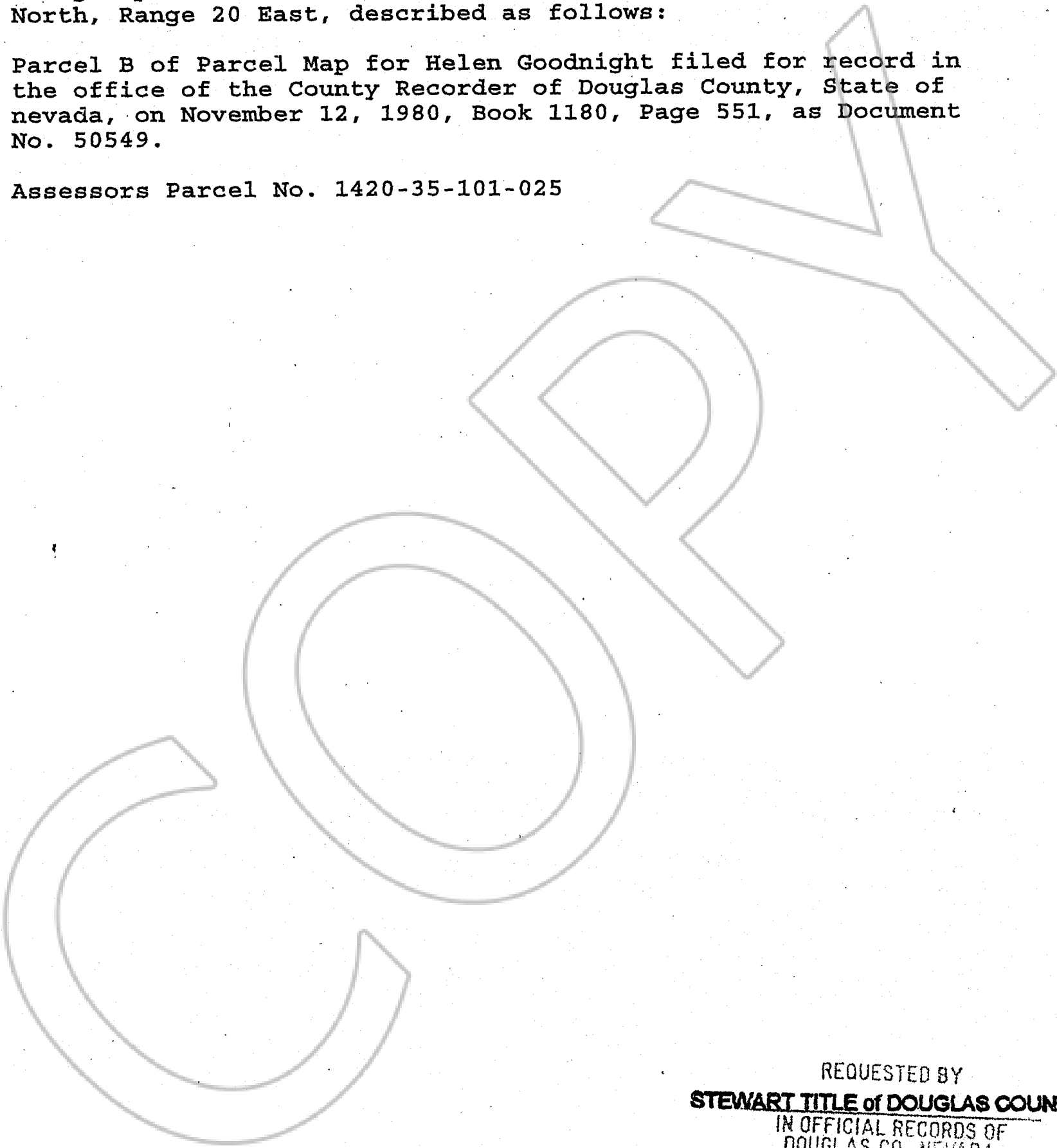

REQUESTED BY
STEWART TITLE of DOUGLAS COUNTY
IN OFFICIAL RECORDS OF
DOUGLAS CO. NEVADA

2001 NOV 30 PM 2:04

LINDA SLATER
RECORDER

\$15⁰⁰ PAID *KJ* DEPUTY

0528969
BK 1101 PG 9941