

EXHIBIT "A"

LEGAL DESCRIPTION

ESCROW NO.: 010202924

Lot 23, as shown on the map entitled KINGSBURY VILLAGE UNIT NO. 5, filed for record September 7, 1966, in the Office of the County Recorder, Douglas County, Nevada, as Document No. 33786.

Assessors Parcel No. 11-162-080

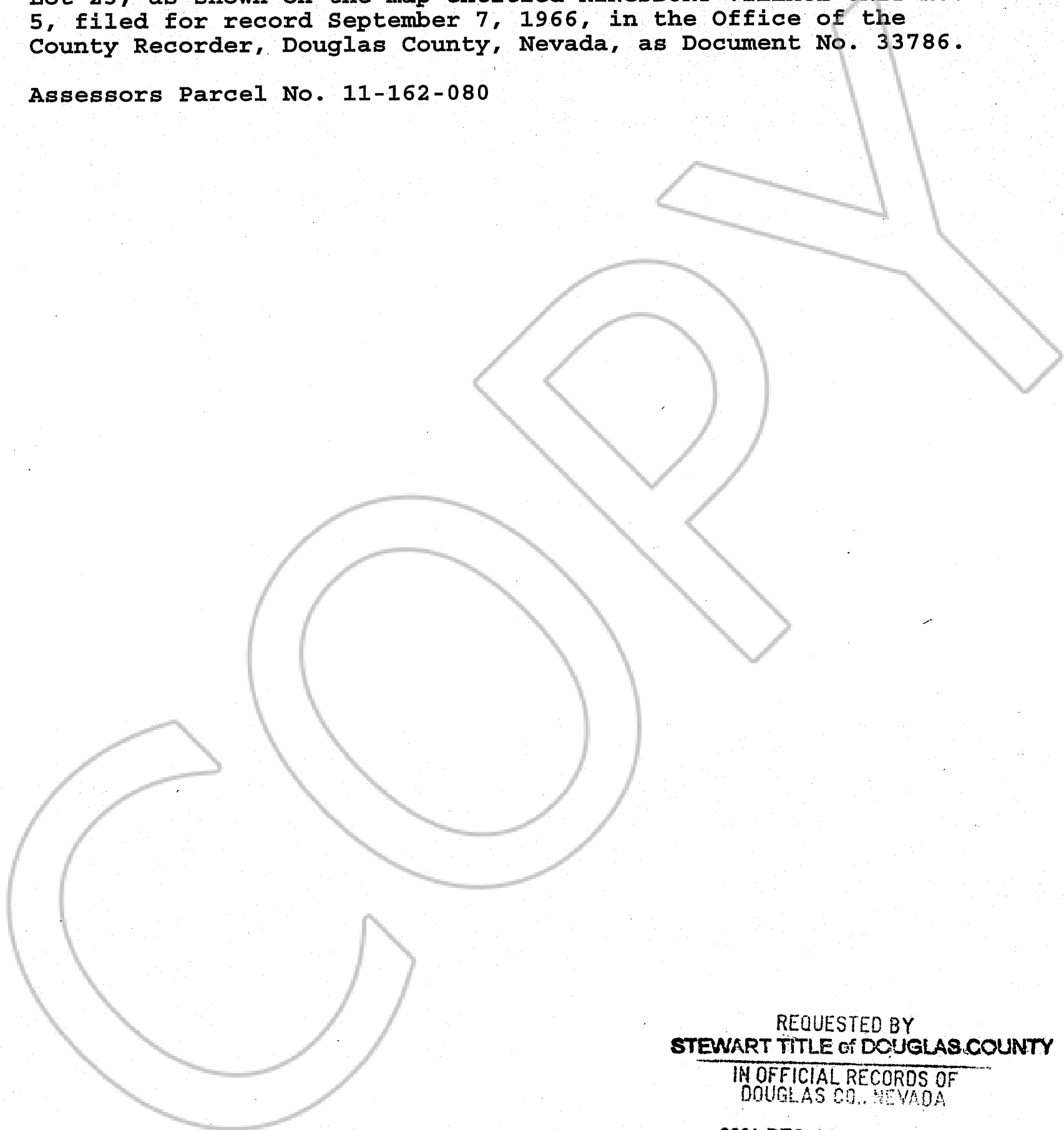

REQUESTED BY
STEWART TITLE of DOUGLAS COUNTY
IN OFFICIAL RECORDS OF
DOUGLAS CO., NEVADA

2001 DEC 17 PM 4: 27

LINDA SLATER
RECORDER

\$ 15⁰⁰ PAID K2 DEPUTY

0530308

BK 1201 PG 5631