

OWNER'S CERTIFICATE

I, THE UNDERSIGNED OWNERS OF THE AFFECTED PARCELS AS SHOWN ON THIS MAP DO HEREBY STATE:

1. WE HAVE EXAMINED THIS PLAT AND APPROVE AND AUTHORIZE ITS RECORDING;
2. WE AGREE TO EXECUTE THE REQUIRED DOCUMENTS CREATING ANY EASEMENT WHICH IS SHOWN HEREON;
3. WE AGREE TO EXECUTE THE REQUIRED DOCUMENTS ABANDONING ANY EXISTING EASEMENT PURSUANT TO THE PROVISION OF NRS 278.010, INCLUSIVE;
4. ALL PROPERTY TAXES ON THE LAND FOR THE FISCAL YEAR HAVE BEEN PAID;
5. ANY LENDER WITH AN IMPOUND ACCOUNT FOR THE PAYMENT OF TAXES HAS BEEN NOTIFIED OF THE ADJUSTMENT OF THE BOUNDARY LINE OF THE TRANSFER OF THE LAND.

DANGBERG HOLDINGS NEVADA, LLC:

Donald E Bently 12-14-2001
 BENTLY FAMILY LIMITED PARTNERSHIP, MEMBER DATE
 BY DONALD E. BENTLY, GENERAL PARTNER

Park Cattle Co by Bruce Park 12-14-01
 PARK LAND & CATTLE CO., MEMBER DATE
 BY BRUCE PARK, PRESIDENT

STATE OF Nevada)
 COUNTY OF Douglas) S.S.

ON THIS 14th DAY OF December, IN THE YEAR 2001 BEFORE ME Karen Kade /NOTARY PUBLIC, PERSONALLY APPEARED DONALD E. BENTLY, GENERAL PARTNER OF THE BENTLY FAMILY LIMITED PARTNERSHIP PERSONALLY KNOWN TO ME (OR PROVED TO ME ON THE BASIS OF SATISFACTORY EVIDENCE) TO BE THE PERSON WHOSE NAME IS SUBSCRIBED TO THIS INSTRUMENT, AND ACKNOWLEDGE THAT HE EXECUTED IT.

WITNESS MY HAND AND OFFICIAL SEAL.



Karen Kade
 NOTARY PUBLIC
 MY COMMISSION EXPIRES: January 10, 2005

STATE OF Nevada)
 COUNTY OF Douglas) S.S.

ON THIS 14th DAY OF December, IN THE YEAR 2001 BEFORE ME Ruth Ann Brandenburg /NOTARY PUBLIC, PERSONALLY APPEARED BRUCE PARK, PRESIDENT OF PARK LAND & CATTLE CO., PERSONALLY KNOWN TO ME (OR PROVED TO ME ON THE BASIS OF SATISFACTORY EVIDENCE) TO BE THE PERSON WHOSE NAME IS SUBSCRIBED TO THIS INSTRUMENT, AND ACKNOWLEDGE THAT HE EXECUTED IT.

WITNESS MY HAND AND OFFICIAL SEAL.



Ruth Ann Brandenburg
 NOTARY PUBLIC
 MY COMMISSION EXPIRES: 5-8-2005

SURVEYOR'S CERTIFICATE

I, DARRYL M. HARRIS, A PROFESSIONAL LAND SURVEY IN THE STATE OF NEVADA, DO HEREBY STATE:

1. I HAVE PERFORMED A FIELD STUDY SUFFICIENT TO LOCATE AND IDENTIFY PROPERLY THE PROPOSED BOUNDARY LINE ADJUSTMENT;
2. ALL CORNERS AND ANGLE POINTS OF THE ADJUSTED BOUNDARY HAVE BEEN DEFINED BY MONUMENTS OR WILL BE OTHERWISE DEFINED ON A DOCUMENT OF RECORD AS REQUIRED BY NRS 625.340; AND
3. THIS MAP IS NOT IN CONFLICT WITH: THE PROVISION OF NRS 278.010 TO 278.630, INCLUSIVE; PROVISIONS OF NRS 625; AND ALL LOCAL ORDINANCES.
4. THIS IS A TRUE AND ACCURATE REPRESENTATION OF THE LANDS SURVEYED UNDER MY SUPERVISION AT THE INSTANCE OF DANGBERG HOLDINGS NEVADA, LLC.
5. THE LANDS SURVEYED LIE WITHIN THE EAST 1/2 AND THE E 1/2 SW 1/4 OF SECTION 20, T.13 N., R.20 E., M.D.M. AND THE SURVEY WAS COMPLETED ON NOVEMBER 30, 2001.

Darryl M. Harris
 DARRYL M. HARRIS, PROFESSIONAL LAND SURVEYOR NO. 6497
 12-12-01

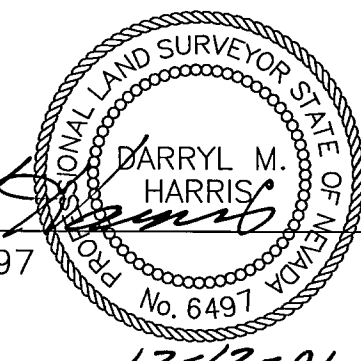

CLERK TREASURER'S CERTIFICATE

ALL PROPERTY TAXES FOR THE PARCELS SHOWN ON THIS MAP HAVE BEEN PAID IN FULL FOR THE FISCAL TAX YEAR.

AFFECTED APN'S: 1320-20-000-006, 1320-20-000-005, 1320-20-000-004, 1320-20-000-003, 1320-20-000-002

Barbara J. Reed 12/17/01
 DOUGLAS CO. TREASURER DATE
 BARBARA J. REED
 By: Serry J. Undergrun, Chief Deputy Treasurer
 COMMUNITY DEVELOPMENT DEPARTMENT CERTIFICATE

IT IS HEREBY CERTIFIED THAT THIS BOUNDARY LINE ADJUSTMENT WAS PRESENTED TO THE DOUGLAS COUNTY COMMUNITY DEVELOPMENT DEPARTMENT AND WAS DULY APPROVED.

Tammy J. Vogl 12-21-01
 DOUGLAS CO. COMMUNITY DEVELOPMENT DIRECTOR DATE
~~888-NUNEZ~~ TAMMY J. VOGL

RECORDER'S CERTIFICATE

FILED THIS 18th DAY OF January, 2002, AT 21 MINUTES PAST 4 O'CLOCK P.M., IN BOOK 0102, AT PAGE 5649, DOCUMENT NUMBER 532717, RECORDED AT THE REQUEST OF DANGBERG HOLDINGS NEVADA, LLC.

Camila Kronenberg, Deputy
 DOUGLAS COUNTY RECORDER
 LINDA SLATER

RECORD OF SURVEY #1
 TO SUPPORT A LOT LINE ADJUSTMENT
 FOR
Dangberg Holdings Nevada, LLC
 LOCATED WITHIN THE E 1/2 & E 1/2 SW 1/4
 OF SEC. 20, T.13 N., R.20 E., M.D.M.
 DOUGLAS COUNTY, NEVADA

| | |
|---------------------|-----------|
| DATE | |
| REVISION | |
| JOB NO. | 98-015-01 |
| DATE | 11/12/01 |
| DRAWN | MLM |
| CHECKED | ALB |
| SHEET 1 OF 2 | |

ENGINEERING • PLANNING • RESOURCE MANAGEMENT
RESOURCE CONCEPTS, INC.
 340 N. MINNESOTA STREET • CARSON CITY, NEVADA 89703-4152 • OFFICE: 702-883-1600 • FAX: 702-883-1656 • WEB SITE: WWW.RCMV.COM

20-13-20
 Doc# 532717 DANGBERG

