

Recording requested by, and
mail tax statements to, and
when recorded, mail to:

✓ Brooke • Shaw • Plimpton • Zumpft
Post Office Box 2860
Minden, NV 89423

APNs 1320-28-000-002 and 1320-28-000-003

**GRANT DEED
(LOT LINE ADJUSTMENT)**

R.P.T.T. \$ #3

THIS DEED is made this 18th day of January, 2002, by and between Dangberg Holdings Nevada, LLC, a Nevada limited liability company (hereinafter referred to as "Grantor"), and Dangberg Holdings Nevada, LLC, a Nevada limited liability company (hereinafter referred to as "Grantee").

WITNESSETH:

Grantor is the owner of the real property located in Douglas County, Nevada, described on Exhibit A attached hereto and incorporated herein by this reference.

Grantor desires to adjust the boundaries and lot lines of portions of said contiguous described real property by removing and adding portions of property as set forth herein.

Exhibit A contains the legal description of the portion of each affected parcel which will be adjusted by this Deed.

NOW THEREFORE, Grantor, for good and valuable consideration, the receipt of which is hereby acknowledged, and for purposes of creating a lot line adjustment between contiguous parcels owned by Grantor and Grantee, does by these presents, grant, bargain, sell, convey, transfer, and

0532720

BK0102PG5669

deliver to Grantee, and its heirs, successors and assigns, all of Grantor's right, title and interest in and to the following described property situate in Douglas County, Nevada, more particularly described in Exhibit B attached hereto and incorporated herein by this reference.

Exhibit B contains the legal description of the resulting parcels following adjustment by this Deed.

TOGETHER WITH the tenements, hereditaments and appurtenances thereunto belonging or appertaining, including all water rights or water stock of any kind, and the reversion and reversions, remainder and remainders, rents, issues and profits thereof.

TO HAVE AND TO HOLD the said premises, together with the appurtenances, unto the said Grantee, and to its heirs, successors and assigns forever.

By this Deed, Grantor intends to and does reconfigure its property as described herein, and also as set forth on the map entitled Record of Survey #2 To Support a Lot Line Adjustment for Dangberg Holdings Nevada, LLC recorded contemporaneously herewith.

IN WITNESS WHEREOF, the parties have executed this Grant Deed (Lot Line Adjustment) this 18th day of January, 2002.

DANGBERG HOLDINGS NEVADA, LLC,
a Nevada limited liability company

MEMBER:

PARK CATTLE CO., a Nevada corporation

By: Bruce Park

Bruce Park, President

MEMBER:

BENTLY FAMILY LIMITED PARTNERSHIP, a Nevada
limited partnership

By:

Donald E Bently

Donald E. Bently, General Partner

COOPER

F:\Util\TSB\BNC-BFLP\DH\Boundary Line Adjustment Deed - #2.doc

STATE OF NEVADA)

:SS.

COUNTY OF DOUGLAS)

On the 18th day of January, 2002, before me personally appeared Bruce Park, as President of Park Cattle Co., known to me to be the person whose name is subscribed to the within instrument and who acknowledged that he executed the same freely and voluntarily and for the uses and purposes therein contained.

IN WITNESS WHEREOF, I have hereunto set my hand and affixed my official seal the day and year first above written.

Ruth Ann Brandenburg
NOTARY PUBLIC

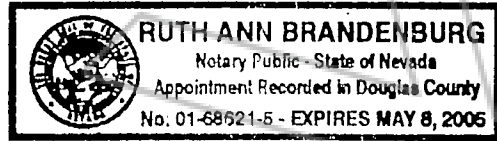

STATE OF NEVADA)

:SS.

COUNTY OF DOUGLAS)

On the 18th day of January, 2002, before me personally appeared Donald E. Bently, as General Partner of Bently Family Limited Partnership, known to me to be the person whose name is subscribed to the within instrument and who acknowledged that he executed the same freely and voluntarily and for the uses and purposes therein contained.

IN WITNESS WHEREOF, I have hereunto set my hand and affixed my official seal the day and year first above written.

Karen Kade
NOTARY PUBLIC



EXHIBIT A

COPY

0532720
BKO102PG5673

DANGBERG HOLDINGS NEVADA, LLC
ADJUSTED PORTION PARCEL 24
LOT LINE ADJUSTMENT
LEGAL DESCRIPTION

December 7, 2001

A parcel of land located within a portion of the South one-half of Section 21, Township 13 North, Range 20 East, MDM, Douglas County, Nevada, being more particularly described as follows:

BEGINNING at the South one-quarter corner of said Section 21 as calculated from the Record of Survey for John B. Anderson and Edith Anderson, Document No. 79278 of the Douglas County Recorder's Office, said point bears S. 45°21'46" W., 3737.48 feet from the East one-quarter corner of Section 21, Township 13 North, Range 20 East, MDM, being a brass disk set in concrete stamped RLS 3579;

thence N. 89°30'15" W., along the South line of said Section 21, 84.59 feet;

thence N. 00°14'20" E., 2646.43 feet to a point on the South line of the North one-half of said Section 21;

thence S. 89°33'26" E., along said South line of the North one-half, 83.07 feet to the Northeast corner of the Southwest one-quarter of said Section 21;

thence S. 00°12'22" W., along the East line of said Southwest one-quarter, 2646.51 feet to the POINT OF BEGINNING.

Containing 5.093 acres more or less.

Basis of Bearing

The South line of the North one-half of Section 22, Township 13 North, Range 20 East, MDM, as shown on the Record of Survey for John B. Anderson and Edith Anderson, Document No. 79279 of the Douglas County Recorder's Office, (S. 89°21'36" E.).

PREPARED BY:

Darryl M. Harris, P.L.S. #6497
Resource Concepts, Inc.
212 Elks Point Road, Suite 441
P.O. Box 11796
Zephyr Cove, NV 89448

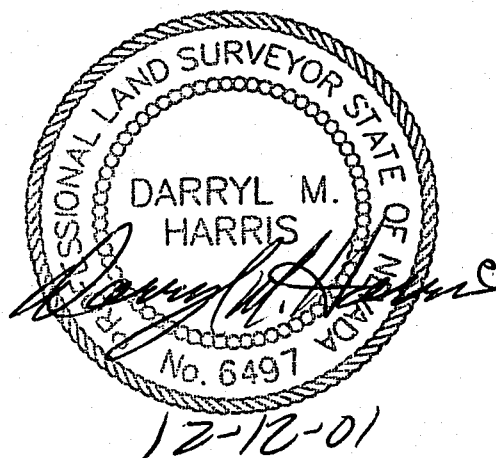

0532720

BK0102PG5674

DANGBERG HOLDINGS NEVADA, LLC
ADJUSTED PORTION PARCEL 35
LOT LINE ADJUSTMENT
LEGAL DESCRIPTION

December 7, 2001

A parcel of land located within a portion of the West one-half of the Northeast one-quarter of Section 28, Township 13 North, Range 20 East, MDM, Douglas County, Nevada, being more particularly described as follows:

BEGINNING at the Northeast corner of the West one-half of the Northeast one-quarter of Section 28 as calculated from the Record of Survey for John B. Anderson and Edith Anderson, Document No. 79278 of the Douglas County Recorder's Office, said point bears S. 26°50'12" W., 2955.83 feet from the East one-quarter corner of Section 21, Township 13 North, Range 20 East, MDM, being a brass disk set in concrete stamped RLS 3579;

thence S. 00°41'06" W., along the East line of said West one-half, 948.89 feet;

thence N. 89°30'58" W., 58.80 feet;

thence N. 00°29'02" E., 948.90 feet to a point on the North line of said West one-half;

thence S. 89°30'15" E., along said North line, 62.13 feet to the POINT OF BEGINNING.

Containing 57,375 square feet more or less.

Basis of Bearing

The South line of the North one-half of Section 22, Township 13 North, Range 20 East, MDM, as shown on the Record of Survey for John B. Anderson and Edith Anderson, Document No. 79279 of the Douglas County Recorder's Office, (S. 89°21'36" E.).

PREPARED BY:

Darryl M. Harris, P.L.S. #6497
Resource Concepts, Inc.
212 Elks Point Road, Suite 441
P.O. Box 11796
Zephyr Cove, NV 89448

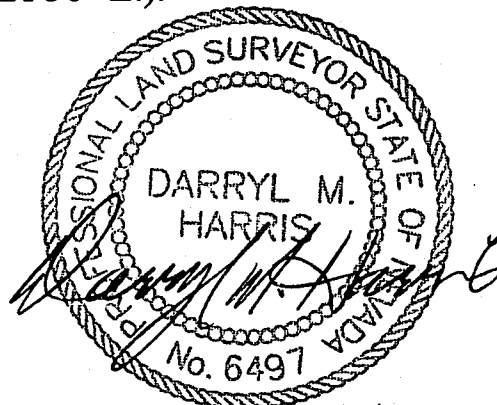

12-12-01

0532720

BK0102PG5675

DANGBERG HOLDINGS NEVADA, LLC
ADJUSTED PORTION PARCEL 36
LOT LINE ADJUSTMENT
LEGAL DESCRIPTION

January 18, 2002

A parcel of land located within a portion of the East one-half of the Northeast one-quarter of Section 28, Township 13 North, Range 20 East, MDM, Douglas County, Nevada, being more particularly described as follows:

BEGINNING at the Southwest corner of the East one-half of the Northeast one-quarter of said Section 28 as calculated from the Record of Survey for John B. Anderson and Edith Anderson, Document No. 79278 of the Douglas County Recorder's Office, said point bears S. 14°29'33" W., 5458.65 feet from the East one-quarter corner of Section 21, Township 13 North, Range 20 East, MDM, being a brass disk set in concrete stamped RLS 3579;
thence N. 00°41'06" E., along the West line of said East one-half, 216.34 feet;
thence S. 42°45'04" E., 261.84 feet to a point on the South line of Lot 36 as shown on the Record of Survey to Support a Lot Line Adjustment for Bently Nevada Corporation, Document No. 172069 of the Douglas County Recorder's Office;
thence N. 89°29'43" W., along said South line, 147.72 feet;
thence S. 43°15'42" E., continuing along said South line, 35.56 feet to a point on the South line of said East one-half;
thence N. 89°27'12" W., continuing along said South line, 56.98 feet to the POINT OF BEGINNING.

Containing 18310 square feet more or less.

Basis of Bearing

The South line of the North one-half of Section 22, Township 13 North, Range 20 East, M.D.M., as shown on the Record of Survey for John B. Anderson and Edith Anderson Document No. 79279 of the Douglas County Recorder's Office, (S. 89°21'36" E.).

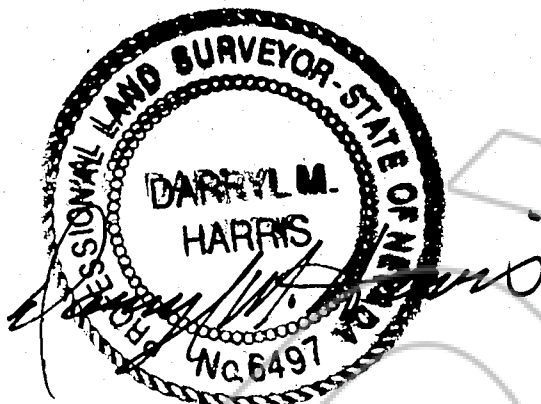

1-18-02

PREPARED BY:

Darryl M. Harris, P.L.S. #6497
Resource Concepts, Inc.
212 Elks Point Road, Suite 441
P.O. Box 11796
Zephyr Cove, NV 89448

EXHIBIT B

COPY

0532720
BK0102PG5678

DANGBERG HOLDINGS NEVADA, LLC
NEW PARCEL 24
LOT LINE ADJUSTMENT
LEGAL DESCRIPTION

December 7, 2001

A parcel of land located within a portion of the Southwest one-quarter of Section 21, Township 13 North, Range 20 East, MDM, Douglas County, Nevada, being more particularly described as follows:

BEGINNING at a point on the South line of said Section 21 as shown on the Record of Survey for John B. Anderson and Edith Anderson, Document No. 79278 of the Douglas County Recorder's Office, said point bears S. 45°16'02" W., 3797.63 feet from the East one-quarter corner of Section 21, Township 13 North, Range 20 East, MDM, being a brass disk set in concrete stamped RLS 3579;

thence N. 89°30'15" W., along the South line of said Section 21, 1240.53 feet to the Southwest corner of the East one-half of the Southwest one-quarter thereof;

thence N. 00°12'29" E., along the West line of said East one-half, 2645.28 feet to the Northwest corner thereof;

thence S. 89°33'26" E., along the North line of said East one-half, 1241.95 feet;

thence S. 00°14'20" W., 2646.43 feet to the POINT OF BEGINNING.

Containing 75.393 acres feet more or less.

Basis of Bearing

The South line of the North one-half of Section 22, Township 13 North, Range 20 East, MDM, as shown on the Record of Survey for John B. Anderson and Edith Anderson, Document No. 79279 of the Douglas County Recorder's Office, (S. 89°21'36" E.).

PREPARED BY:

Darryl M. Harris, P.L.S. #6497
Resource Concepts, Inc.
212 Elks Point Road, Suite 441
P.O. Box 11796
Zephyr Cove, NV 89448

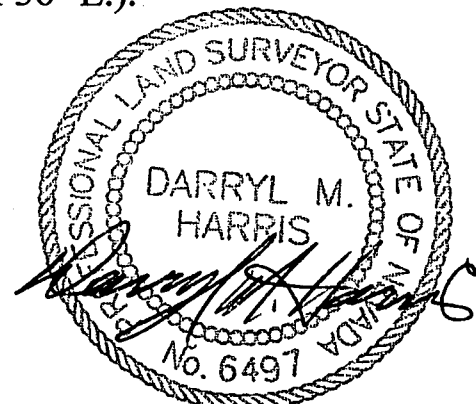

12-12-01

DANGBERG HOLDINGS NEVADA, LLC
NEW PARCEL 25
LOT LINE ADJUSTMENT
LEGAL DESCRIPTION

December 7, 2001

A parcel of land located within a portion of the South one-half of Section 21, Township 13 North, Range 20 East, MDM, Douglas County, Nevada, being more particularly described as follows:

BEGINNING at the South one-quarter corner of Section 21 as calculated from the Record of Survey for John B. Anderson and Edith Anderson, Document No. 79278 of the Douglas County Recorder's Office, said point bears S. 45°21'46" W., 3737.48 feet from the East one-quarter corner of Section 21, Township 13 North, Range 20 East, MDM, being a brass disk set in concrete stamped RLS 3579;

thence N. 89°30'15" W., along the South line of said Section 21, 84.59 feet;

thence N. 00°14'20" E., 2646.43 feet to a point on the South line of the North one-half of said Section 21;

thence S. 89°33'26" E., along said South line of the North one-half, 1408.09 feet to the Northeast corner of the West one-half of the Southeast one-quarter of said Section 21;

thence S. 00°12'14" W., along said the East line of Parcel 25 as shown on the Land Division Map for John B. Anderson, Document No. 25700 of the Douglas County Recorder's Office, 2647.74 feet to the Southeast corner thereof;

thence N. 89°30'15" W., along the South line of said West one-half, 1325.12 feet to the POINT OF BEGINNING.

Containing 85.616 acres more or less.

Basis of Bearing

The South line of the North one-half of Section 22, Township 13 North, Range 20 East, MDM, as shown on the Record of Survey for John B. Anderson and Edith Anderson, Document No. 79279 of the Douglas County Recorder's Office, (S. 89°21'36" E.).

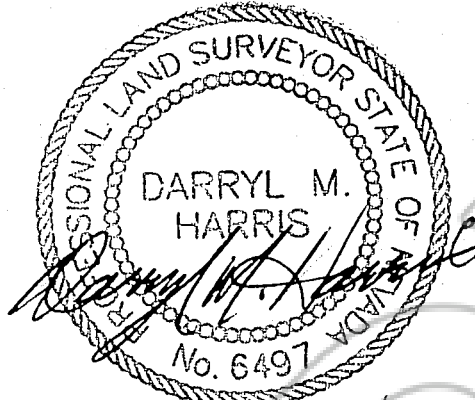

PREPARED BY:

Darryl M. Harris, P.L.S. #6497
Resource Concepts, Inc.
212 Elks Point Road, Suite 441
P.O. Box 11796
Zephyr Cove, NV 89448

DANGBERG HOLDINGS NEVADA, LLC
NEW PARCEL 35
LOT LINE ADJUSTMENT
LEGAL DESCRIPTION

December 7, 2001

A parcel of land located within a portion of the Northeast one-quarter of Section 28, Township 13 North, Range 20 East, MDM, Douglas County, Nevada, being more particularly described as follows:

BEGINNING at the North one-quarter corner of said Section 28 as shown on the Record of Survey for John B. Anderson and Edith Anderson, Document No. 79279 of the Douglas County Recorder's Office, said point bears S. 45°21'46" W., 3737.48 feet from the East one-quarter corner of Section 21, Township 13 North, Range 20 East, MDM, being a brass disk set in concrete stamped RLS 3579;

thence S. 89°30'15" E., along the North line of said Section 28, 1262.99 feet;

thence S. 00°29'02" W., 948.90 feet;

thence S. 89°30'58" E., 58.80 feet to a point on the East line of the West one-half of the Northeast one-quarter of said Section 28;

thence S. 00°41'06" W., along said East line, 1482.43 feet;

thence S. 42°45'04" E., 261.84 feet to a point on the South line of Lot 36 as shown the Record Of Survey to Support a Lot Line Adjustment for Bently Nevada Corporation, Document No. 172069 of the Douglas County Recorder's Office;

thence N. 89°29'43" W., along said South line, 147.72 feet;

thence S. 43°15'42" E., continuing along said South line, 35.56 feet to a point on the South line of said Northeast one-quarter;

thence N. 89°27'12" W., along the South line of said Northeast one-quarter, 1378.90 feet to the Southwest corner thereof;

thence N. 00°36'56" E., along the West line of said Northeast one-quarter, 2646.48 feet to the POINT OF BEGINNING.

Containing 79.531 acres more or less.

Basis of Bearing

The South line of the North one-half of Section 22, Township 13 North, Range 20 East, MDM, as shown on the Record of Survey for John B. Anderson and Edith Anderson, Document No. 79279 of the Douglas County Recorder's Office, (S. 89°21'36" E.).

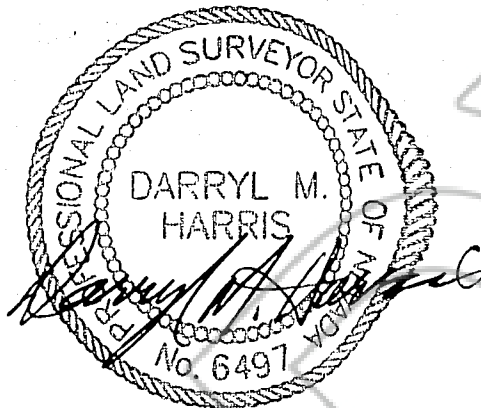

12-12-01

PREPARED BY:

Darryl M. Harris, P.L.S. #6497
Resource Concepts, Inc.
212 Elks Point Road, Suite 441
P.O. Box 11796
Zephyr Cove, NV 89448

DANGBERG HOLDINGS NEVADA, LLC
NEW PARCEL 36
LOT LINE ADJUSTMENT
LEGAL DESCRIPTION

December 7, 2001

A parcel of land located within a portion of the Northeast one-quarter of Section 28, Township 13 North, Range 20 East, MDM, Douglas County, Nevada, being more particularly described as follows:

BEGINNING at the Northeast corner of said Section 28 as shown on the Record of Survey to Support a Lot Line Adjustment for Bently Nevada Corporation, Document No. 172069 of the Douglas County Recorder's Office, said point bears S. $00^{\circ}12'07''$ W., 2648.96 feet from the East one-quarter corner of Section 21, Township 13 North, Range 20 East, MDM, being a brass disk set in concrete stamped RLS 3579;

thence S. $00^{\circ}45'15''$ W., along the East line of said Section 28, 1007.91 feet to a point on the East line of Lot 36 as shown on said Record of Survey;

thence N. $89^{\circ}51'40''$ W., along said East line of Lot 36, 62.09 feet;

thence S. $00^{\circ}22'39''$ W., continuing along said East line of Lot 36, 1613.92 feet to the Southeast corner thereof;

thence N. $89^{\circ}29'43''$ W., along the South line of said Lot 36, 1090.45 feet;

thence N. $42^{\circ}45'04''$ W., 261.84 feet to a point on the West line of the East one-half of the Northeast one-quarter of said Section 28;

thence N. $00^{\circ}41'06''$ E., along said West line, 1482.43 feet;

thence N. $89^{\circ}30'58''$ W., 58.80 feet;

thence N. $00^{\circ}29'02''$ E., 948.90 feet to a point on the North line of said Section 28;

thence S. $89^{\circ}30'15''$ E., along said North line, 1387.25 feet to the POINT OF

BEGINNING.

Containing 78.490 acres more or less.

Basis of Bearing

The South line of the North one-half of Section 22, Township 13 North, Range 20 East, MDM, as shown on the Record of Survey for John B. Anderson and Edith Anderson, Document No. 79279 of the Douglas County Recorder's Office, (S. 89°21'36" E.).

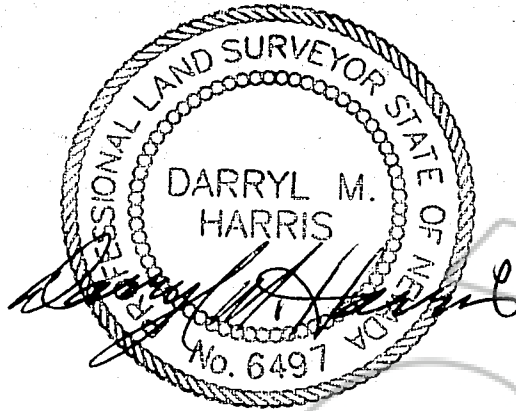

PREPARED BY:

Darryl M. Harris, P.L.S. #6497
Resource Concepts, Inc.
212 Elks Point Road, Suite 441
P.O. Box 11796
Zephyr Cove, NV 89448

REQUESTED BY
Brooke + Shaw
IN OFFICIAL RECORDS OF
DOUGLAS CO. NEVADA

2002 JAN 18 PM 4: 28

LINDA SLATER
RECORDER

0532720

\$30⁰⁰ PAID *Rg* DEPUTY

BK0102PG5685